

**CONTENTS****INHOUD**

<i>No.</i>	<i>Page No.</i>	<i>Gazette No.</i>	<i>No.</i>	<i>Bladsy No.</i>	<i>Koerant No.</i>
<b>GOVERNMENT NOTICE</b>			<b>GOEWERMENSKENNISGEWING</b>		
<b>Transport, Department of</b>			<b>Vervoer, Departement van</b>		
<i>Government Notice</i>			<i>Goewermentskennisgewing</i>		
802			802		
South African National Roads Agency Limited and the National Roads Act (7/1998): The South African National Roads Agency Limited: Declaration amendment of National Road R36 Section 8: Amendment of Declaration No. 1229 of 2004 .....			Suid-Afrikaanse Nasionale Padagentskap Beperk en die Nasionale Paale Wet (7/1998): Die Suid-Afrikaanse Nasionale Padagentskap Beperk: Verklaring wysiging van Nasionale Pad R36 Seksie 8: Wysiging van Verklaring No. 1229 van 2004 .....		
	3	31275		4	31275

**GOVERNMENT NOTICE**  
**GOEWERWENNTSKENNISGEWING**

**DEPARTMENT OF TRANSPORT**  
**DEPARTEMENT VAN VERVOER**

No. 802

28 July 2008

**THE SOUTH AFRICAN NATIONAL ROADS**  
**AGENCY LIMITED**

Registration No: 98/09584/06

Registration No: 98/09584/06

**DECLARATION AMENDMENT OF NATIONAL ROAD R36 SECTION 8**

**DECLARATION AMENDMENT OF NATIONAL ROAD R36 SECTION 8**

**AMENDMENT OF DECLARATION No. 1229 OF 2004**

By virtue of section 40 (1)(b) of the South African National Roads Agency Limited and the National Roads Act, 1998 (Act No. 7 of 1998), I hereby amend Declaration No. 1229 of 2004 by substituting the section of the descriptive declaration from Duiwelskloof up to Soekmekaar in paragraphs (II) and (III) of the Annexure, with the subjoined sheets 1 to 15 of Plan No. P35808.

**(National Road R36 Section 8: Duiwelskloof - Soekmekaar)**



**MINISTER OF TRANSPORT**

No. 802

28 Julie 2008

**DIE SUID-AFRIKAANSE NASIONALE  
PADAGENTSKAP BEPERK**

Registrasie No: 98/09584/06

**VERKLARING WYSIGING VAN NASIONALE PAD R36 SEKSIE 8.**

WYSIGING VAN VERKLARING NO. 1229 VAN 2004.

Kragtens Artikel 40(1)(b) van die Suid-Afrikaanse Nasionale Padagentskap Beperk en die Nasionale Paaie Wet, 1998 (Wet No.7 van 1998), wysig ek hiermee Verklaring no. 1229 van 2004 deur die gedeelte van die beskrywende verklaring vanaf Duiwelskloof tot by Soekmekaar in paragrafe (II) en (III) van die bylae, te vervang met meegaande velle 1 tot 15 van Plan No. P055/08.

**(Nasionale Pad R36 Seksie 8: Duiwelskloof - Soekmekaar)****MINISTER VAN VERVOER**

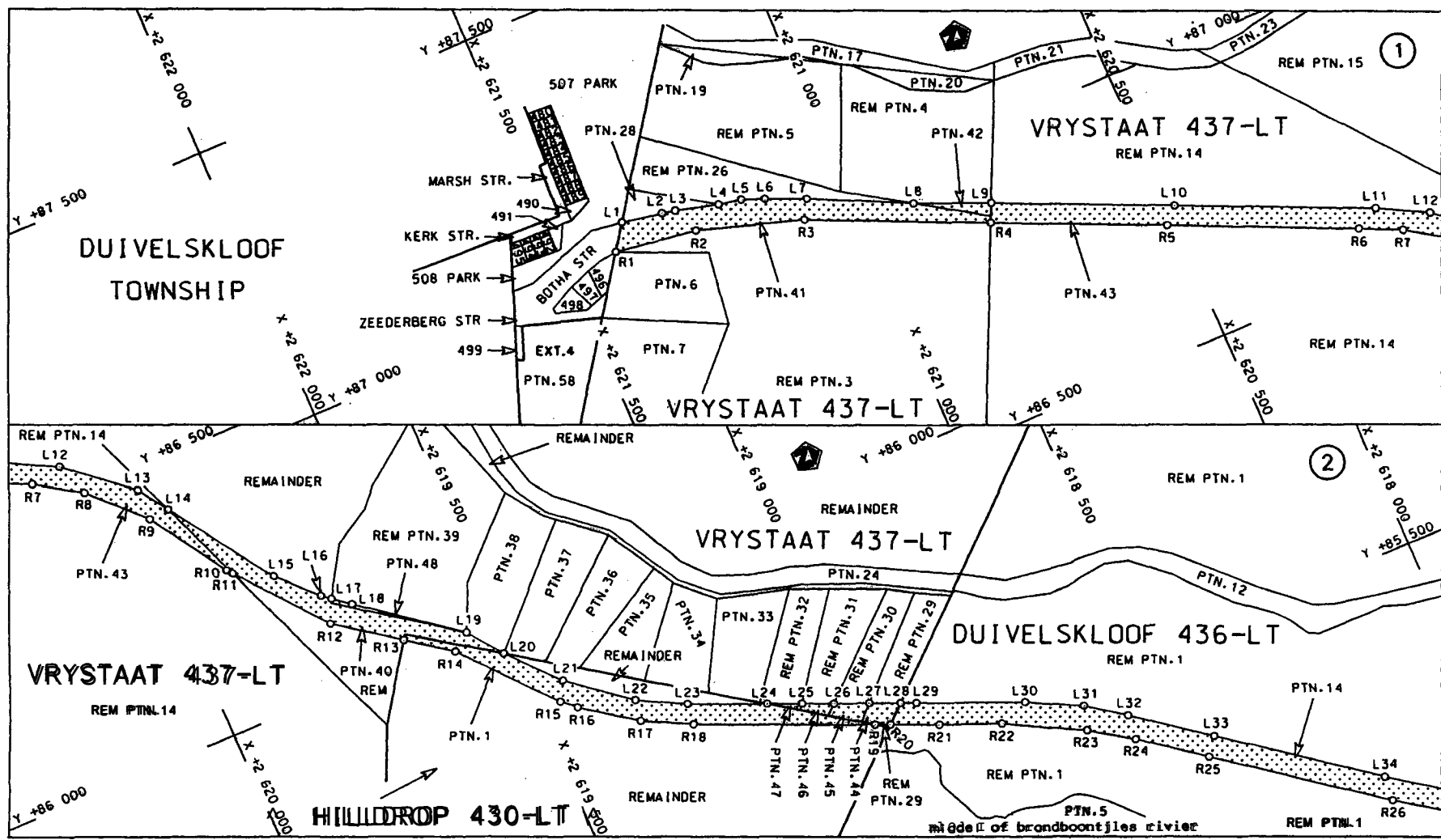

<p>Die Suid Afrikaanse Nasionale Padagentskop Beperk The South African National Roads Agency Limited</p>	<p>Die figuur getoon The figure shown</p>		<p>steldie podreserwe voor van 'n gedeelte represents the rood reserve of a portion van Nasionale Roete R36 Sektie 8 of National Route R36 Section 8</p>	<p>Vel Sheet 1 of 15</p>
			<p>Plan No. P658/08</p>	

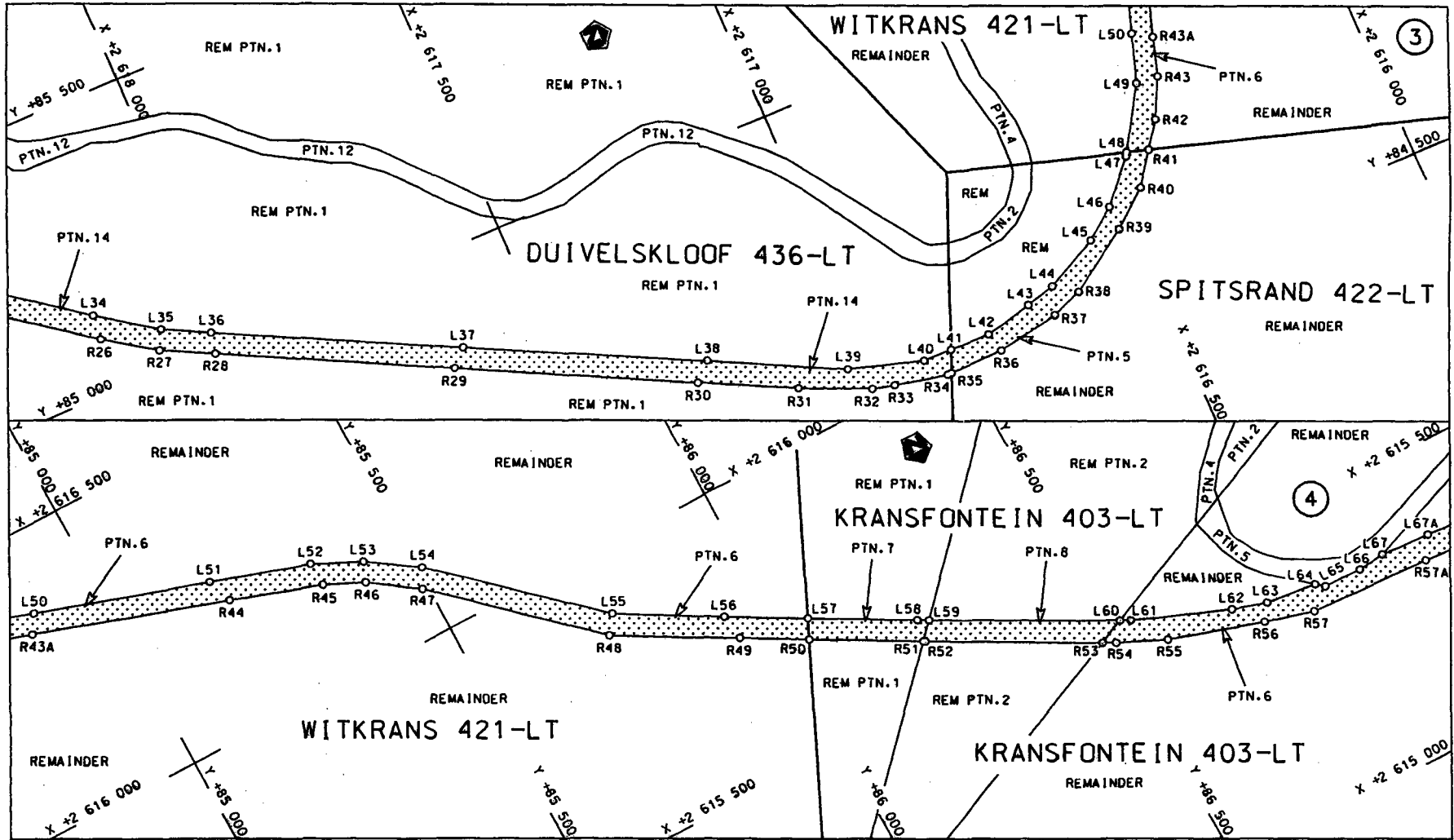

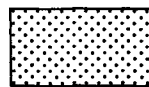
<p>Die Suid Afrikaanse Nasionale Padogentskap Beperk The South African National Roads Agency Limited</p>	<p>Die figuur getoon The figure shown</p> 	<p>steldie podreserwe voor van 'n gedeelte represents the road reserve of a portion van Nasionale Roete R38 Seksie 8 of National Route Section</p>	<p>Vel Sheet 2 van 15 Plan IP658/08</p>
--	--	--	---

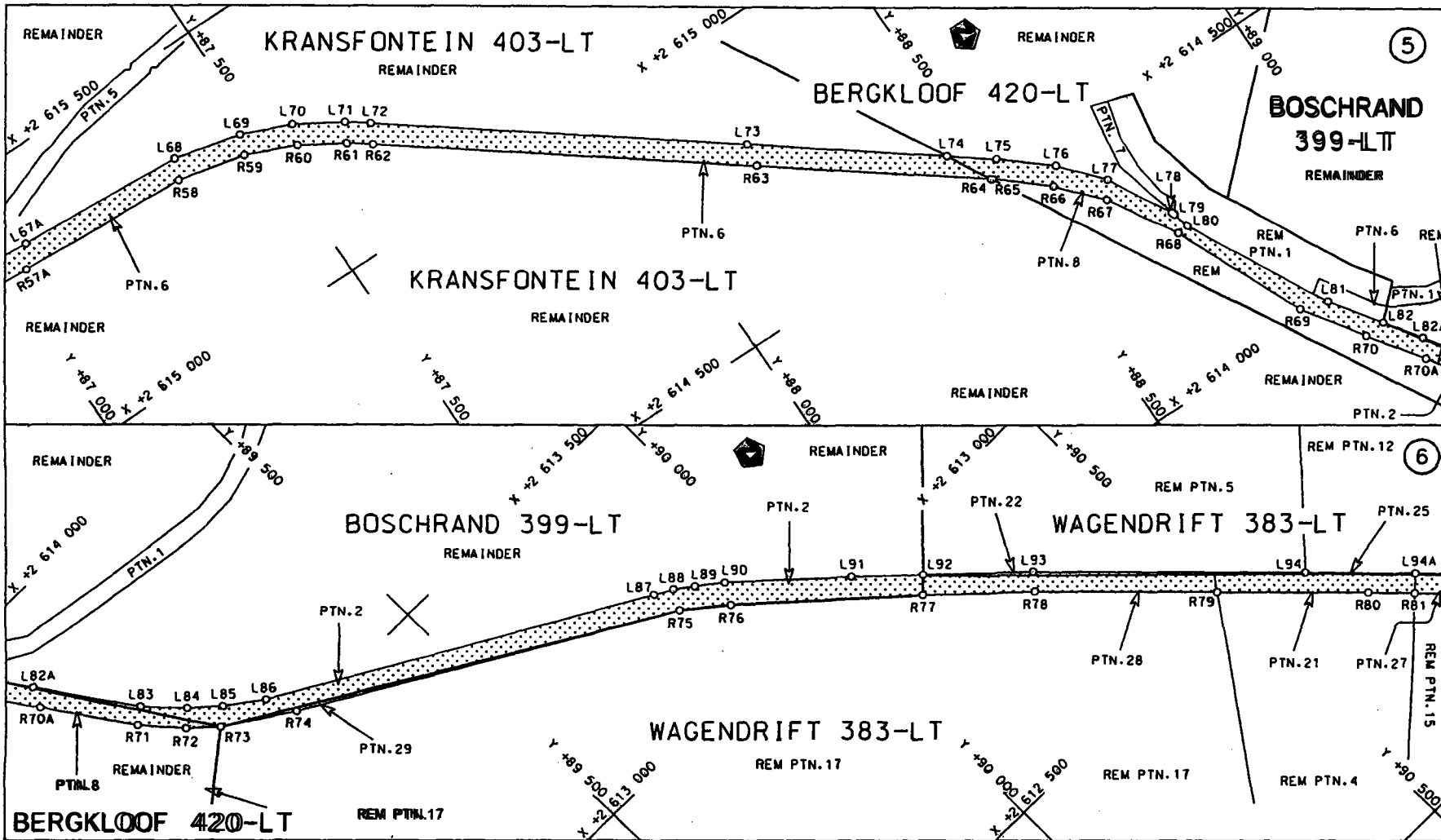

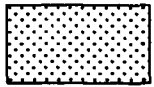
<p>Die Suid Afrikaanse Nasionale Padagentskap Beperk The South African National Roads Agency Limited</p>	<p>Die figuur getoon The figure shown</p> 	<p>steldie podreserwe voor van 'n gedeelte represents the road reserve of a portion von Nasionale Roete R36 of National Route R36</p> <p>Seksie Section 8</p>	<p>Vol Sheet 3 of 15 Plan P658/08</p>
--	---	---	---

STAATSKOERANT, 28 JULIE 2008

No. 81 275 7

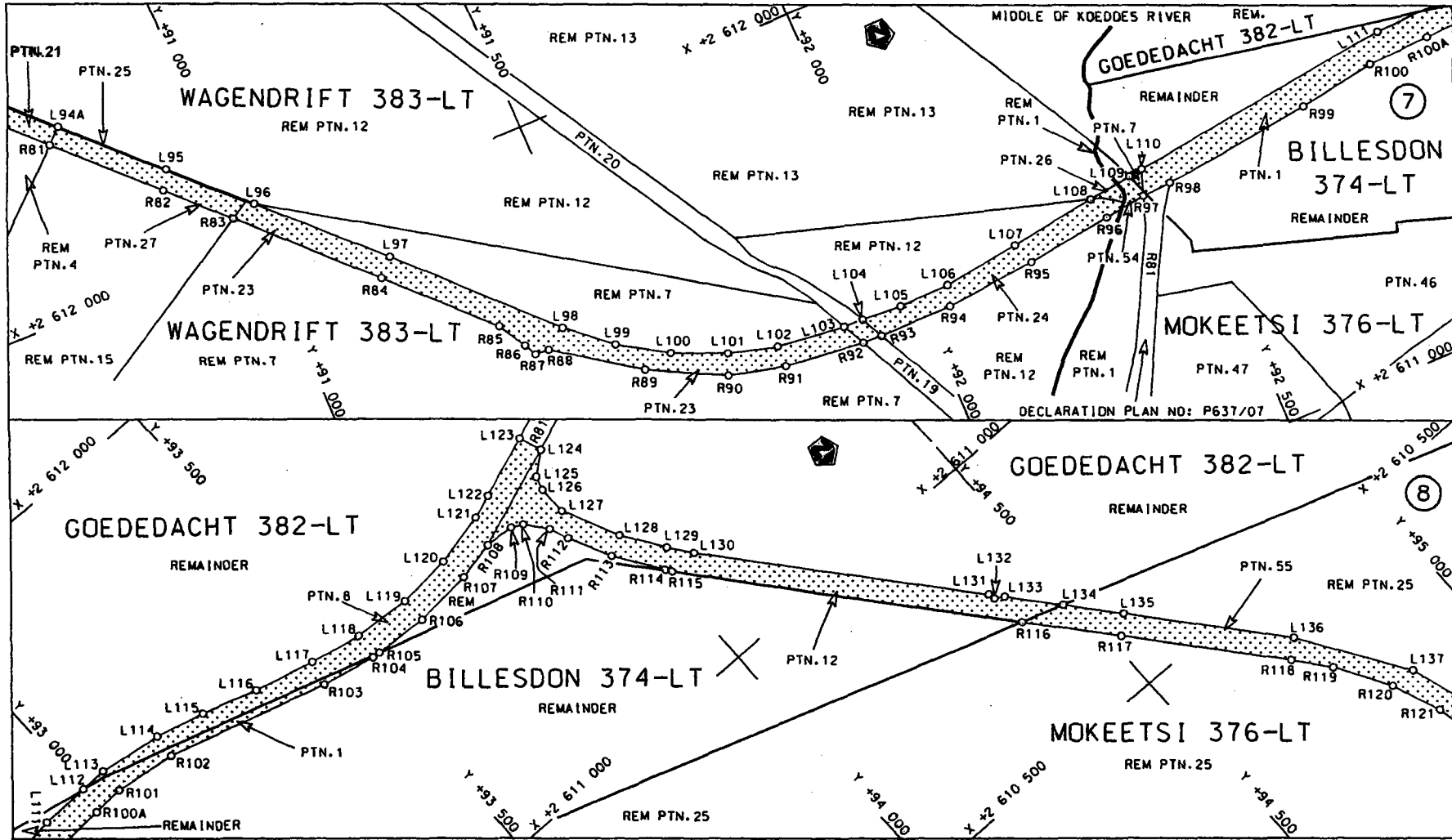

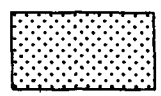
<p>Die Suid Afrikaanse Nasionale Padagentskap Beperk The South African National Roads Agency Limited</p>	<p>Die figuur getoon The figure shown</p>		<p>stelt die padreserwe voor van 'n gedeelte represents the road reserve of a portion van Nasionale Roete of National Route</p> <p>R38</p>	<p>8</p>	<p>Vol Sheet 4 van of 15</p> <p>RAP P658/08</p>
--	---	--	--	----------	---

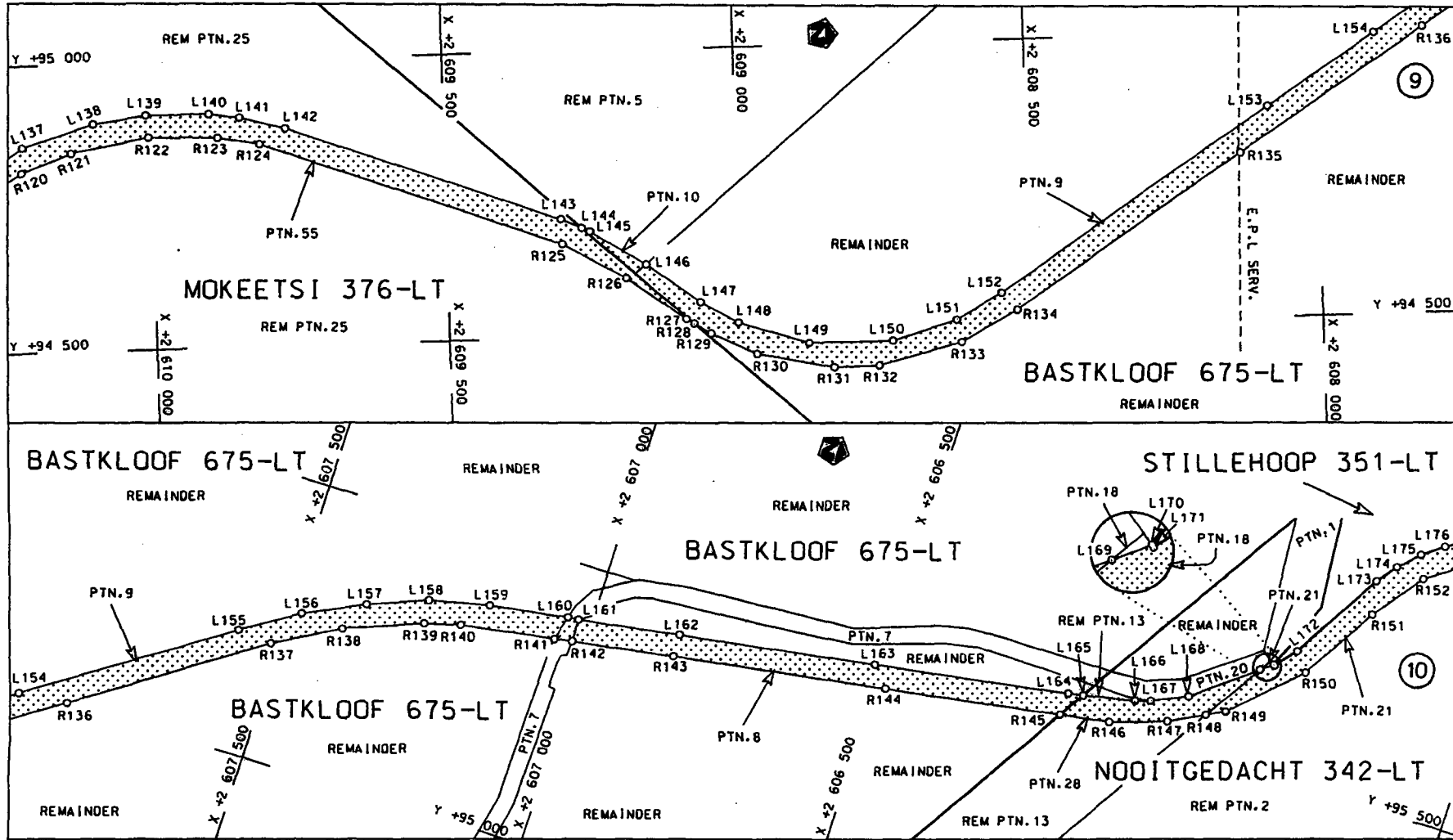

Die Suid Afrikaanse Nasionale Padogenskop Beperk  
 The South African National Roads Agency Limited

Die figuur getoon  
 The figure shown

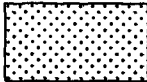

stelsel podreserw vir von 'n gedeelte  
 represents the road reserve of a portion  
 von Nasionale Roete R36 Sektie 8  
 of Notional Route R36 Section 8

Vel Sheet 1 van 16  
 of 6 of 16  
 Plan P658/08



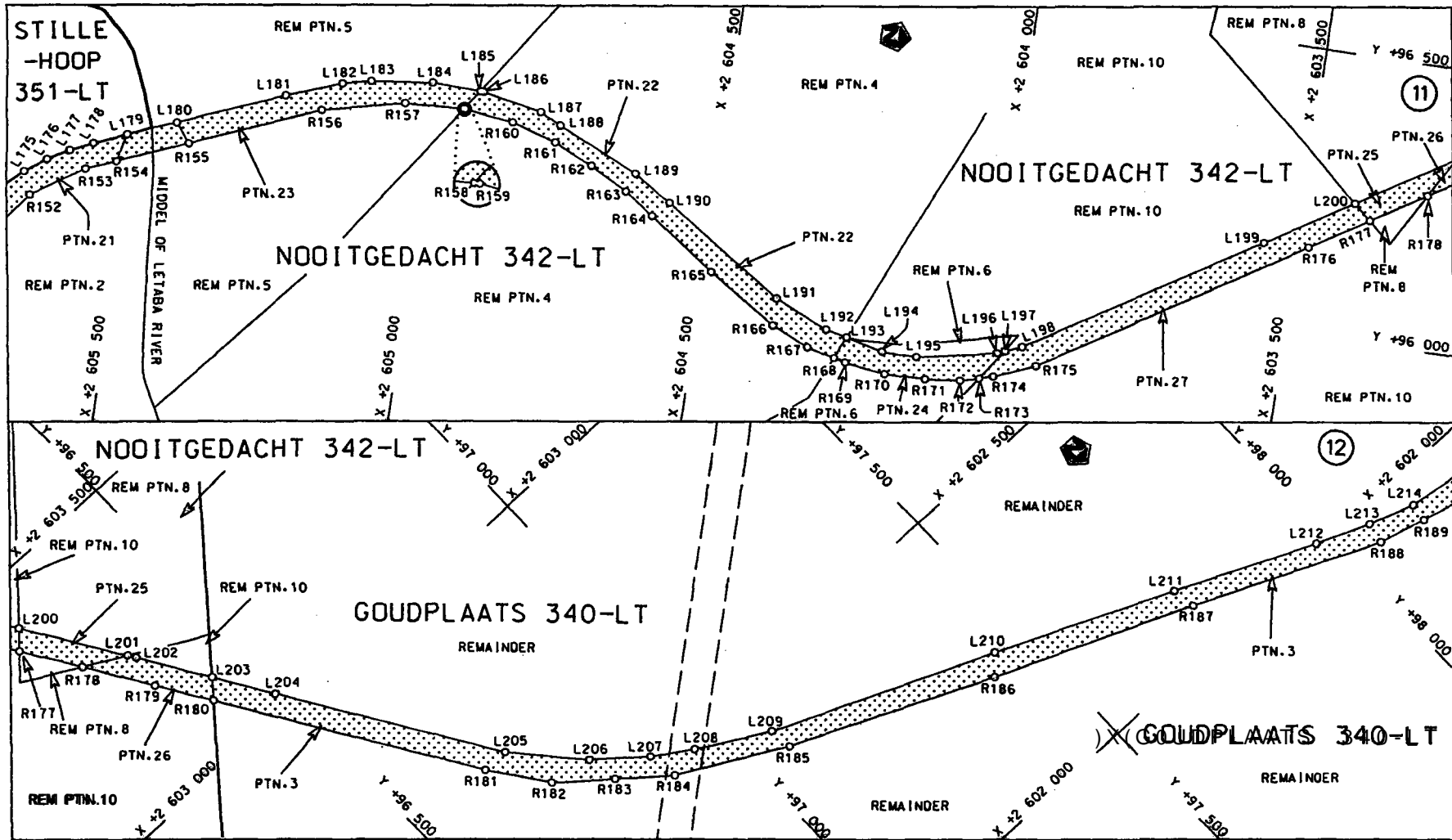

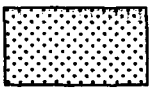
<p>Die Suid Afrikaanse Nasionale Padogenskop Beperk The South African National Roads Agency Limited</p>	<p>Die figuur getoon The figure shown</p> 	<p>steedsie padreserwe voor van 'n gedeelte represents the road reserve of a portion von Nasionale Roete R36 of National Route</p> <p>Seksie 8</p>	<p>Vel Sheet 6 van 15 of 15 Plan P658/08</p>
---	--	--	--

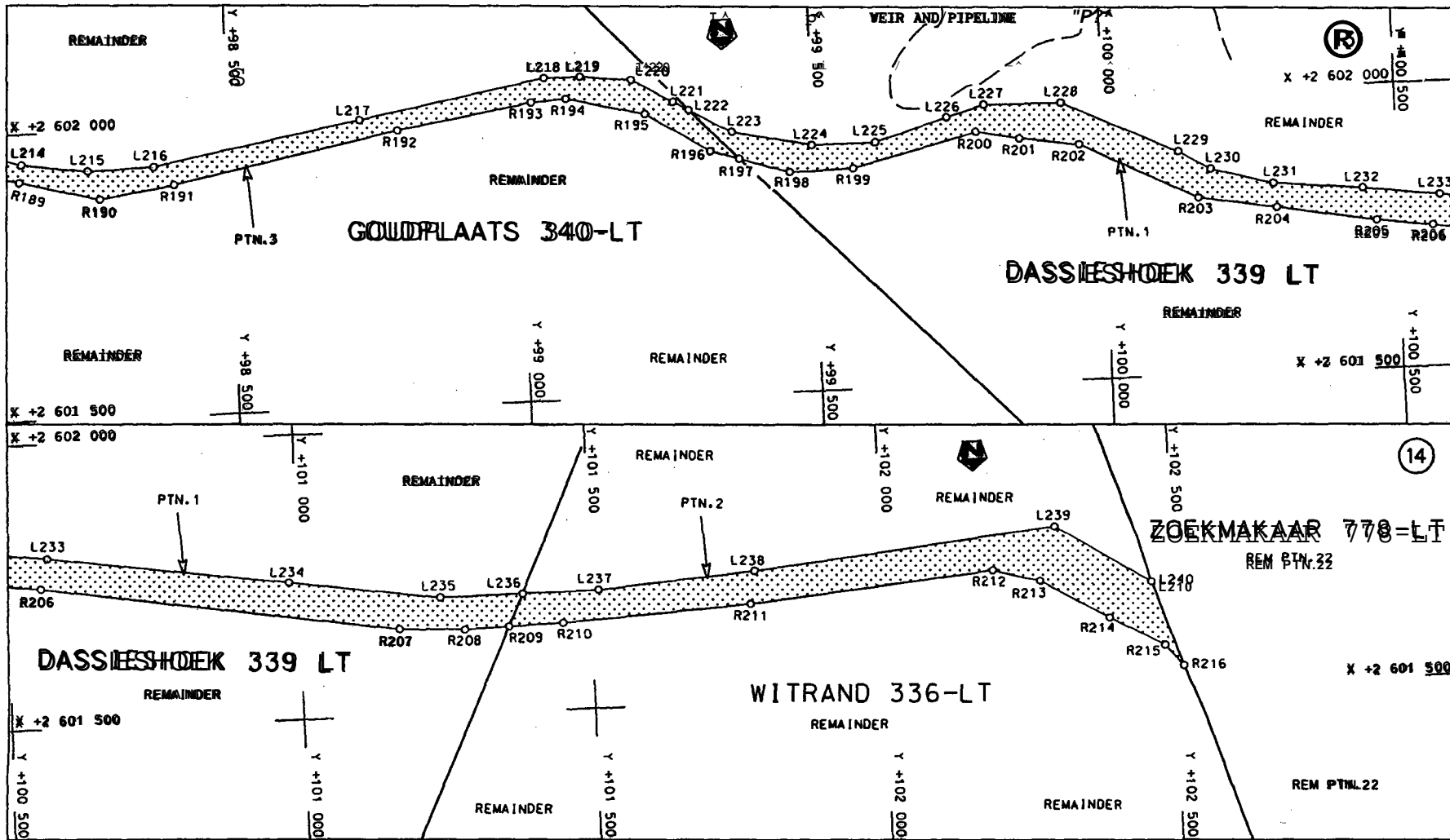

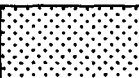
Die Suid Afrikaanse Nasionale Podogentskop Beperk The South African National Roads Agency Limited	Die figuur getoon The figure shown		steldie podreserwe voor van 'n gedeelte represents the road reserve of a portion van Nasionale Roete of National Route <b>R38</b>	Vel Sheet <b>7</b> van of <b>15</b>
			Seksie Section <b>8</b>	Plan <b>P658/08</b>

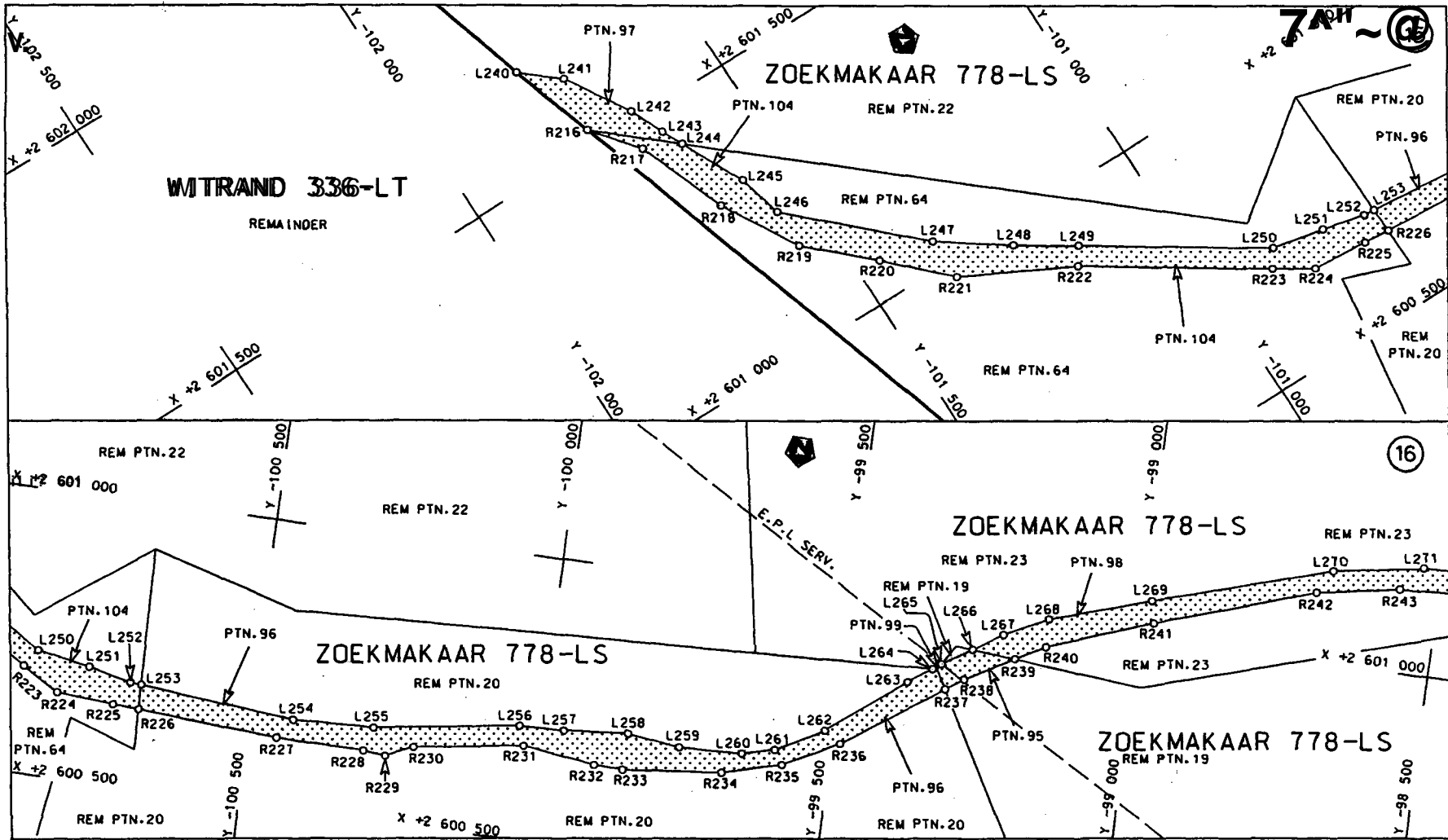

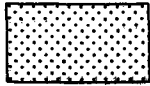
<p>Die Suid Afrikaanse Nasionale Podagentskop Beperk The South African National Roads Agency Limited</p>	<p>Die figuur getoon The figure shown</p> 	<p>stelt die padreserwe voor van 'n gedeelte represents the road reserve of a portion van Nasionale Roete R36 Seksie of National Route Section 8</p>	<p>Vel Sheet 8 von of 15 Plan P658/08</p>
--	--	--	---

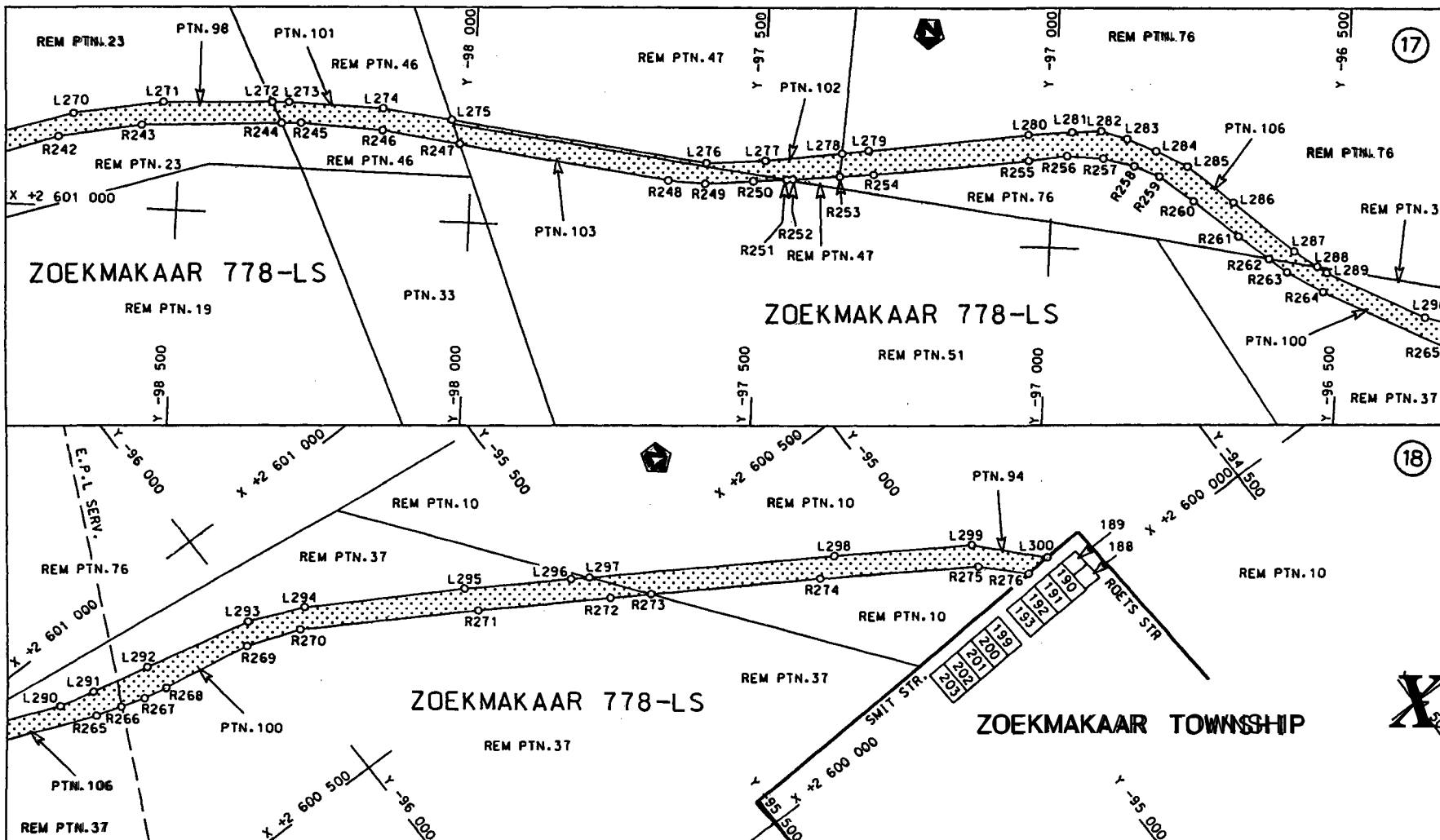

Die Suid Afrikaanse Nasionale Podogenskop Beperk  
 The South African National Roads Agency Limited

Die figuur getoon  
 The figure shown

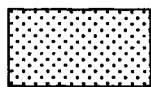

stel die podreserwe voor van 'n gedeelte  
 represents the road reserve of a portion  
 van Nasionale Roete R36 Seksie  
 of National Route R36 Section

8

Van  
 Sheet 9 van  
 of 15

Plan  
 P658/08

PADRESERWE KOÖRDINATE / ROAD RESERVE CO-ORDINATES						
LINKERKANT/LEFT HAND SIDE			REGTERKANT/RIGHT HAND SIDE			
	Y	X	WG31°	Y	X	
L1	87 0988.71	2 621 377.64		R1	87 0555.36	2 621 407.91
L2	87 0885.92	2 621 307.85		R2	87 0344.56	2 621 265.24
L3	87 0881.06	2 621 285.30		R3	86 9777.68	2 621 084.95
L4	87 0661.11	2 621 211.18		R4	86 8443.58	2 620 790.79
L5	87 0553.72	2 621 171.52		R5	86 7116.62	2 620 512.27
L6	87 0388.16	2 621 134.00		R6	86 5778.49	2 620 211.29
L7	87 0099.80	2 621 066.52		R7	86 5446.03	2 620 140.89
L8	86 9288.43	2 620 899.79		R8	86 4977.08	2 620 065.96
L9	86 8775.19	2 620 776.22		R9	86 4099.90	2 619 981.31
L10	86 7443.51	2 620 486.94		R10	86 2727.58	2 619 894.99
L11	86 6600.00	2 620 170.18		R11	86 2633.37	2 619 887.60
L12	86 5555.87	2 620 086.07		R12	86 1144.65	2 619 768.36
L13	86 4644.56	2 619 979.50		R13	86 0388.34	2 619 664.69
L14	86 4113.15	2 619 945.52		R14	85 9844.30	2 619 591.28
L15	86 2300.18	2 619 824.60		R15	85 8229.96	2 619 459.09
L16	86 1666.89	2 619 763.81		R16	85 8008.13	2 619 436.25
L17	86 1544.94	2 619 748.84		R17	85 7433.26	2 619 345.44
L18	86 1322.19	2 619 720.34		R18	85 7011.22	2 619 264.08
L19	86 0077.26	2 619 560.75		R19	85 5744.89	2 618 974.89
L20	85 9477.38	2 619 514.85		R20	85 5644.32	2 618 950.44
L21	85 8622.16	2 619 439.73		R21	85 5330.80	2 618 873.18
L22	85 7800.79	2 619 338.92		R22	85 4888.42	2 618 772.87
L23	85 7388.31	2 619 259.38		R23	85 4188.44	2 618 642.61
L24	85 6844.29	2 619 133.37		R24	85 3770.55	2 618 571.03
L25	85 6600.26	2 619 077.32		R25	85 2991.27	2 618 467.77
L26	85 6388.13	2 619 025.70		R26	85 2032.88	2 618 206.76
L27	85 6113.76	2 618 968.85		R27	85 0935.55	2 618 122.00
L28	85 5922.53	2 618 919.32		R28	85 0927.11	2 618 037.14
L29	85 5811.79	2 618 894.28		R29	85 0074.40	2 617 669.35
L30	85 5077.24	2 618 720.75		R30	85 0115.44	2 617 293.10
L31	85 4600.14	2 618 630.74		R31	85 0338.88	2 617 137.21
L32	85 4114.37	2 618 566.74		R32	85 0489.66	2 617 019.92
L33	85 3211.92	2 618 445.22		R33	85 0477.00	2 616 982.18
L34	85 11377.41	2 618 202.03		R34	85 0458.29	2 616 891.24
L35	85 0699.18	2 618 105.21		R35	85 0458.53	2 616 883.72
L36	85 0115.60	2 618 028.78		R36	85 0461.40	2 616 789.13
L37	84 8322.65	2 617 641.19		R37	85 0448.15	2 616 679.87
L38	84 6444.44	2 617 262.81		R38	85 0450.09	2 616 625.31
L39	84 5355.00	2 617 045.45		R39	85 0476.49	2 616 519.26
L40	84 4977.79	2 616 918.33		R40	85 0479.85	2 616 456.64
L41	84 4977.27	2 616 868.02		R41	85 0485.84	2 616 416.48
L42	84 4966.53	2 616 797.84		R42	85 04730.21	2 616 384.67
L43	84 5116.97	2 616 714.54		R43	85 04796.81	2 616 350.93
L44	84 5311.11	2 616 663.48		R44	85 04187.58	2 616 222.38
L45	84 5778.25	2 616 571.11		R45	85 04342.55	2 616 169.63
L46	84 6119.22	2 616 519.26		R46	85 0409.19	2 616 138.99
L47	84 6900.87	2 616 456.58		R47	85 0490.41	2 616 082.86
L48	84 6966.88	2 616 452.88		R48	85 04737.70	2 615 859.26
L49	84 7999.87	2 616 389.47		R49	85 04933.99	2 615 750.24
L50	84 8822.39	2 616 360.01		R50	86 04038.72	2 615 692.34
L51	85 11722.26	2 616 266.44		R51	86 04211.06	2 615 597.06

Vel 10 Van 15 P658/08  
Sheet of

PADRESERWE KOÖRDINATE / ROAD RESERVE CO-ORDINATES						
LINKERKANT/LEFT HAND SIDE				REGTERKANT/RIGHT HAND SIDE		
	Y	X	WG 31°	Y	X	
L52	85 341.43	2 616 211.53		R52	86 213.93	2 615 595.47
L53	85 424.08	2 616 172.71		R53	86 481.51	2 615 449.26
L54	85 508.36	2 616 116.54		R54	86 501.93	2 615 438.10
L55	85 760.23	2 615 890.67		R55	86 583.20	2 615 401.37
L56	85 927.60	2 615 795.60		R56	86 732.00	2 615 350.35
L57	86 053.90	2 615 725.65		R57	86 827.92	2 615 326.92
L58	86 219.23	2 615 634.09		R58	87 343.01	2 615 297.22
L59	86 236.74	2 615 624.66		R59	87 459.70	2 615 270.34
L60	86 526.01	2 615 468.93		R60	87 544.21	2 615 233.83
L61	86 542.37	2 615 460.12		R61	87 615.99	2 615 189.41
L62	86 704.74	2 615 396.51		R62	87 651.71	2 615 162.58
L63	86 762.76	2 615 378.29		R63	88 179.58	2 614 760.61
L64	86 851.52	2 615 367.91		R64	88 500.43	2 614 515.03
L65	86 865.48	2 615 356.38		R65	88 502.89	2 614 513.15
L66	86 932.88	2 615 354.50		R66	88 582.38	2 614 443.17
L67	86 979.31	2 615 358.95		R67	88 645.19	2 614 371.03
L68	87 357.72	2 615 332.65		R68	88 714.07	2 614 254.68
L69	87 473.93	2 615 303.51		R69	88 811.16	2 614 026.54
L70	87 557.46	2 615 268.63		R70	88 878.83	2 613 923.49
L71	87 634.41	2 615 221.76		R71	89 036.54	2 613 691.60
L72	87 669.29	2 615 194.97		R72	89 091.18	2 613 628.77
L73	88 186.79	2 614 800.96		R73	89 134.36	2 613 587.93
L74	88 459.10	2 614 590.92		R74	89 244.77	2 613 515.11
L75	88 527.30	2 614 538.31		R75	89 836.04	2 613 172.30
L76	88 606.13	2 614 471.42		R76	89 905.08	2 613 116.84
L77	88 665.78	2 614 400.15		R77	90 148.74	2 612 894.00
L78	88 724.69	2 614 289.52		R78	90 290.39	2 612 760.38
L79	88 726.90	2 614 284.58		R79	90 509.62	2 612 537.02
L80	88 733.63	2 614 256.43		R80	90 691.93	2 612 351.28
L81	88 858.91	2 614 009.34		R81	90 747.05	2 612 293.57
L82	88 916.12	2 613 926.38		R82	90 891.29	2 612 142.54
L83	89 063.17	2 613 710.86		R83	90 981.51	2 612 049.04
L84	89 117.85	2 613 652.08		R84	91 172.09	2 611 851.52
L85	89 163.06	2 613 610.86		R85	91 324.85	2 611 693.30
L86	89 223.68	2 613 566.66		R86	91 352.31	2 611 644.49
L87	89 824.75	2 613 223.07		R87	91 362.65	2 611 623.23
L88	89 854.65	2 613 206.32		R88	91 386.73	2 611 621.91
L89	89 884.55	2 613 183.61		R89	91 522.79	2 611 523.15
L90	89 925.91	2 613 152.14		R90	91 650.73	2 611 457.45
L91	90 086.26	2 613 004.21		R91	91 747.88	2 611 433.12
L92	90 175.08	2 612 919.16		R92	91 888.50	2 611 418.44
L93	90 312.84	2 612 787.27		R93	91 921.70	2 611 417.63
L94	90 640.94	2 612 452.95		R94	92 049.10	2 611 419.15
L95	90 910.19	2 612 175.64		R95	92 209.73	2 611 433.89
L96	91 025.13	2 612 058.70		R96	92 360.16	2 611 454.01
L97	91 200.23	2 611 880.57		R97	92 432.52	2 611 463.69
L98	91 424.07	2 611 648.14		R98	92 483.72	2 611 467.86
L99	91 495.35	2 611 584.90		R99	92 745.94	2 611 499.17
L100	91 576.01	2 611 533.15		R100	92 881.85	2 611 520.87
L101	91 666.20	2 611 493.80		R101	93 045.63	2 611 529.56
L102	91 749.40	2 611 470.84		R102	93 152.07	2 611 514.37

Vel	11	Van	15	P658/08
Sheet		of		

PADRESERWE KOÖRDINATE / ROAD RESERVE CO-ORDINATES									
LINKERKANT/LEFT HAND SIDE					REGTERKANT/RIGHT HAND SIDE				
		Y	X	WG 31°			X		
L103	91	858.86	2 611	457.49	R103	93	433.16	2 611	433.21
L104	91	903.23	2 611	456.27	R104	93	525.96	2 611	413.65
L105	91	972.08	2 611	452.94	R105	93	539.62	2 611	412.81
L106	92	061.02	2 611	454.34	R106	93	632.83	2 611	407.06
L107	92	195.28	2 611	472.31	R107	93	735.98	2 611	415.18
L108	92	347.42	2 611	494.60	R108	93	805.82	2 611	429.72
L109	92	424.09	2 611	505.84	R109	93	856.16	2 611	425.64
L110	92	448.60	2 611	509.43	R110	93	875.85	2 611	416.01
L111	92	916.80	2 611	569.33	R111	93	905.09	2 611	380.15
L112	93	000.75	2 611	570.99	R112	93	918.06	2 611	346.90
L113	93	047.22	2 611	571.90	R113	93	954.04	2 611	288.69
L114	93	156.35	2 611	555.57	R114	94	006.34	2 611	196.24
L115	93	242.04	2 611	533.48	R115	94	012.80	2 611	186.53
L116	93	338.25	2 611	503.22	R116	94	407.33	2 610	723.71
L117	93	443.10	2 611	476.57	R117	94	519.31	2 610	593.43
L118	93	532.92	2 611	457.46	R118	94	708.71	2 610	370.81
L119	93	632.34	2 611	451.39	R119	94	755.30	2 610	313.69
L120	93	727.89	2 611	458.66	R120	94	811.66	2 610	221.50
L121	93	821.93	2 611	480.12	R121	94	844.35	2 610	136.44
L122	93	864.01	2 611	494.10	R122	94	868.79	2 610	004.41
L123	93	970.85	2 611	532.29	R123	94	864.63	2 609	886.42
L124	93	985.32	2 611	493.40	R124	94	851.25	2 609	814.79
L125	93	948.86	2 611	462.95	R125	94	662.77	2 609	300.32
L126	93	941.75	2 611	439.02	R126	94	600.81	2 609	193.03
L127	93	942.16	2 611	390.71	R127	94	526.55	2 609	092.69
L128	93	988.20	2 611	292.84	R128	94	518.05	2 609	079.26
L129	94	034.93	2 611	223.91	R129	94	499.70	2 609	050.25
L130	94	064.01	2 611	186.27	R130	94	461.36	2 608	972.31
L131	94	396.21	2 610	798.29	R131	94	433.98	2 608	840.65
L132	94	399.17	2 610	786.35	R132	94	434.92	2 608	762.80
L133	94	414.42	2 610	776.93	R133	94	472.02	2 608	619.55
L134	94	480.16	2 610	699.73	R134	94	525.66	2 608	523.17
L135	94	548.20	2 610	619.82	R135	94	787.58	2 608	133.27
L136	94	738.57	2 610	396.38	R136	95	001.79	2 607	815.07
L137	94	855.56	2 610	218.80	R137	95	206.28	2 607	513.59
L138	94	894.50	2 610	098.12	R138	95	268.21	2 607	403.81
L139	94	907.71	2 610	008.51	R139	95	318.76	2 607	273.67
L140	94	907.02	2 609	900.98	R140	95	334.86	2 607	213.38
L141	94	898.53	2 609	848.61	R141	95	360.66	2 607	052.26
L142	94	877.89	2 609	770.49	R142	95	365.52	2 607	021.91
L143	94	705.90	2 609	302.07	R143	95	393.30	2 606	848.38
L144	94	689.99	2 609	266.93	R144	95	449.36	2 606	483.70
L145	94	683.75	2 609	253.14	R145	95	495.85	2 606	183.59
L146	94	624.13	2 609	158.85	R146	95	509.00	2 606	098.70
L147	94	555.10	2 609	066.68	R147	95	540.41	2 606	003.51
L148	94	517.39	2 609	003.26	R148	95	570.32	2 605	945.14
L149	94	478.47	2 608	882.34	R149	95	585.80	2 605	914.94
L150	94	477.79	2 608	737.55	R150	95	692.41	2 605	805.55
L151	94	511.35	2 608	627.58	R151	95	824.15	2 605	725.76
L152	94	556.15	2 608	548.84	R152	95	910.15	2 605	660.56
L153	94	868.27	2 608	084.89	R153	95	969.23	2 605	575.74

Vel	12	Van	15	P658/08
Sheet		of		

PADRESERWE KOÖRDINATE / ROAD RESERVE CO-ORDINATES											
LINKERKANT/LEFT HAND SIDE					REGTERKANT/RIGHT HAND SIDE						
					WG 31°	X					
L154	94	993.40	2	607	899.004	R154	95	990.13	2	605	525.99
L155	95	211.54	2	607	573.68	R155	96	039.29	2	605	408.96
L156	95	272.41	2	607	478.40	R156	96	130.65	2	605	191.47
L157	95	321.52	2	607	377.26	R157	96	164.23	2	605	051.41
L158	95	360.16	2	607	278.41	R158	96	169.47	2	604	950.70
L159	95	383.43	2	607	176.29	R159	96	169.62	2	604	947.76
L160	95	403.65	2	607	040.78	R160	96	159.22	2	604	863.46
L161	95	405.45	2	607	022.84	R161	96	136.39	2	604	785.59
L162	95	432.13	2	606	849.87	R162	96	105.16	2	604	717.82
L163	95	484.35	2	606	513.09	R163	96	069.50	2	604	652.03
L164	95	535.40	2	606	181.36	R164	96	033.99	2	604	602.13
L165	95	540.47	2	606	155.82	R165	95	952.73	2	604	487.00
L166	95	558.00	2	606	067.43	R166	95	876.49	2	604	368.96
L167	95	565.76	2	606	041.73	R167	95	848.05	2	604	304.69
L168	95	592.60	2	605	982.88	R168	95	835.44	2	604	256.83
L169	95	673.20	2	605	881.18	R169	95	830.08	2	604	236.48
L170	95	688.54	2	605	861.78	R170	95	821.12	2	604	166.35
L171	95	687.33	2	605	860.33	R171	95	822.54	2	604	096.35
L172	95	723.93	2	605	831.14	R172	95	829.21	2	604	037.25
L173	95	882.31	2	605	736.59	R173	95	838.10	2	604	005.42
L174	95	916.68	2	605	709.37	R174	95	844.67	2	603	981.92
L175	95	949.81	2	605	676.38	R175	95	874.40	2	603	916.70
L176	95	975.91	2	605	641.63	R176	96	150.52	2	603	480.43
L177	95	996.76	2	605	607.17	R177	96	213.17	2	603	382.71
L178	96	015.13	2	605	569.61	R178	96	272.34	2	603	290.41
L179	96	038.31	2	605	515.45	R179	96	340.95	2	603	183.38
L180	96	071.94	2	605	434.78	R180	96	396.99	2	603	095.89
L181	96	146.36	2	605	256.28	R181	96	656.56	2	602	690.71
L182	96	182.23	2	605	162.73	R182	96	726.39	2	602	595.73
L183	96	193.45	2	605	114.41	R183	96	810.64	2	602	526.44
L184	96	206.54	2	605	010.12	R184	96	890.60	2	602	461.74
L185	96	204.66	2	604	926.98	R185	97	070.15	2	602	366.36
L186	96	204.52	2	604	920.89	R186	97	411.84	2	602	214.98
L187	96	184.68	2	604	817.16	R187	97	747.12	2	602	082.96
L188	96	167.16	2	604	781.21	R188	98	059.56	2	601	937.09
L189	96	103.47	2	604	640.60	R189	98	141.42	2	601	915.81
L190	96	060.95	2	604	575.78	R190	98	276.63	2	601	881.70
L191	95	924.06	2	604	370.14	R191	98	404.56	2	601	901.91
L192	95	883.55	2	604	277.14	R192	98	788.63	2	601	981.87
L193	95	875.31	2	604	239.88	R193	99	020.45	2	602	021.76
L194	95	859.88	2	604	176.00	R194	99	080.34	2	602	026.35
L195	95	858.94	2	604	116.98	R195	99	214.54	2	601	994.37
L196	95	887.29	2	603	981.17	R196	99	324.87	2	601	925.69
L197	95	892.87	2	603	968.03	R197	99	374.43	2	601	910.24
L198	95	904.81	2	603	939.87	R198	99	459.31	2	601	883.78
L199	96	147.25	2	603	557.35	R199	99	568.34	2	601	886.20
L200	96	239.74	2	603	412.69	R200	99	781.51	2	601	940.76
L201	96	342.16	2	603	252.52	R201	99	856.46	2	601	926.66
L202	96	350.38	2	603	239.66	R202	99	959.46	2	601	911.75
L203	96	422.47	2	603	126.90	R203	1 00	159.55	2	601	809.87
L204	96	482.81	2	603	032.52	R204	1 00	292.777	2	601	787.64

Vel	13	Van	15	P658/08
Sheet		of		



**PADRESERVE KOORDINATIE / ROAD RESERVECOORDINATES**

**LINKERONWELFTE HANDSIBE**

**REGTERKANT/RIGHT HAND SIBE**

LINKERONWELFTE HANDSIBE	REGTERKANT/RIGHT HAND SIBE
L2005	602.06901.120
L2006	602.06901.121
L2007	602.06901.122
L2008	602.06901.123
L2009	602.06901.124
L2010	602.06901.125
L2011	602.06901.126
L2012	602.06901.127
L2013	602.06901.128
L2014	602.06901.129
L2015	602.06901.130
L2016	602.06901.131
L2017	602.06901.132
L2018	602.06901.133
L2019	602.06901.134
L2020	602.06901.135
L2021	602.06901.136
L2022	602.06901.137
L2023	602.06901.138
L2024	602.06901.139
L2025	602.06901.140
L2026	602.06901.141
L2027	602.06901.142
L2028	602.06901.143
L2029	602.06901.144
L2030	602.06901.145
L2031	602.06901.146
L2032	602.06901.147
L2033	602.06901.148
L2034	602.06901.149
L2035	602.06901.150
L2036	602.06901.151
L2037	602.06901.152
L2038	602.06901.153
L2039	602.06901.154
L2040	602.06901.155
L2041	602.06901.156
L2042	602.06901.157
L2043	602.06901.158
L2044	602.06901.159
L2045	602.06901.160
L2046	602.06901.161
L2047	602.06901.162
L2048	602.06901.163
L2049	602.06901.164
L2050	602.06901.165

WG 310

X

WG 299

Y

X

LINKERONWELFTE HANDSIBE	REGTERKANT/RIGHT HAND SIBE
L2240	601.6706.027
L2241	601.6706.028
L2242	601.6706.029
L2243	601.6706.030
L2244	601.6706.031
L2245	601.6706.032
L2246	601.6706.033
L2247	601.6706.034
L2248	601.6706.035
L2249	601.6706.036
L2250	601.6706.037

Vari	14	Vari	15	P650/088
Sheet		of		

PADRESERVE KOÖRDINATE / ROAD RESERVE COORDINATES											
LINKERKANT/LEFT HAND SIDE					REGTERKANT/RIGHT HAND SIDE						
					WG29°	X					
L251	-100	785.51	2	600	701.53	R227	-100	451.87	2	600	621.80
L252	-100	712.08	2	600	684.20	R228	-100	300.67	2	600	619.98
L253	-100	692.77	2	600	682.34	R229	-100	262.34	2	600	615.97
L254	-100	427.41	2	600	656.81	R230	-100	215.33	2	600	637.84
L255	-100	287.96	2	600	662.38	R231	-100	025.81	2	600	666.69
L256	-100	036.48	2	600	700.41	R232	-99	901.93	2	600	649.70
L257	-99	960.61	2	600	702.69	R233	-99	851.91	2	600	648.06
L258	-99	850.77	2	600	712.69	R234	-99	680.87	2	600	667.13
L259	-99	759.75	2	600	701.15	R235	-99	580.49	2	600	694.90
L260	-99	650.45	2	600	704.98	R236	-99	485.85	2	600	745.15
L261	-99	595.82	2	600	719.45	R237	-99	318.69	2	600	864.94
L262	-99	514.63	2	600	764.76	R238	-99	288.49	2	600	886.58
L263	-99	385.23	2	600	868.97	R239	-99	205.48	2	600	934.03
L264	-99	345.58	2	600	897.49	R240	-99	155.89	2	600	962.37
L265	-99	331.16	2	600	907.86	R241	-98	977.46	2	601	029.21
L266	-99	280.71	2	600	940.75	R242	-98	707.18	2	601	120.80
L267	-99	229.71	2	600	973.68	R243	-98	566.59	2	601	145.97
L268	-99	156.05	2	601	011.65	R244	-98	328.46	2	601	159.47
L269	-98	985.90	2	601	067.85	R245	-98	295.57	2	601	161.33
L270	-98	683.97	2	601	162.27	R246	-98	155.62	2	601	154.32
L271	-98	530.99	2	601	188.00	R247	-98	021.72	2	601	136.67
L272	-98	345.92	2	601	195.69	R248	-97	660.40	2	601	089.03
L273	-98	317.48	2	601	196.87	R249	-97	595.99	2	601	086.35
L274	-98	156.28	2	601	192.67	R250	-97	513.83	2	601	094.33
L275	-98	037.35	2	601	177.85	R251	-97	457.72	2	601	099.43
L276	-97	595.57	2	601	122.82	R252	-97	446.93	2	601	100.41
L277	-97	494.71	2	601	131.33	R253	-97	366.22	2	601	109.00
L278	-97	364.03	2	601	150.01	R254	-97	308.42	2	601	115.16
L279	-97	318.79	2	601	156.48	R255	-97	042.12	2	601	150.90
L280	-97	044.44	2	601	195.74	R256	-96	976.45	2	601	161.89
L281	-96	969.71	2	601	203.50	R257	-96	914.44	2	601	160.07
L282	-96	919.90	2	601	207.40	R258	-96	860.91	2	601	149.15
L283	-96	875.04	2	601	195.50	R259	-96	817.07	2	601	132.32
L284	-96	824.40	2	601	176.72	R260	-96	756.99	2	601	091.99
L285	-96	769.96	2	601	152.63	R261	-96	677.64	2	601	033.63
L286	-96	689.15	2	601	092.90	R262	-96	624.18	2	600	996.44
L287	-96	580.86	2	601	011.37	R263	-96	592.08	2	600	974.11
L288	-96	540.04	2	600	986.04	R264	-96	528.11	2	600	942.56
L289	-96	523.43	2	600	975.74	R265	-96	313.74	2	600	855.14
L290	-96	351.87	2	600	906.28	R266	-96	269.99	2	600	842.06
L291	-96	292.29	2	600	892.52	R267	-96	228.50	2	600	828.99
L292	-96	192.77	2	600	870.05	R268	-96	187.77	2	600	821.51
L293	-96	007.15	2	600	828.05	R269	-96	034.30	2	600	795.59
L294	-95	915.40	2	600	790.31	R270	-95	945.36	2	600	763.44
L295	-95	677.15	2	600	650.41	R271	-95	681.06	2	600	605.49
L296	-95	521.68	2	600	552.17	R272	-95	487.86	2	600	485.32
L297	-95	495.43	2	600	535.74	R273	-95	428.35	2	600	448.33
L298	-95	135.63	2	600	310.47	R274	-95	180.08	2	600	294.01
L299	-94	935.52	2	600	181.55	R275	-94	949.91	2	600	145.22
L300	-94	845.48	2	600	084.50	R276	-94	889.24	2	600	081.96

Vel	15	Van	15	P658/08
Sheet		of		

**ACCEPTABLE PAYMENT FOR SERVICES  
AND GOODS IN GOVERNMENT PRINTING  
WORKS**

**WITH IMMEDIATE EFFECT ALL  
PAYMENTS FOR SERVICES RENDERED AND GOODS DIS-  
PATCHED SHOULD BE BY MEANS OF CASH, ELECTRONIC  
TRANSFER OR BANK GUARANTEED CHEQUES**

**IMPLEMENTATION OF THIS  
CIRCULAR IS WITHOUT EXCEPTION**

**NOTICE TO:**

**SUBSCRIBERS**

**OF**

**GOVERNMENT GAZETTES**

Subscribers who have previously arranged to collect their weekly publications of *Government Gazettes* from the Government Printing Works in the Masada Building, are hereby requested to collect their publications from the Old Government Printing Works Building at the Security Officer's Bay at the Proes Street entrance, with effect from the 16th of October 2006.

We look forward to your ongoing support

Contact Person: **Montjane M. Z. (Mr)**

Mobile Phone: 083-640 6121..

Telephone: (012) 334-4653.

# Looking for out of print issues of Government and Provincial Gazettes

We can provide photocopies  
We can provide photocopies

## Contact

The National Library of South Africa,  
Pretoria Campus  
Pretoria Campus  
PO Box 397  
PO Box 397  
0001 PRETORIA  
0001 PRETORIA

## Physical address

C/o Andries and Vermeulen Streets  
Entrance in Andries Street

## Contact details

Tel: (012) 321-8931

Fax: (012) 325-5984

E-mail: [infodesk@nlsa.ac.za](mailto:infodesk@nlsa.ac.za)

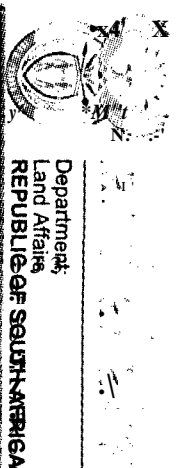

# Surveys & Mapping

*Surveys and Mapping is South Africa's national survey and mapping organisation providing survey, mapping and geo-spatial products and services to the public and private sectors for over 80 years*

## Products and Services

- \* Maps - Topographical, Topocadastral, Orthophoto, Walk maps, Aeronautical charts, Professional maps
- \* Digital Maps, elevation models, images
- \* GPS Base Station data • EGNOS
- \* Lithographic survey information
- \* Aerial Photography - from 1986 to present day
- \* Professional advice in the fields of surveys and mapping
- \* Career information and promotions
- \* Workshops on the use of mapping products
- \* Support to the land reform programmes

### Contact details

<http://w3.sli.wcape.gov.za>  
Tel: (021) 658 4300  
Email: [cdsm@sli.wcape.gov.za](mailto:cdsm@sli.wcape.gov.za)



Printed by and obtainable from the Government Printer, Bosman Street, Private Bag X85, Pretoria, 0001  
Publications: Tel: (012) 334-4508, 334-4509, 334-4510  
Advertisements: Tel: (012) 334-4673, 334-4674, 334-4504  
Subscriptions: Tel: (012) 334-4735, 334-4736, 334-4737  
Cape Town Branch: Tel: (021) 465-7531

Gedruk deur en verkrygbaar by die Staatsdrukker, Bosmanstraat, Privaatsak X85, Pretoria, 0001  
Publikasies: Tel: (012) 334-4508, 334-4509, 334-4510  
Advertensies: Tel: (012) 334-4673, 334-4674, 334-4504  
Subskripsies: Tel: (012) 334-4735, 334-4736, 334-4737  
Kaapstad-tak: Tel: (021) 465-7531