

IMPORTANT NOTICE

The Government Printing Works will not be held responsible for faxed documents not received due to errors on the fax machine or faxes received which are unclear or incomplete. Please be advised that an "OK" slip, received from a fax machine, will not be accepted as proof that documents were received by the GPW for printing. If documents are faxed to the GPW it will be the sender's responsibility to phone and confirm that the documents were received in good order.

Furthermore the Government Printing Works will also not be held responsible for cancellations and amendments which have not been done on original documents received from clients.

CONTENTS**INHOUD**

<i>No.</i>	<i>Page No.</i>	<i>Gazette No.</i>	<i>No.</i>	<i>Bladsy No.</i>	<i>Koerant No.</i>
GOVERNMENT NOTICE			GOEWERMENTSKENNISGEWING		
Transport, Department of			Vervoer, Departement van		
<i>Government Notice</i>			<i>Goewermentskennisgewing</i>		
913			913		
South African National Roads Agency Limited and the National Roads Act (7/1998): The South African National Roads Agency Limited: Declaration amendment of National Road R27 Section 10: Amendment of Declaration No. 285 of 2006	3	33639	Suid-Afrikaanse Nasionale Padagentskap Beperk en die Nasionale Paaie Wet (7/1998): Die Suid-Afrikaanse Nasionale Padagentskap Beperk: Verklaring wysiging van Nasionale Pad R27 Seksie 10: Wysiging van Verklaring No. 285 van 2006	4	33639

GOVERNMENT NOTICE

DEPARTMENT OF TRANSPORT

No. 913

19 October 2010

THE SOUTH AFRICAN NATIONAL ROADS AGENCY LIMITED

Registration No: 98/09584/06

DECLARATION AMENDMENT OF NATIONAL ROAD R27 SECTION 10

AMENDMENT OF DECLARATION No. 285 OF 2006

By virtue of section 40(1)(b) of the South African National Roads Agency Limited and the National Roads Act, 1998 (Act No. 7 of 1998), I hereby amend Declaration No. 285 of 2006, by substituting the descriptive section of the route from Brandvlei up to Kenhardt, with the subjoined sheets 1 to 30 of Plan No. P707/08.

(National Road R27 Section 10: Brandvlei – Kenhardt)



MINISTER OF TRANSPORT

GOEWERMENSKENNISGEWING

DEPARTEMENT VAN VERVOER

No. 913

19 Oktober 2010

**DIE SUID-AFRIKAANSE NASIONALE
PADAGENTSKAP BEPERK**

Registrasie No: 98/09584/06

VERKLARING WYSIGING VAN NASIONALE PAD R27 SEKSIE 10

WYSIGING VAN VERKLARING NO. 285 VAN 2006

Kragtens Artikel 40(1)(b) van die Suid-Afrikaanse Nasionale Padagentskap Beperk en die Nasionale Paaie Wet, 1998 (Wet no. 7 van 1998), wysig ek hiermee Verklaring no. 285 van 2006, deur die beskrywende gedeelte van die roete vanaf Brandvlei tot by Kenhardt, te vervang met meegaande velle 1 tot 30 van Plan no. P707/08.

(Nasionale Pad R27 Seksie 10: Brandvlei – Kenhardt)



MINISTER VAN VERVOER

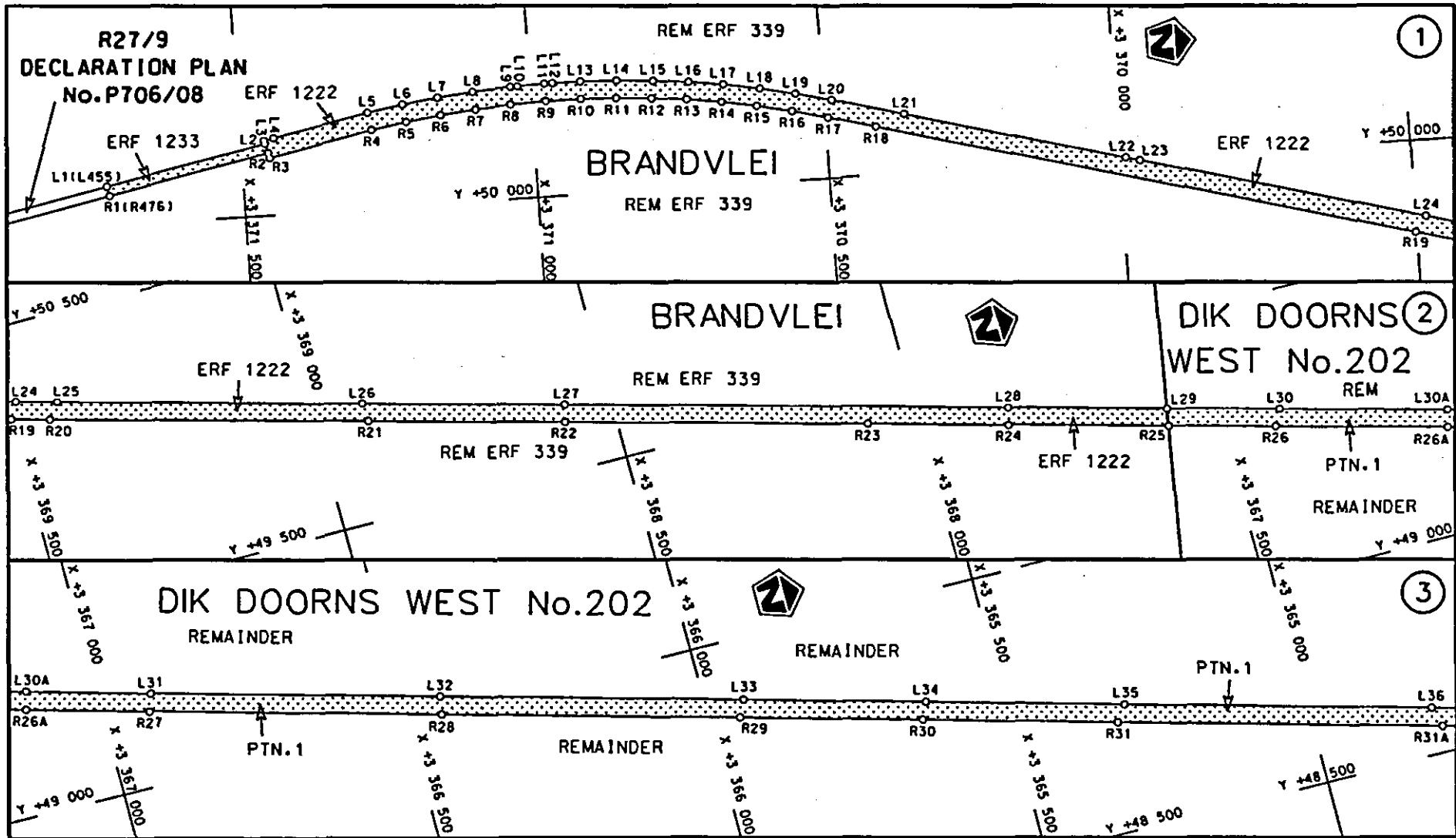

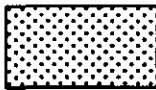
<p>Die Suid Afrikaanse Nasionale Padagentskap Beperk The South African National Roads Agency Limited</p>	<p>Die figuur getoon The figure shown</p>		<p>stel die padreserwe voor van 'n gedeelte represents the road reserve of a portion van Nasionale Roete R27 of National Route</p> <p>Seksie 10</p>	<p>Vel Sheet 1 van of 30 Plan P707/08</p>
--	---	--	---	---

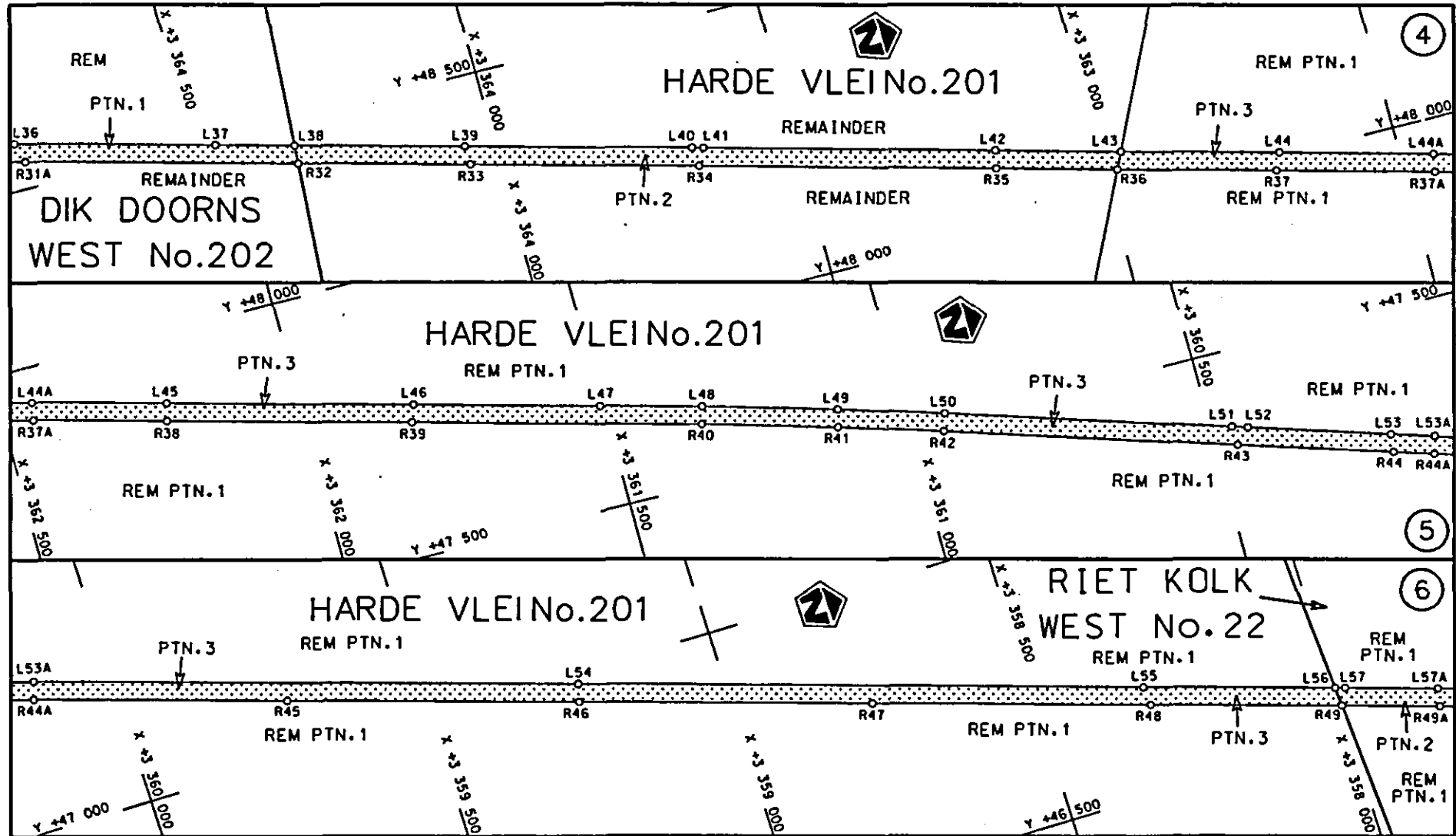

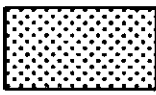
Die Suid Afrikaanse Nasionale Padagentskap Beperk The South African National Roads Agency Limited	Die figuur getoon The figure shown		steldie padreserwe voor van 'n gedeelte represents the road reserve of a portion van Nasionale Roete R27 Seksie of National Route 10 Section	Vel Sheet 2 van of 30 Plan P707/08
--	---------------------------------------	--	---	---------------------------------------

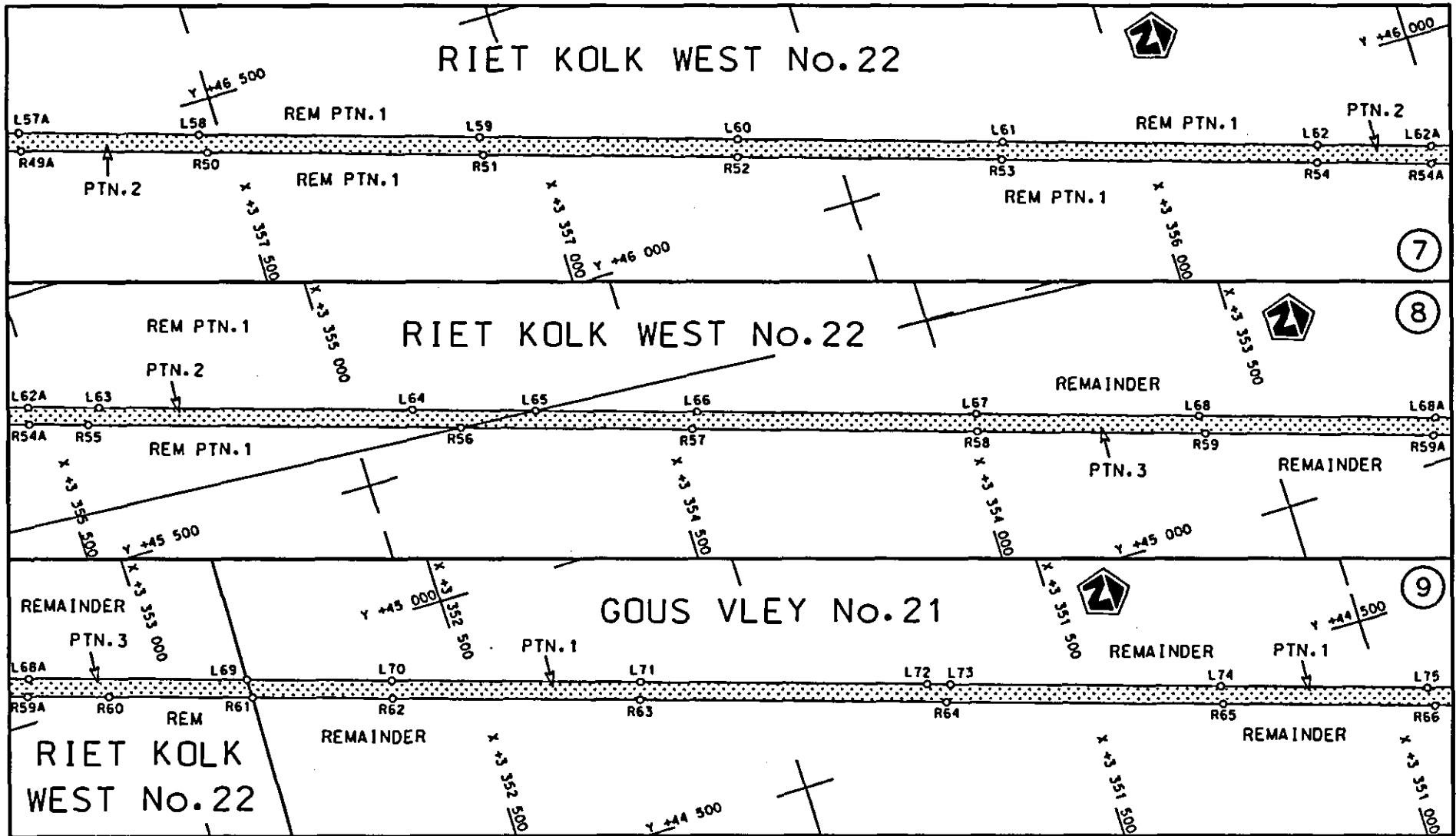

STATSKOERANT, 19 OKTOBER 2010

No. 33639 7

<p>Die Suid Afrikaanse Nasionale Padagentskap Beperk The South African National Roads Agency Limited</p>	<p>Die figuur getoon The figure shown</p>		<p>steldie padreserwe voor van 'n gedeelte represents the road reserve of a portion van Nasionale Roete R27 Sektie 10 of National Route R27 Section 10</p>	<p>Vel Sheet 3 van 30 Plan P707/08</p>
--	---	--	--	--

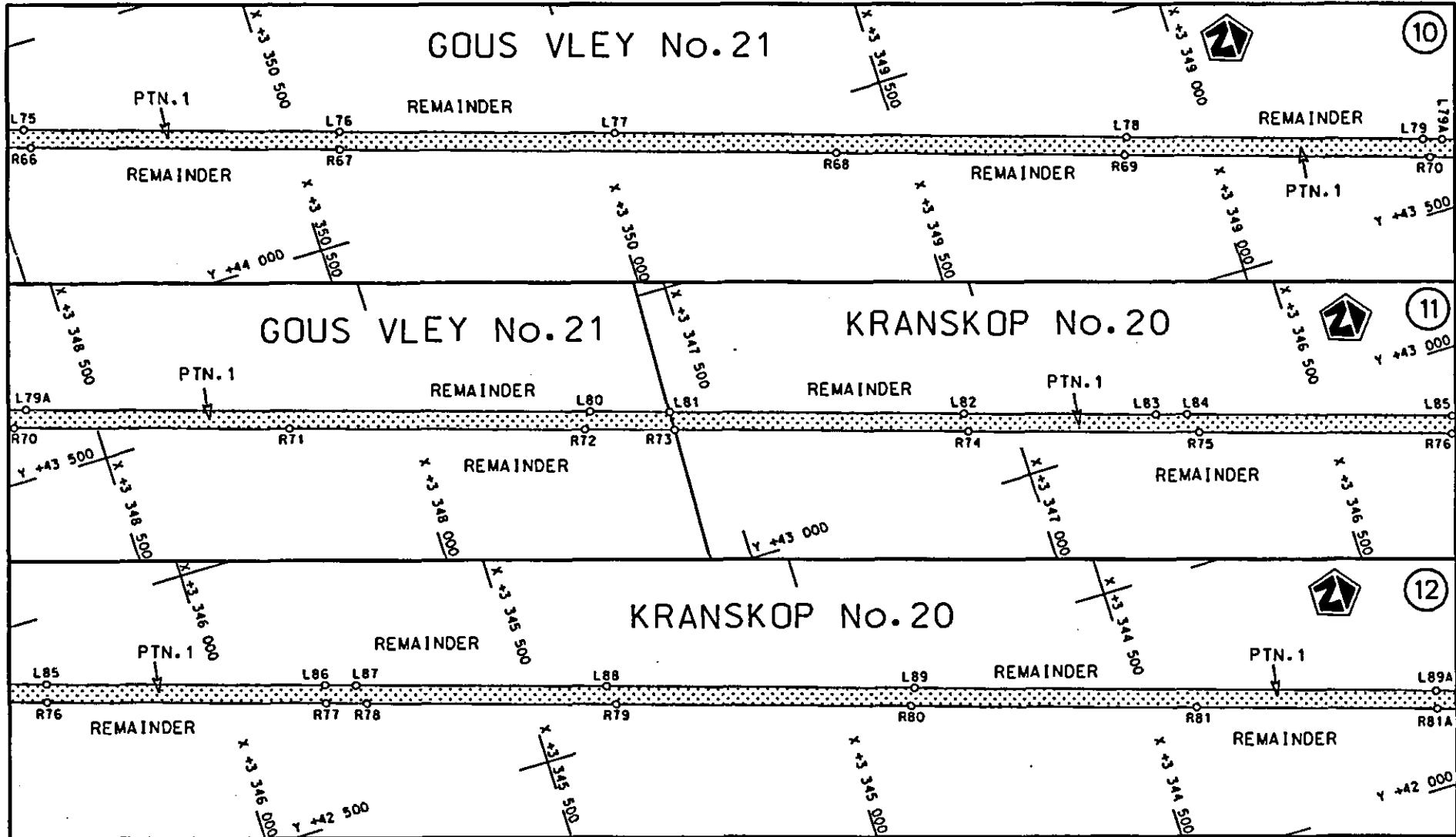

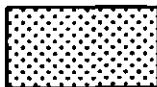
<p>Die Suid Afrikaanse Nasionale Padagentskap Beperk The South African National Roads Agency Limited</p>	<p>Die figuur getoon The figure shown</p> 	<p>steldie podreserwe voor van 'n gedeelte represents the road reserve of a portion van Nasionale Roete R27 Seksie Section 10 of National Route</p>	<p>Vel Sheet 4 van of 30 Plan P707/08</p>
--	--	---	---

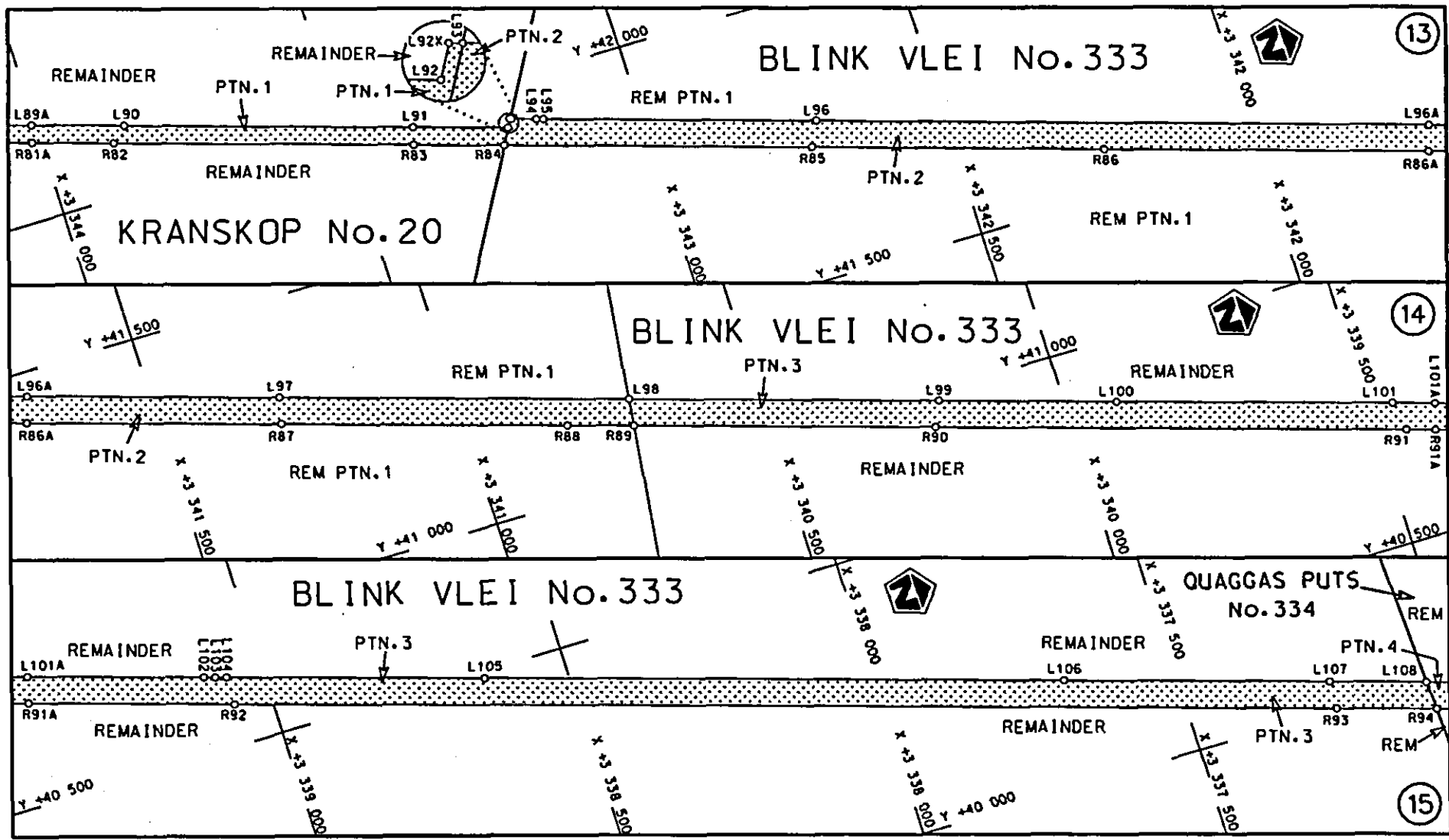

STATSKOERANT, 19 OKTOBER 2010

No. 33639 9

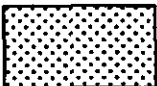
<p>Die Suid Afrikaanse Nasionale Padagentskap Beperk The South African National Roads Agency Limited</p>	<p>Die figuur getoon The figure shown</p>		<p>stel die padreserwe voor van 'n gedeelte represents the road reserve of a portion van Nasionale Roete R27 Sektie of National Route Section 10</p>	<p>Vel Sheet 5 van of 30</p>
				<p>Plan P707/08</p>

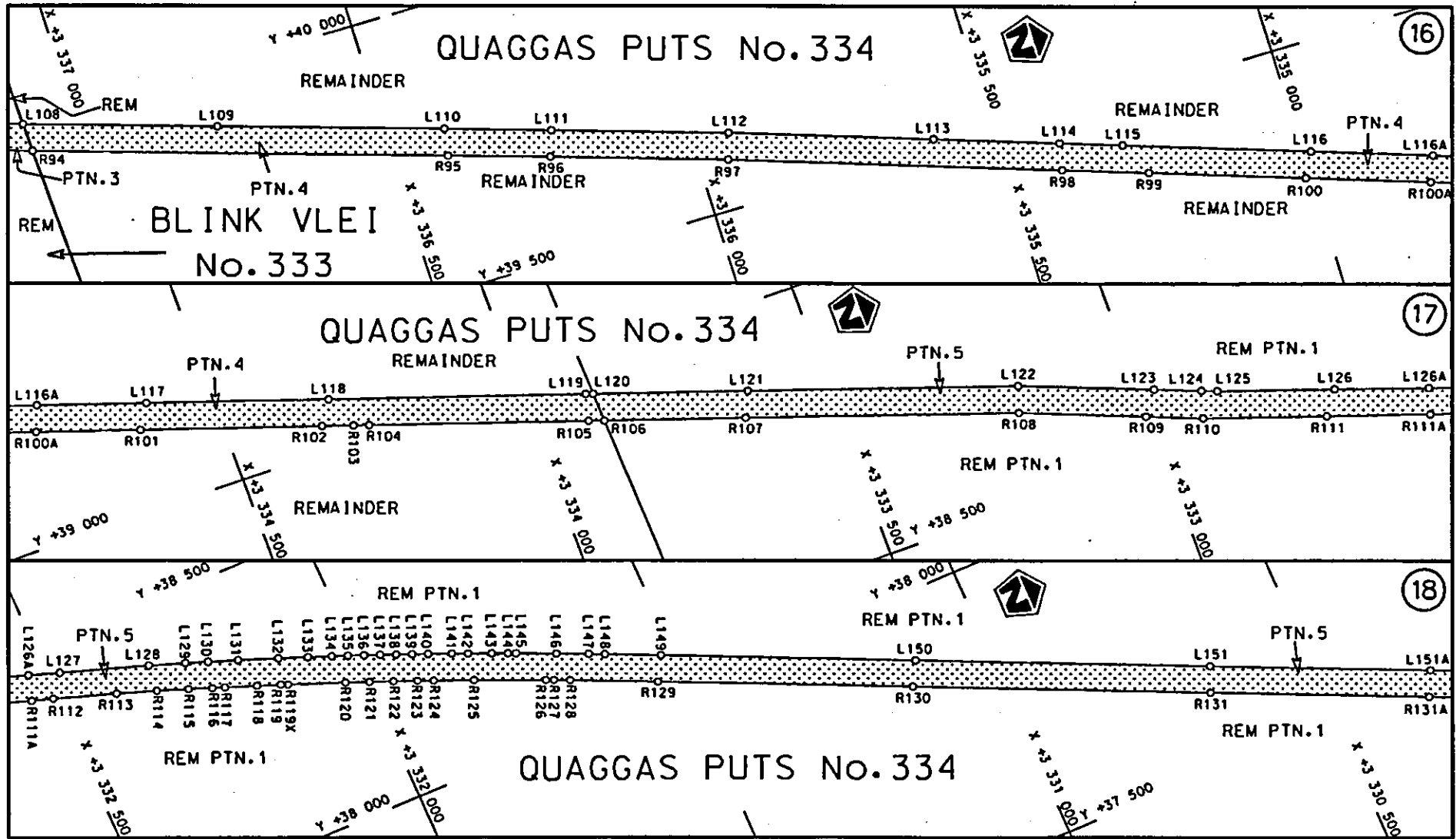

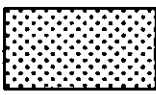
<p>Die Suid Afrikaanse Nasionale Padagentskap Beperk The South African National Roads Agency Limited</p>	<p>Die figuur getoon The figure shown</p>		<p>steldie padreserwe voor van 'n gedeelte represents the road reserve of a portion van Nasionale Roete of National Route</p> <p>R27 Seksie 10 Section</p>	<p>Vel von Sheet 6 of 30</p> <p>Plan P707/08</p>
--	---	--	--	---

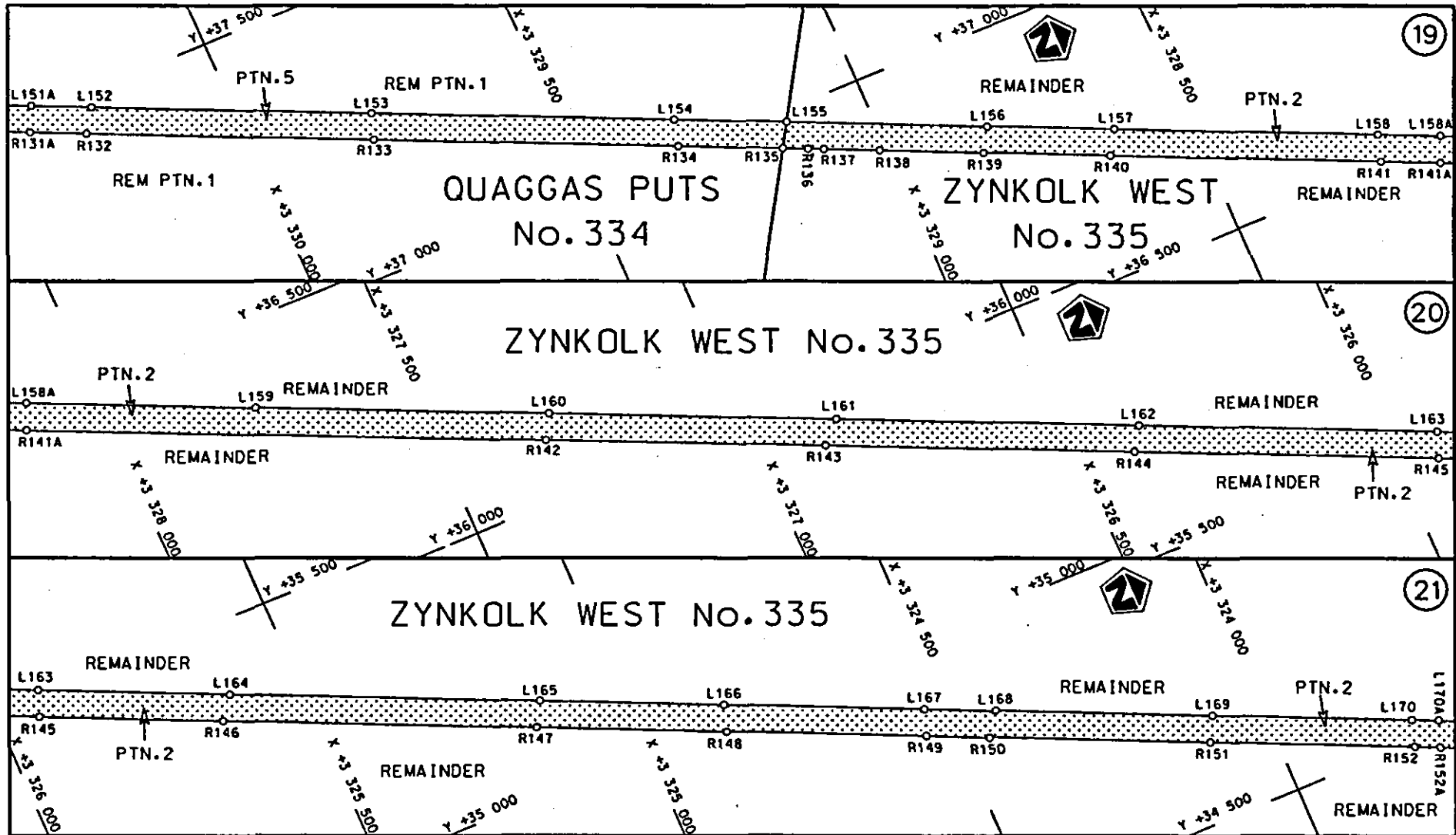

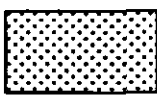
Die Suid Afrikaanse Nasionale Padagentskap Beperk The South African National Roads Agency Limited	Die figuur getoon The figure shown		stel die padreserwe voor van 'n gedeelte represents the road reserve of a portion von Nasionale Roete R27 Seksie 10	Vel Sheet 7 van of 30 Plan P707/08
--	---------------------------------------	--	---	---------------------------------------

STAATSKOERANT, 19 OKTOBER 2010
 No. 33639 11

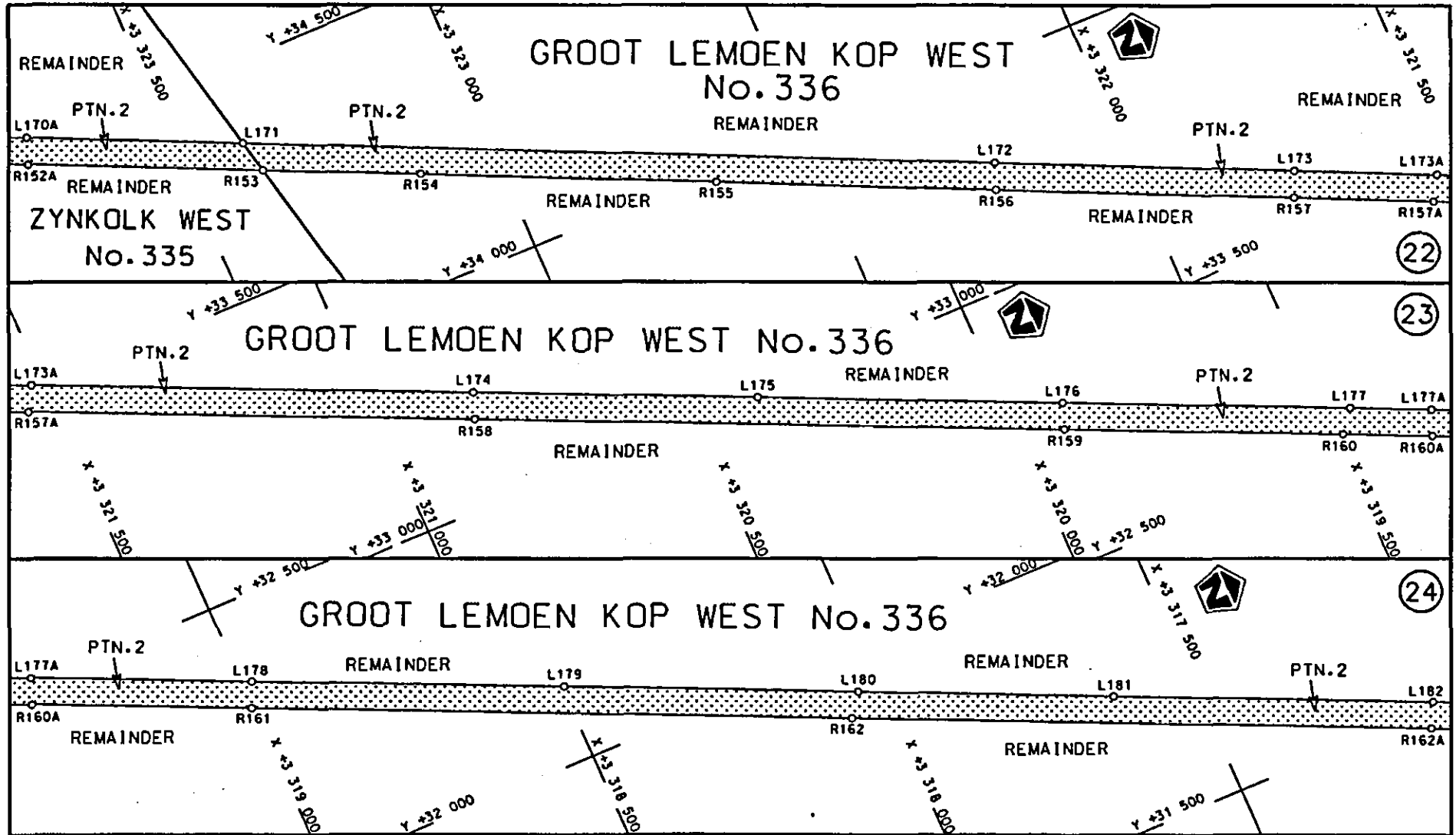

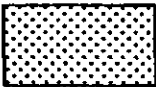
<p>Die Suid Afrikaanse Nasionale Padagentskap Beperk The South African National Roads Agency Limited</p>	<p>Die figuur getoon The figure shown</p> 	<p>stel die padreserwe voor van 'n gedeelte represents the road reserve of a portion van Nasionale Roete R27 Sektie 10 of National Route R27 Section 10</p>	<p>Vel Sheet 8 van 30 Plan P707/08</p>
--	--	---	--

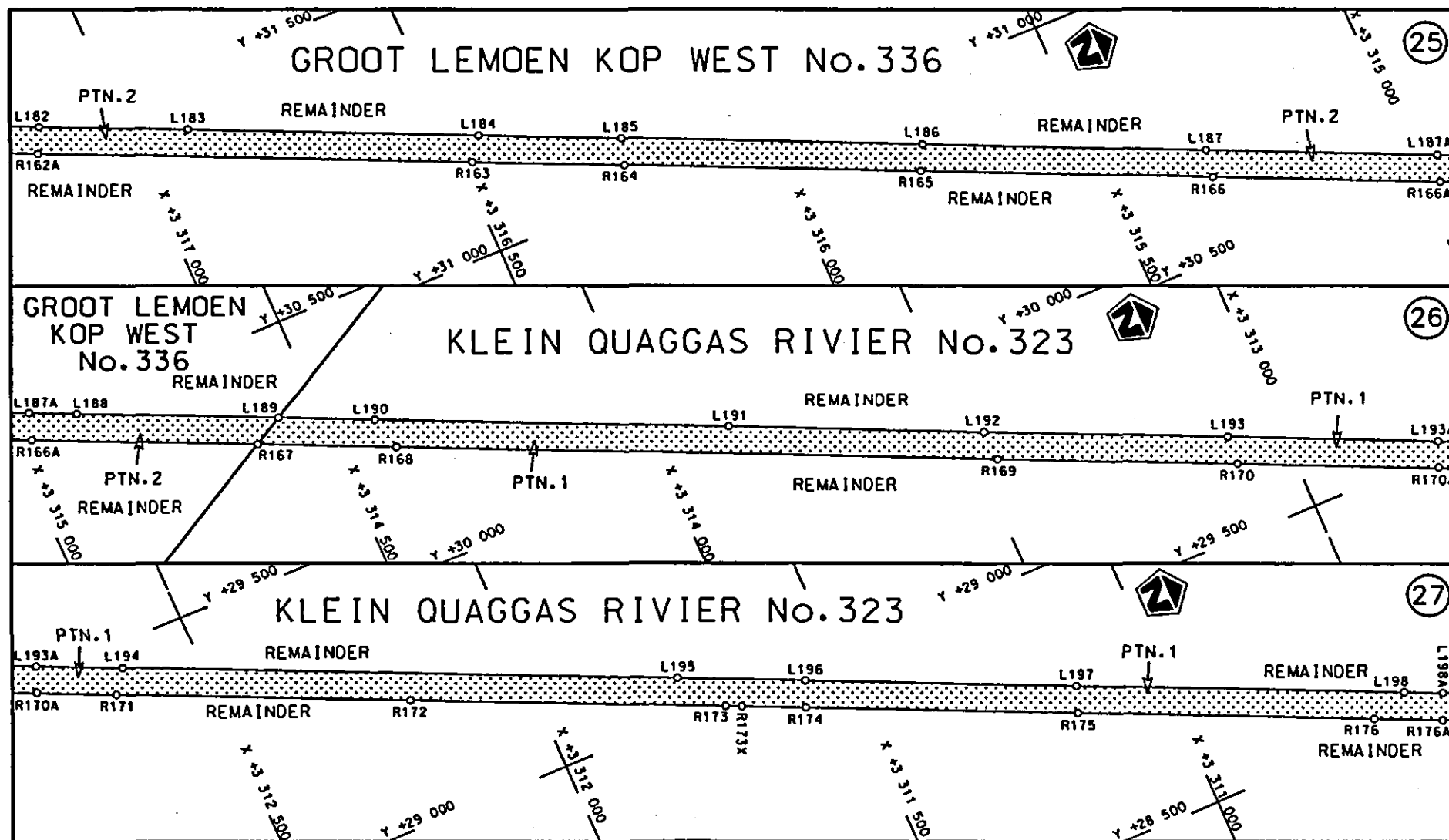

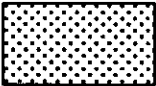
Die Suid Afrikaanse Nasionale Padagentskap Beperk The South African National Roads Agency Limited	Die figuur getoon The figure shown	 stel die padreserwe voor van 'n gedeelte represents the road reserve of a portion von Nasionale Roete R27 Sektie of National Route R27 Section	Vel Sheet 9 von of 30 Plan P707/08
10			10

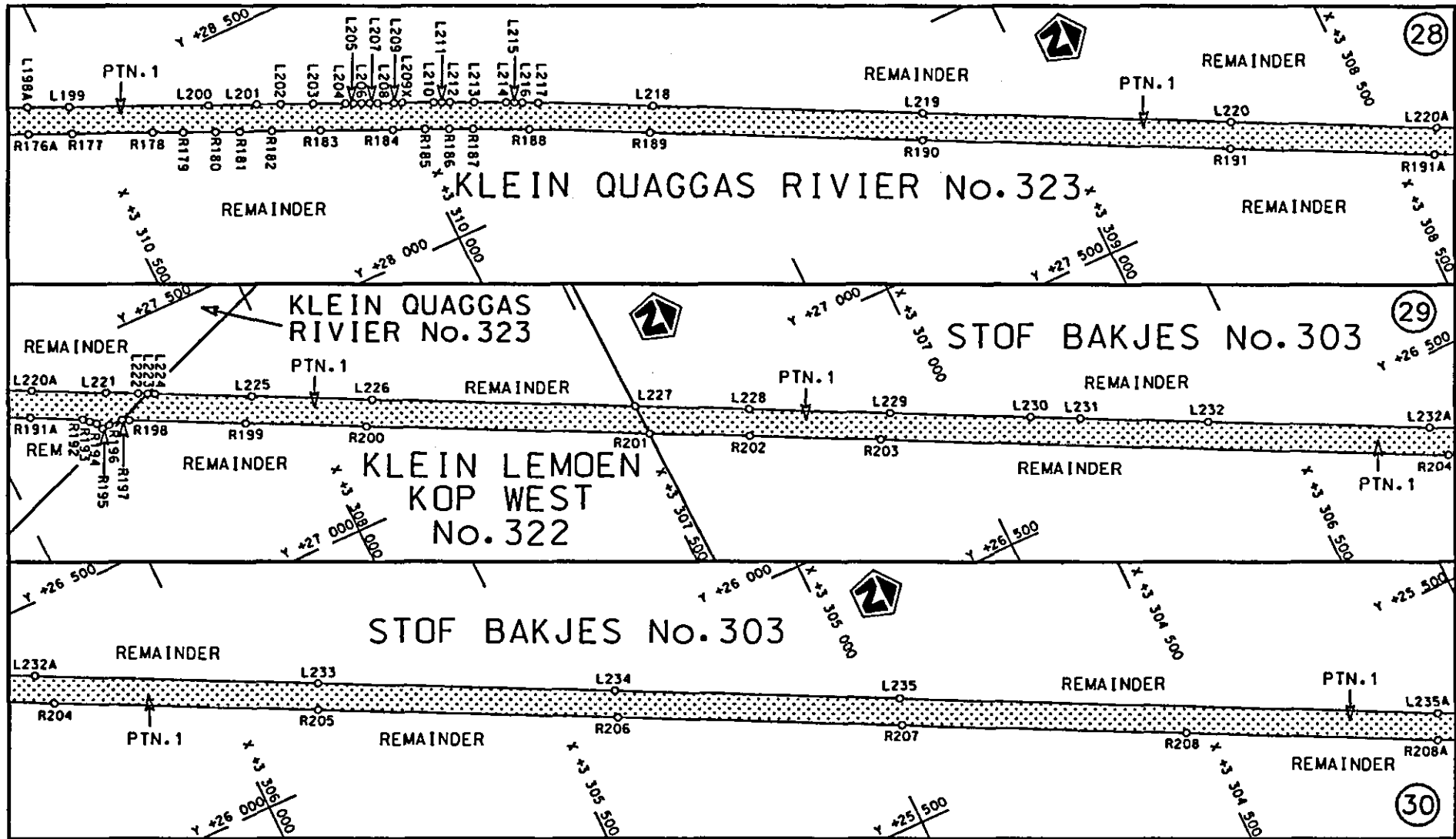

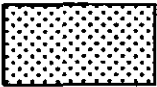
<p>Die Suid Afrikaanse Nasionale Padogenskap Beperk The South African National Roads Agency Limited</p>	<p>Die figuur getoon The figure shown</p> <div style="text-align: center;">  </div>	<p>steldie padreserwe voor van 'n gedeelte represents the road reserve of a portion van Nasionale Roete R27 Seksie of National Route Section 10</p>	<p>Vel Sheet 10 van 30 Plan P707/08</p>
---	---	---	---

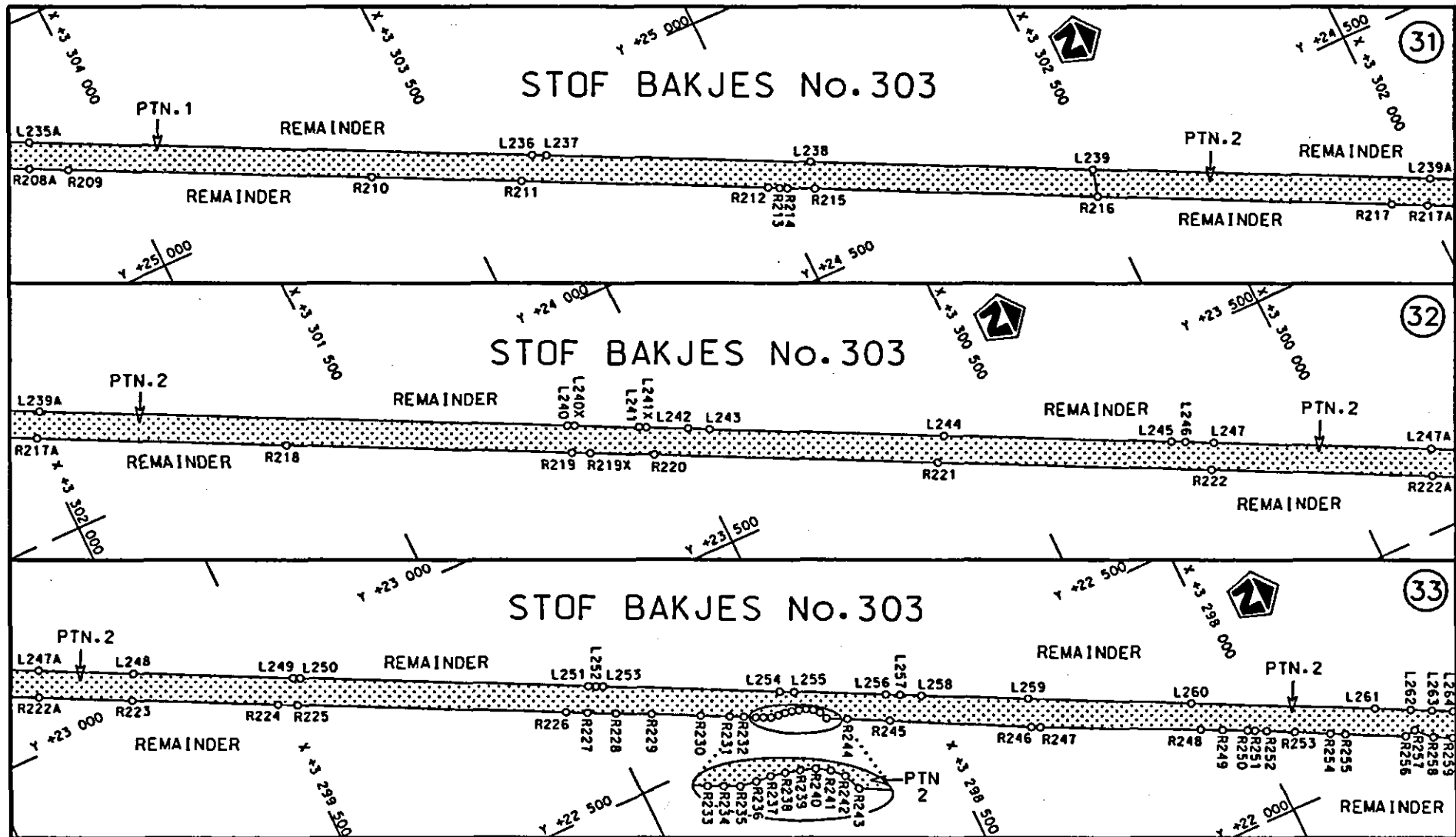

<p>Die Suid Afrikaanse Nasionale Padagentskap Beperk The South African National Roads Agency Limited</p>	<p>Die figuur getoon The figure shown</p>		<p>steldie padreserwe voor van 'n gedeelte represents the road reserve of a portion van Nasionale Roete R27 Seksie of National Route Section 10</p>	<p>Vel Sheet 11 van 30 Plan P707/08</p>
--	---	--	---	---

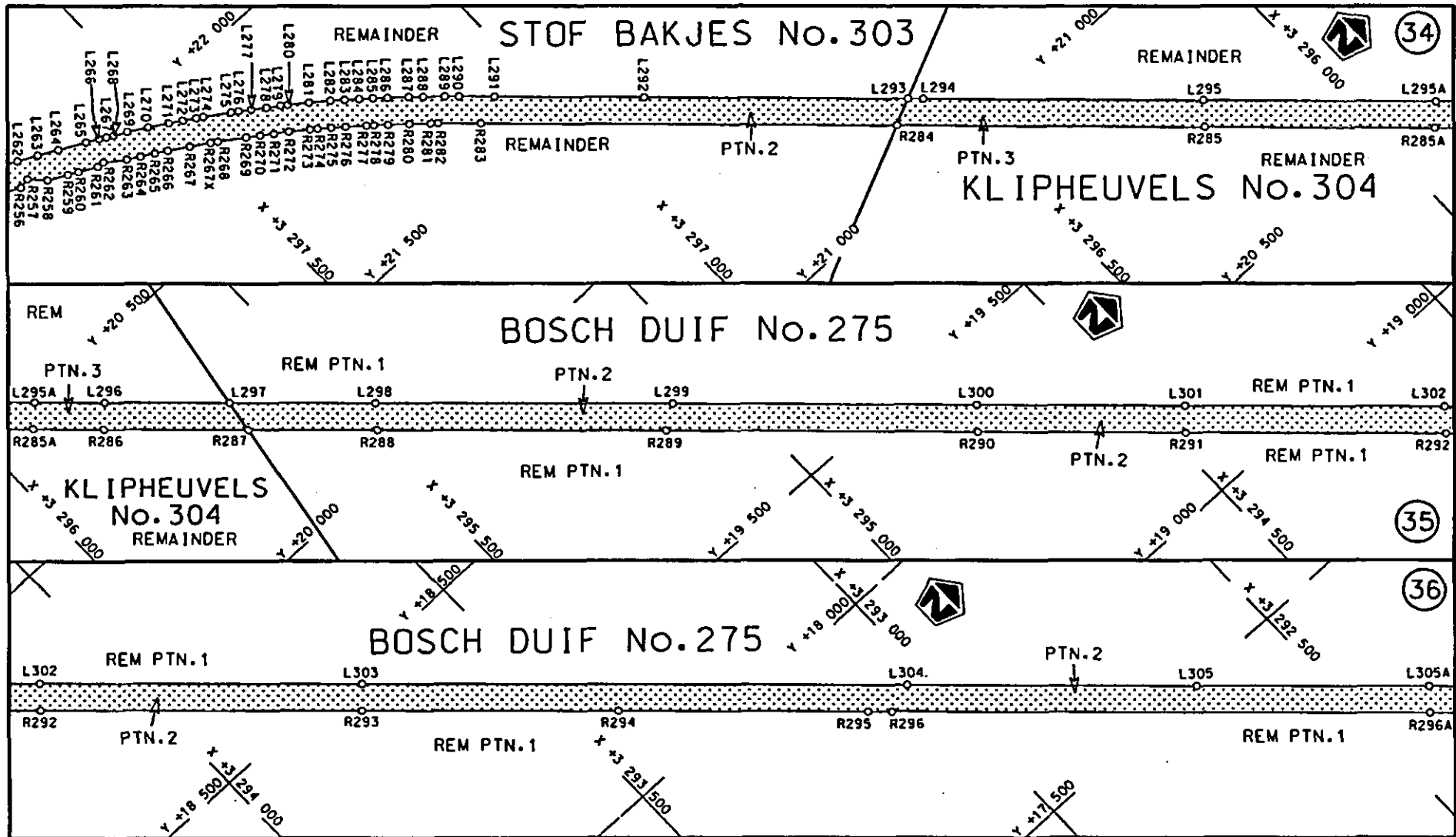

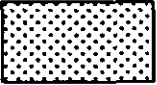
<p>Die Suid Afrikaanse Nasionale Padagentskap Beperk The South African National Roads Agency Limited</p>	<p>Die figuur getoon The figure shown</p>		<p>steldie padreserwe voor van 'n gedeelte represents the road reserve of a portion van Nasionale Roete R27 Sektie of National Route Section</p>	<p>10</p>	<p>Vel Sheet 12 van of 30</p>
					<p>Plan P707/08</p>

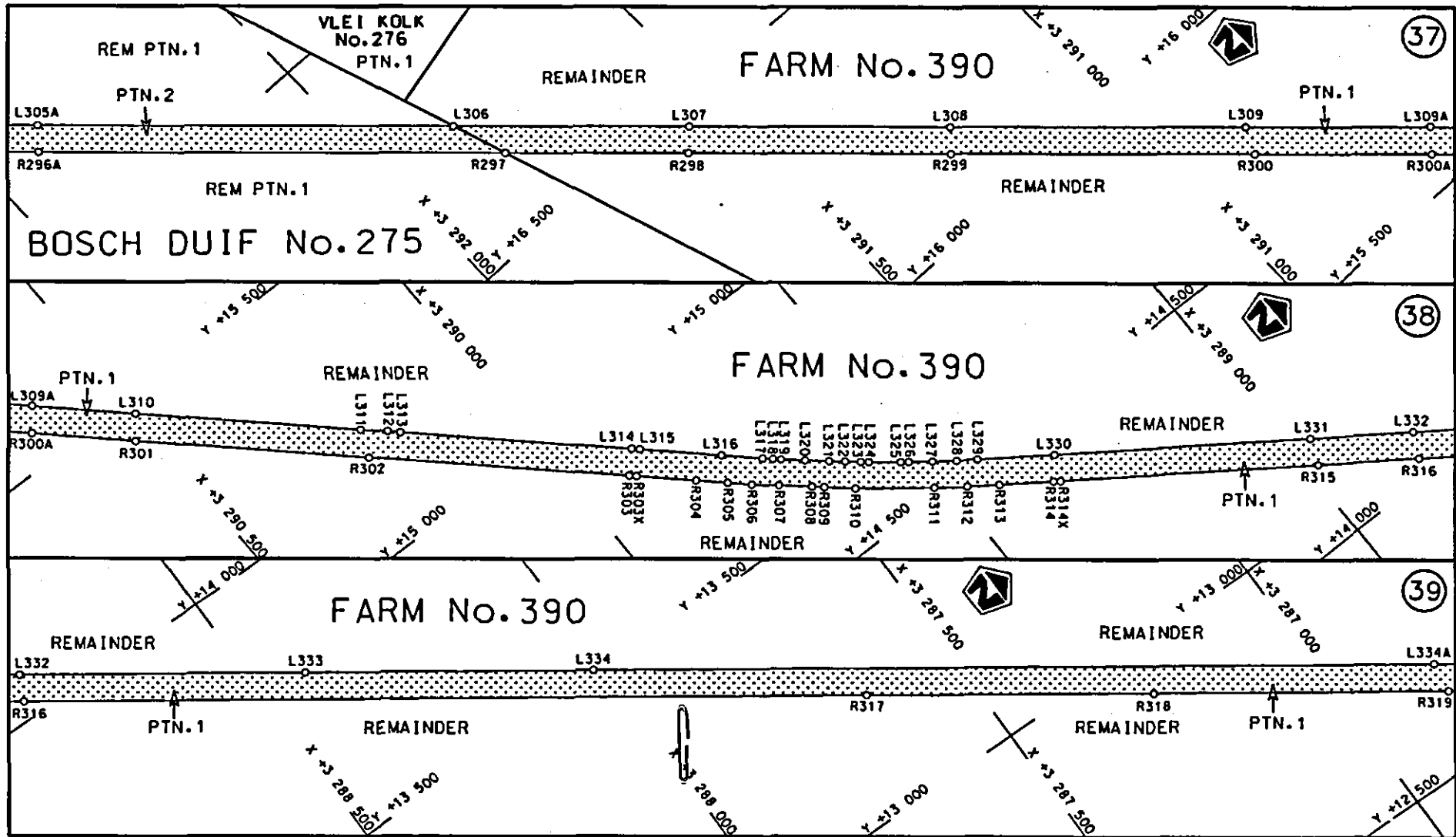

Die Suid Afrikaanse Nasionale Padogentskap Beperk
The South African National Roads Agency Limited

Die figuur getoon
The figure shown

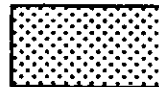

steldie padreserwe voor van 'n gedeelte
represents the road reserve of a portion
van Nasionale Roete R27 Sektie
of National Route Section

10

Vel
Sheet 13 of 30

Plan P707/08

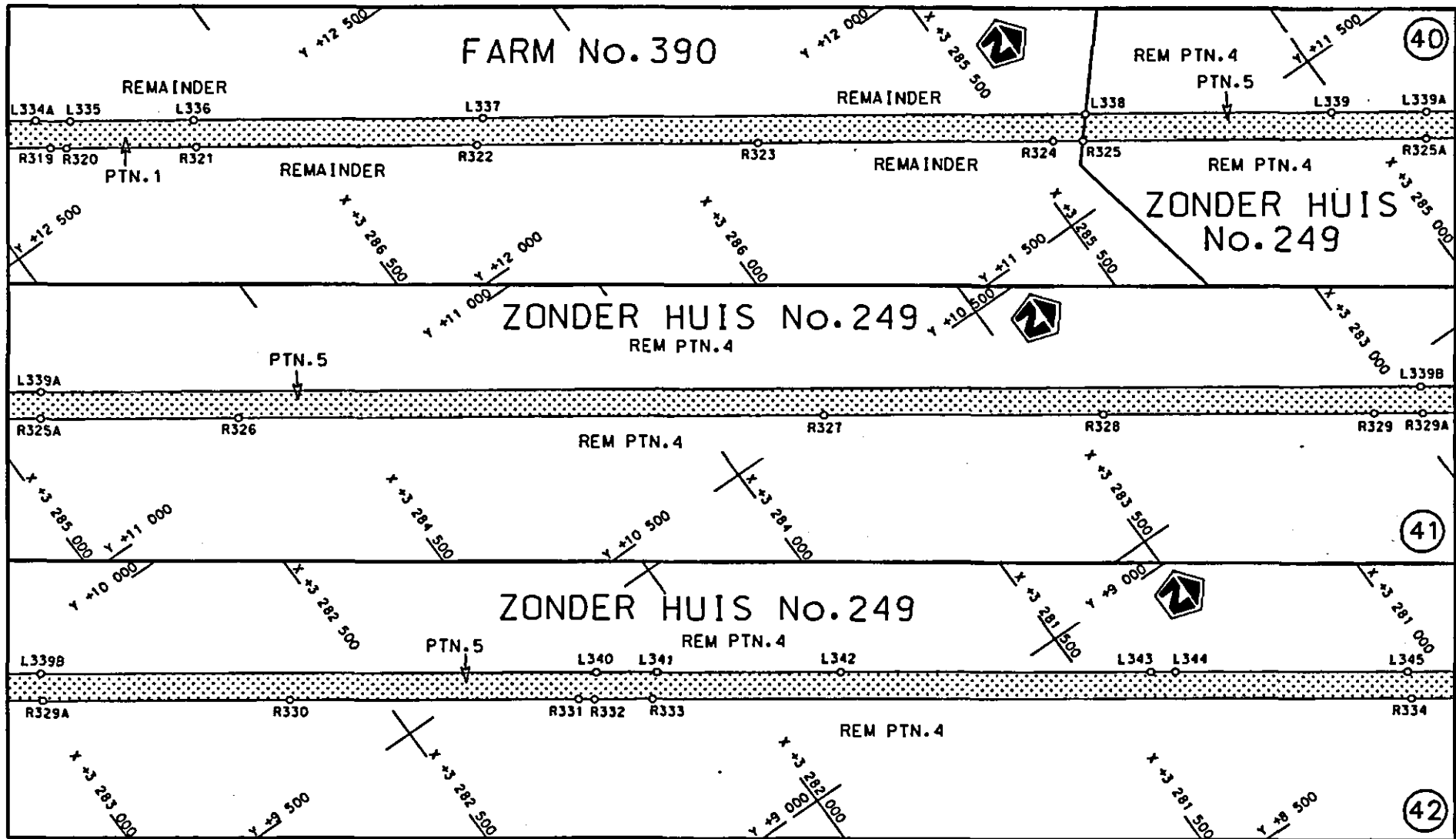

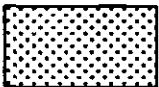
<p>Die Suid Afrikaanse Nasionale Padagentskap Beperk The South African National Roads Agency Limited</p>	<p>Die figuur getoon The figure shown</p>		<p>steldie padreserwe voor van 'n gedeelte represents the road reserve of a portion van Nasionale Raete R27 Seksie Section of National Route 10</p>	<p>Vel Sheet 14 van of 30 Plan P707/08</p>
--	---	--	---	--

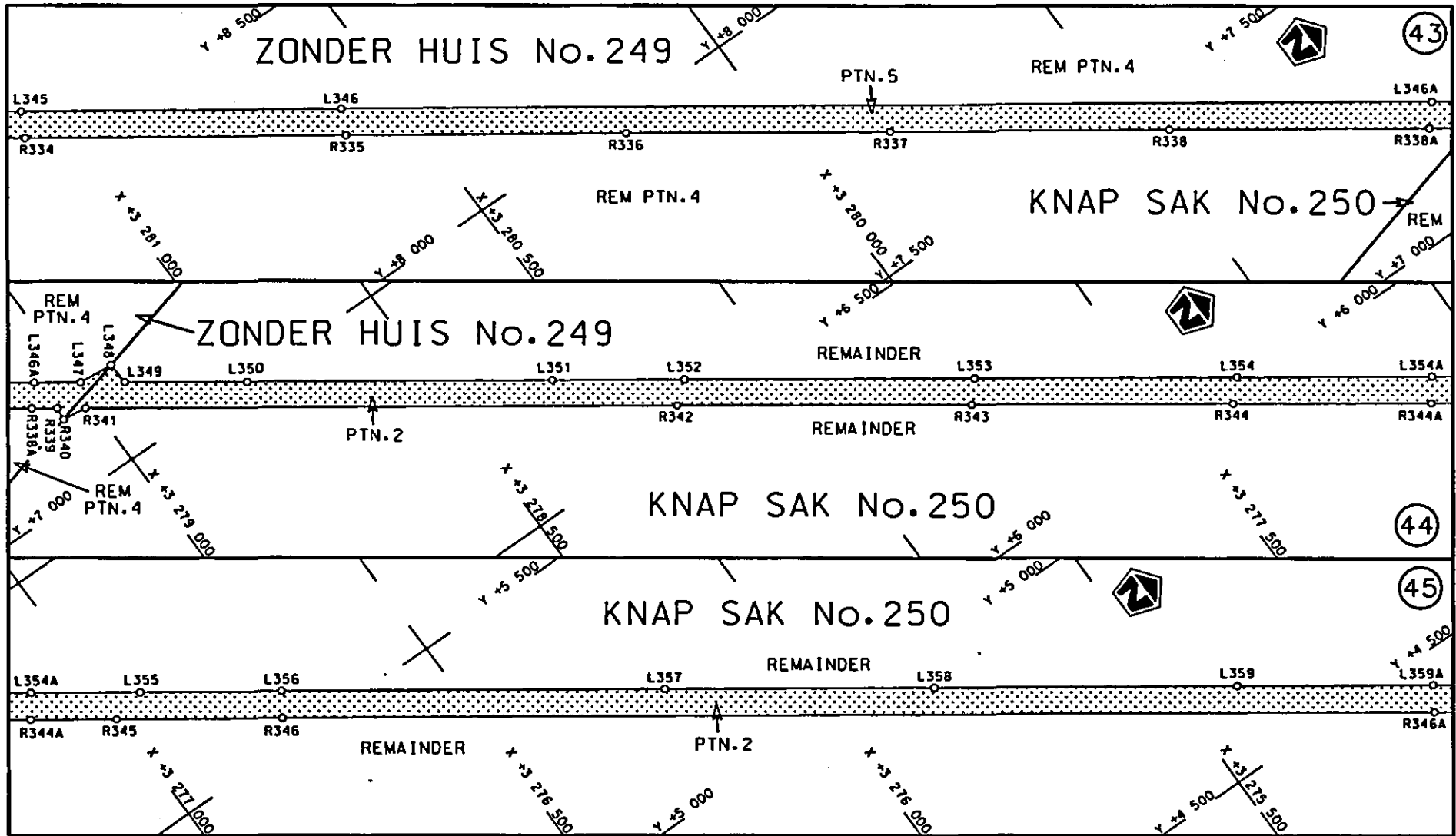

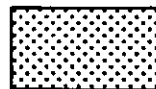
<p>Die Suid Afrikaanse Nasionale Padogenskap Beperk The South African National Roads Agency Limited</p>	<p>Die figuur getoon The figure shown</p>		<p>steldie padreserwe voor van 'n gedeelte represents the road reserve of a portion van Nasionale Roete R27 Seksie of National Route R27 Section</p>	<p>10</p>	<p>Vel Sheet 15 van of 30</p>
					<p>Plan P707/08</p>

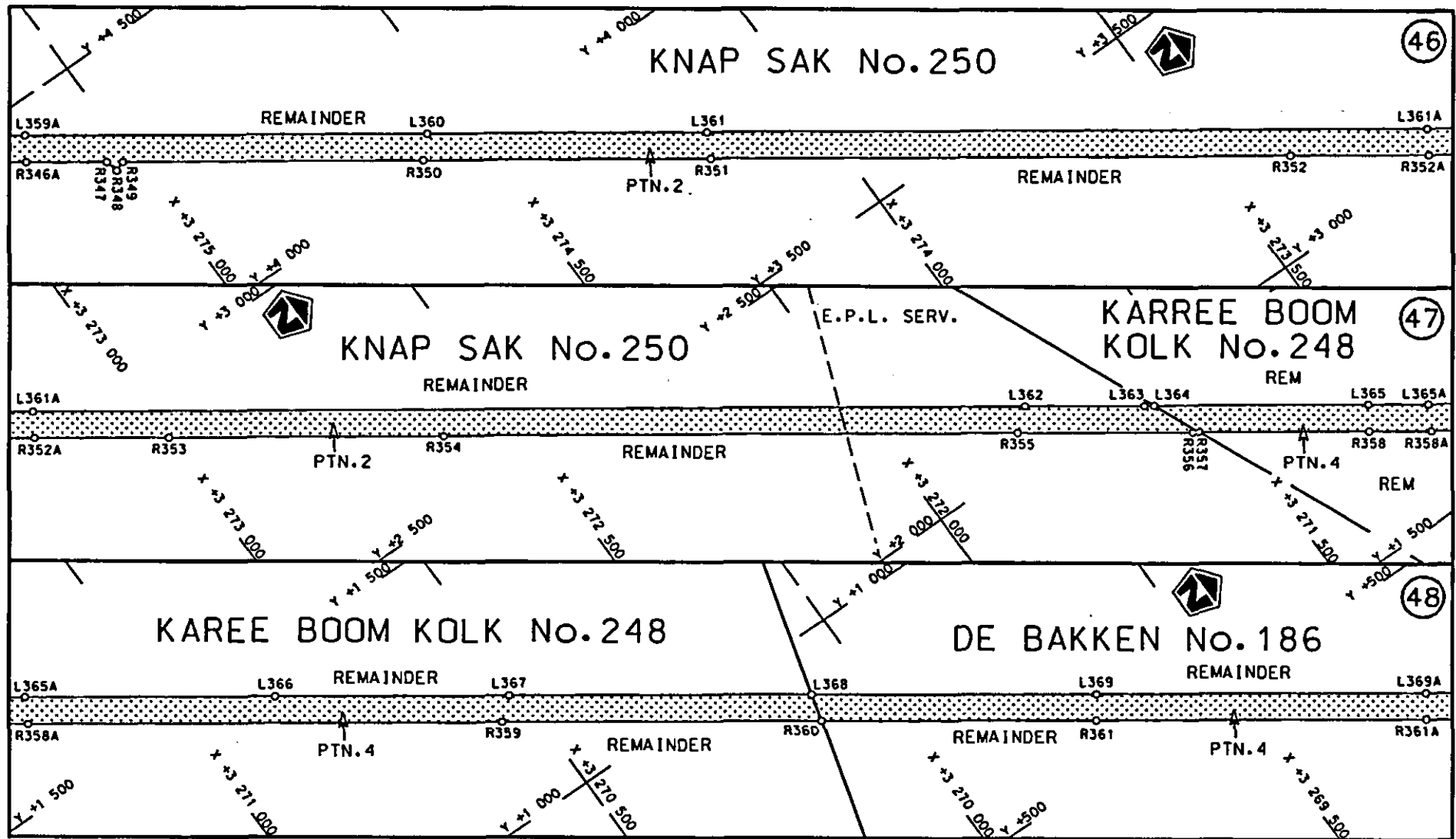

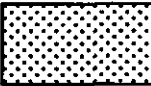
<p>Die Suid Afrikaanse Nasionale Padogenskap Beperk The South African National Roads Agency Limited</p>	<p>Die figuur getoon The figure shown</p>		<p>stel die padreserwe voor van 'n gedeelte represents the road reserve of a portion van Nasionale Roete R27 Seksie Section of National Route 10</p>	<p>Vel Sheet 16 van of 30 Plan P707/08</p>
---	---	--	--	--

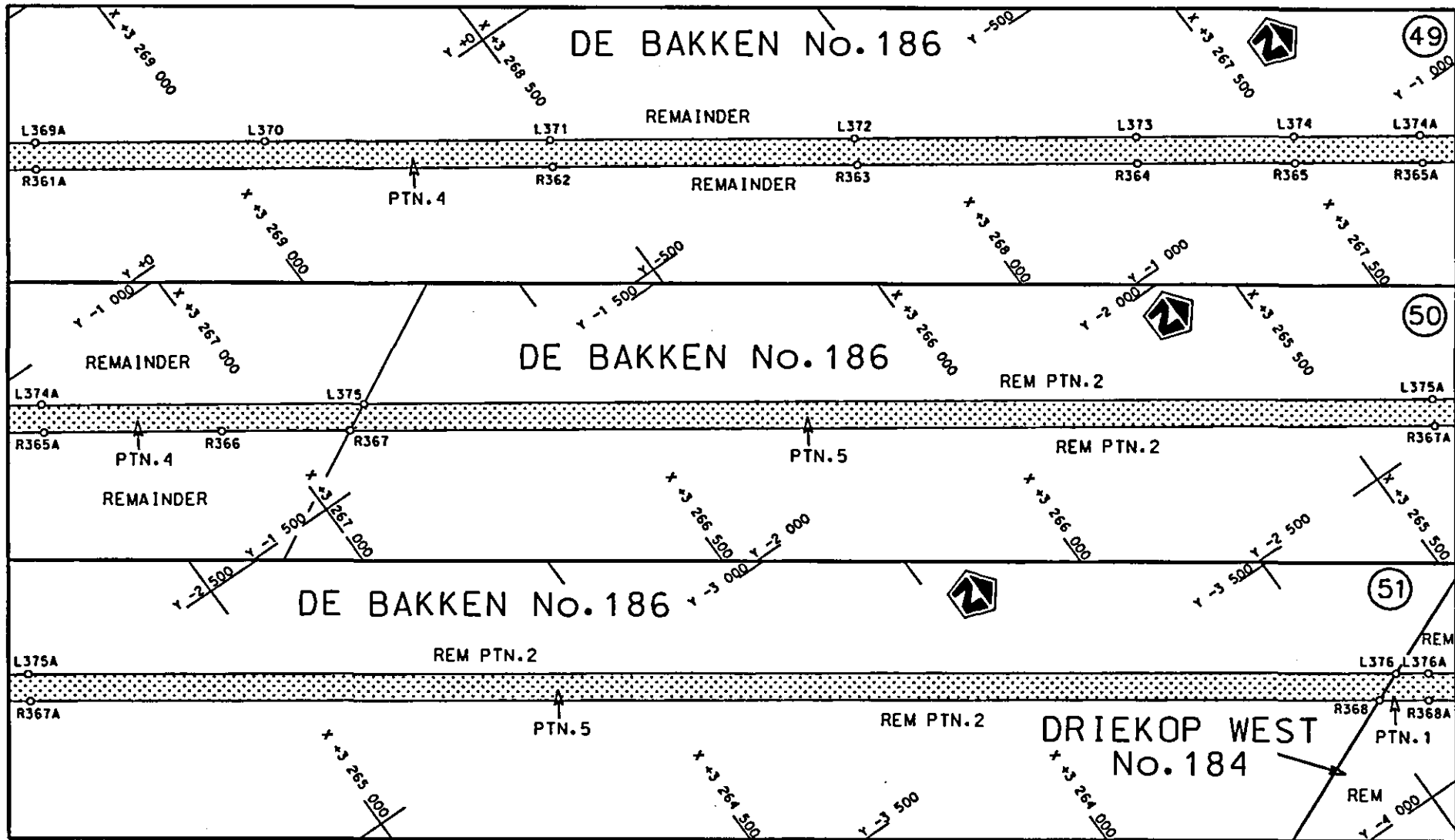

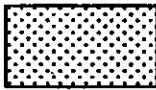
<p>Die Suid Afrikaanse Nasionale Padagentskap Beperk The South African National Roads Agency Limited</p>	<p>Die figuur getoon The figure shown</p>		<p>st die padreserwe voor van 'n gedeelte represents the road reserve of a portion van Nasionale Roete of National Route</p>	<p>R27 Seksie Section 10</p>	<p>Vel Sheet 17 van of 30</p>	<p>Plan P707/08</p>
--	---	--	--	------------------------------	-------------------------------	---------------------

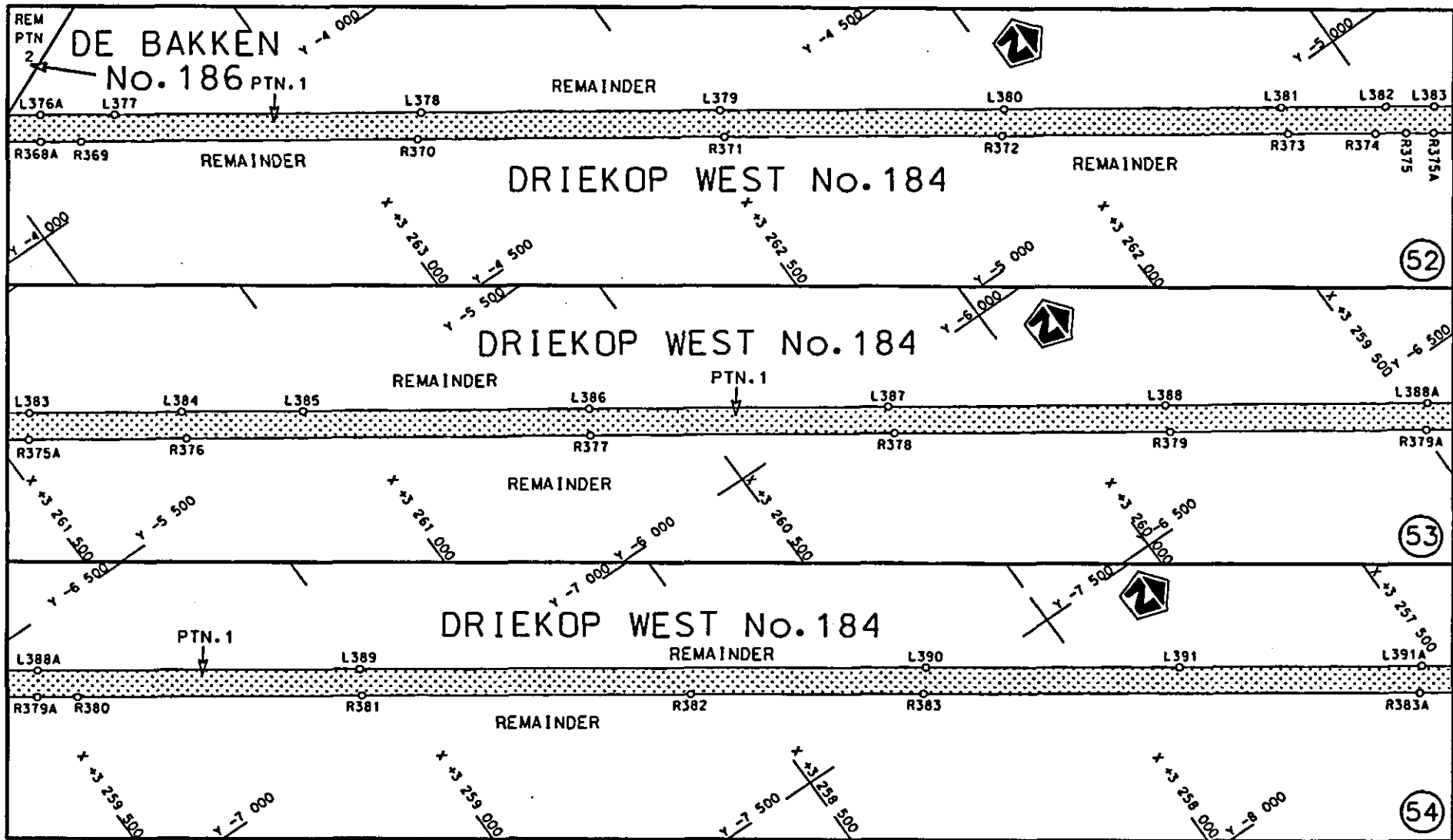

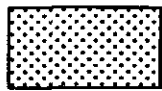
<p>Die Suid Afrikaanse Nasionale Padagentskap Beperk The South African National Roads Agency Limited</p>	<p>Die figuur getoon The figure shown</p>		<p>steldie padreserwe voor van 'n gedeelte represents the road reserve of a portion van Nasionale Roete of National Route R27 Seksie Section 10</p>	<p>Vel Sheet 18 van of 30 Plan P707/08</p>
--	---	--	---	--

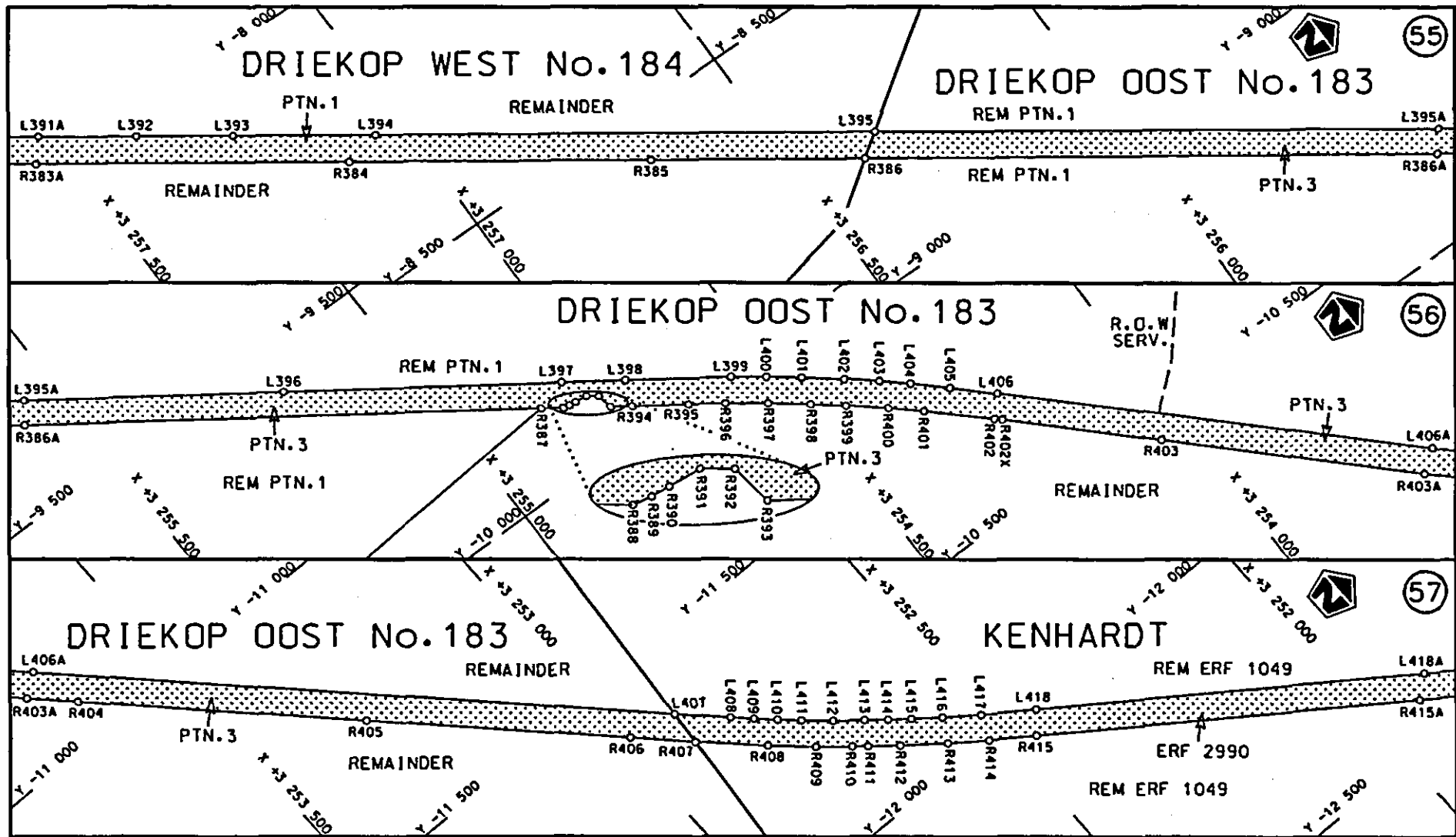

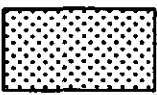
<p>Die Suid Afrikaanse Nasionale Padagentskap Beperk The South African National Roads Agency Limited</p>	<p>Die figuur getoon The figure shown</p> 	<p>steldie padreserwe voor van 'n gedeelte represents the road reserve of a portion van Nasionale Roete R27 Seksie of National Route Section 10</p>	<p>Vel Sheet 19 van 30 Plan P707/08</p>
--	--	---	---

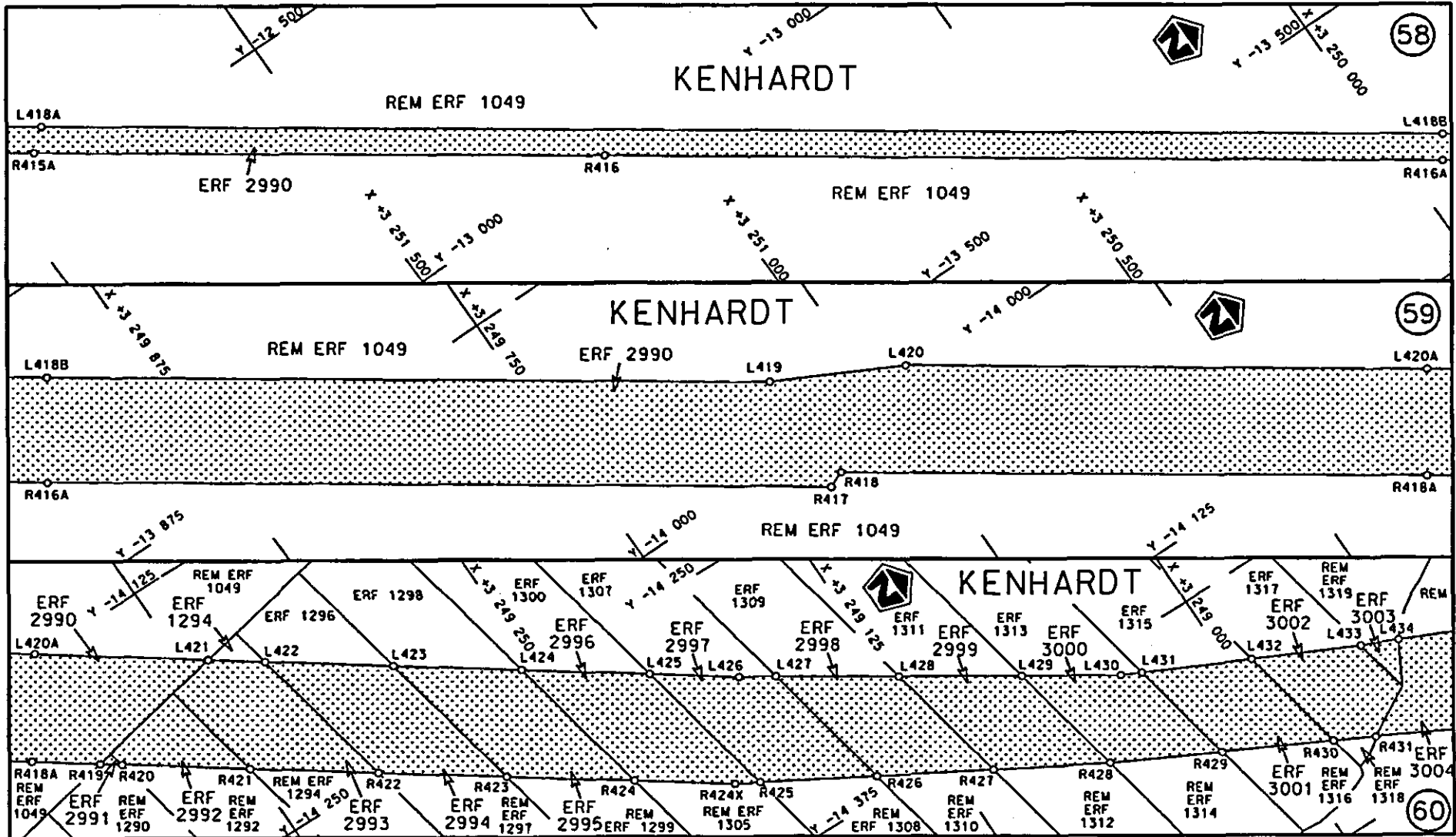

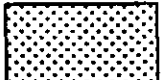
<p>Die Suid Afrikaanse Nasionale Padagentskap Beperk The South African National Roads Agency Limited</p>	<p>Die figuur getoon The figure shown</p>		<p>steldie padreserwe voor van 'n gedeelte represents the road reserve of a portion van Nasionale Roete R27 Seksie 10 of National Route R27 Section 10</p>	<p>Vel Sheet 20 van 30 Plan P707/08</p>
--	---	--	--	---

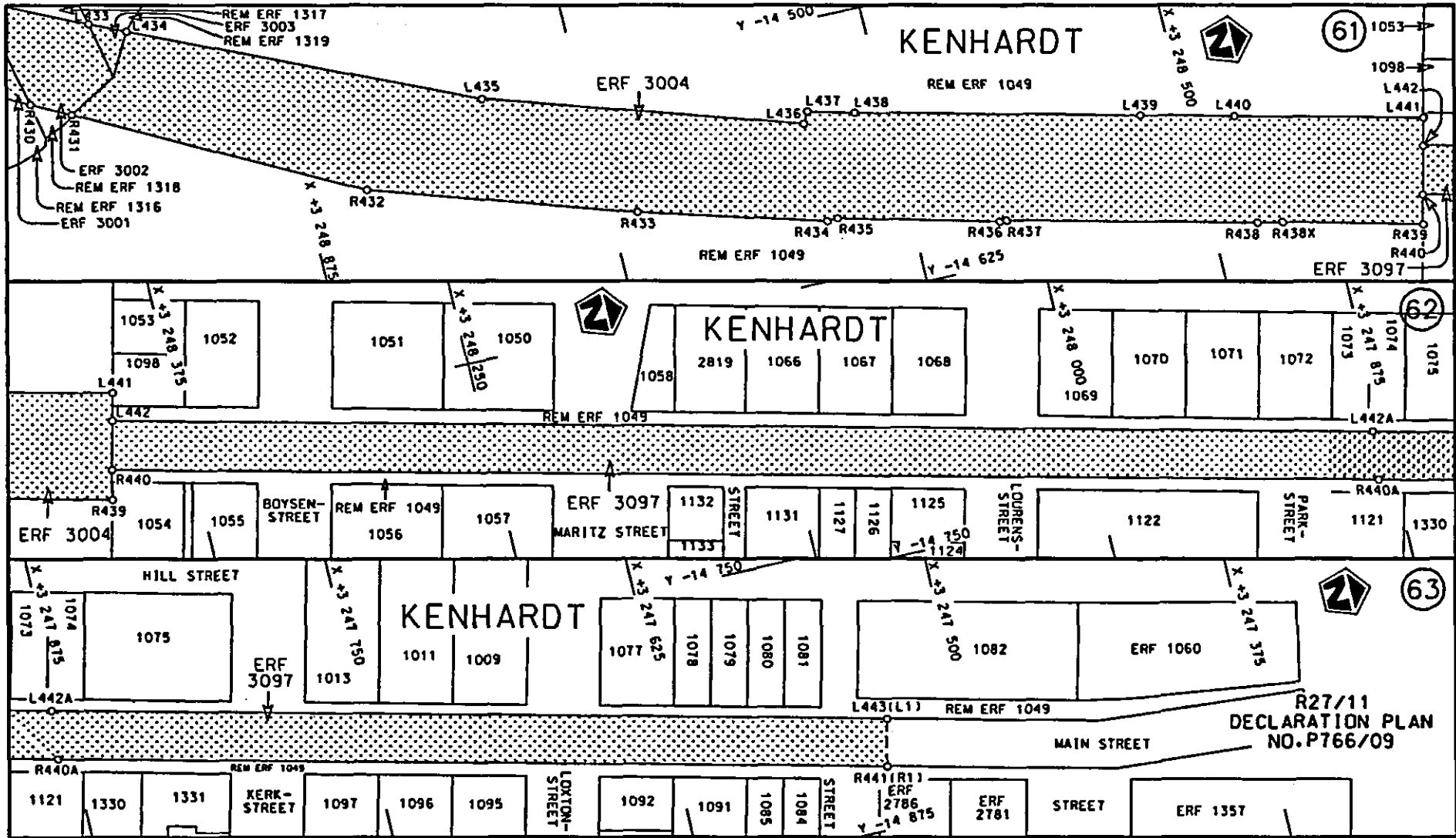

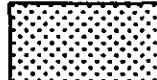
Die Suid Afrikaanse Nasionale Padogenskops Beperk The South African National Roads Agency Limited	Die figuur getoon The figure shown	 steldie padreserwe voor van 'n gedeelte represents the road reserve of a portion van Nasionale Roete R27 Seksie 10 of National Route R27 Section 10	Vel Sheet 21 of 30 Plan P707/08
--	---------------------------------------	---	------------------------------------

PADRESERWE KOÖRDINATE / ROAD RESERVE CO-ORDINATES						
LINKERKANT/LEFT HAND SIDE				REGTERKANT/RIGHT HAND SIDE		
	Y	X	WG 21°		Y	X
L1	50 069.640	3 371	733.340	R1	50 052.780	3 371 729.770
L2	50 127.820	3 371	458.180	R2	50 111.010	3 371 454.610
L3	50 133.480	3 371	459.380	R3	50 101.400	3 371 452.580
L4	50 136.770	3 371	442.590	R4	50 139.400	3 371 274.780
L5	50 170.440	3 371	279.970	R5	50 149.680	3 371 215.080
L6	50 180.880	3 371	219.380	R6	50 157.830	3 371 155.760
L7	50 189.210	3 371	159.100	R7	50 163.950	3 371 095.470
L8	50 195.330	3 371	098.520	R8	50 167.860	3 371 035.430
L9	50 199.370	3 371	034.030	R9	50 169.720	3 370 974.850
L10	50 199.600	3 371	027.920	R10	50 169.540	3 370 914.290
L11	50 201.210	3 370	975.330	R11	50 167.220	3 370 853.880
L12	50 201.190	3 370	961.500	R12	50 162.750	3 370 793.750
L13	50 200.940	3 370	913.170	R13	50 156.220	3 370 733.730
L14	50 198.570	3 370	851.580	R14	50 147.700	3 370 674.190
L15	50 193.840	3 370	789.220	R15	50 136.830	3 370 614.780
L16	50 187.270	3 370	728.500	R16	50 124.000	3 370 555.050
L17	50 178.880	3 370	669.510	R17	50 108.490	3 370 494.360
L18	50 167.490	3 370	607.650	R18	50 086.310	3 370 413.290
L19	50 154.510	3 370	547.160	R19	49 836.890	3 369 502.040
L20	50 138.990	3 370	486.310	R20	49 818.360	3 369 434.430
L21	50 105.440	3 370	363.240	R21	49 675.010	3 368 910.290
L22	50 003.130	3 369	989.630	R22	49 586.200	3 368 585.720
L23	49 996.760	3 369	966.200	R23	49 449.250	3 368 085.740
L24	49 864.320	3 369	482.840	R24	49 385.540	3 367 852.900
L25	49 845.520	3 369	414.260	R25	49 313.060	3 367 587.880
L26	49 708.170	3 368	912.100	R26	49 264.370	3 367 409.870
L27	49 616.790	3 368	578.360	R27	49 130.580	3 366 921.210
L28	49 416.190	3 367	845.290	R28	48 999.120	3 366 440.550
L29	49 344.240	3 367	582.440	R29	48 864.330	3 365 948.120
L30	49 293.050	3 367	395.470	R30	48 781.650	3 365 645.870
L31	49 160.500	3 366	911.600	R31	48 693.180	3 365 322.550
L32	49 030.260	3 366	435.490	R32	48 422.700	3 364 333.440
L33	48 893.250	3 365	934.820	R33	48 344.990	3 364 049.240
L34	48 810.610	3 365	632.710	R34	48 241.480	3 363 670.890
L35	48 720.440	3 365	303.530	R35	48 106.620	3 363 178.500
L36	48 581.380	3 364	794.750	R36	48 051.520	3 362 977.090
L37	48 490.400	3 364	462.090	R37	47 979.000	3 362 712.020
L38	48 454.670	3 364	331.430	R38	47 846.560	3 362 228.290
L39	48 377.890	3 364	050.620	R39	47 736.010	3 361 823.940
L40	48 274.930	3 363	674.850	R40	47 604.820	3 361 344.450
L41	48 269.700	3 363	655.680	R41	47 540.380	3 361 119.380
L42	48 137.160	3 363	171.810	R42	47 486.730	3 360 944.940
L43	48 080.210	3 362	963.280	R43	47 334.220	3 360 462.310
L44	48 008.320	3 362	700.070	R44	47 253.030	3 360 205.640
L45	47 877.070	3 362	220.810	R45	47 101.120	3 359 725.000
L46	47 765.640	3 361	813.620	R46	46 950.480	3 359 247.950
L47	47 681.120	3 361	504.630	R47	46 798.630	3 358 767.720
L48	47 634.980	3 361	336.030	R48	46 654.620	3 358 311.460
L49	47 571.100	3 361	112.230	R49	46 555.180	3 357 996.980
L50	47 516.820	3 360	935.610	R50	46 408.150	3 357 531.220
L51	47 367.670	3 360	463.750	R51	46 265.890	3 357 081.200

Vel	22	Van	30	P707/08
Sheet		of		

PADRESERWE KOÖRDINATE / ROAD RESERVE CO-ORDINATES					
LINKERKANT/LEFT HAND SIDE			REGTERKANT/RIGHT HAND SIDE		
	Y	X	WG 21°		X
L52	47 359.470	3 360	437.670	R52	46 134.300 3 356 665.320
L53	47 284.970	3 360	201.940	R53	45 997.480 3 356 231.980
L54	46 981.010	3 359	240.430	R54	45 833.750 3 355 713.690
L55	46 688.380	3 358	313.990	R55	45 743.940 3 355 429.260
L56	46 588.970	3 357	999.110	R56	45 551.670 3 354 821.130
L57	46 583.700	3 357	982.560	R57	45 432.070 3 354 442.690
L58	46 442.590	3 357	535.770	R58	45 284.300 3 353 975.080
L59	46 297.900	3 357	078.120	R59	45 166.100 3 353 600.650
L60	46 164.620	3 356	656.070	R60	45 005.530 3 353 092.740
L61	46 027.110	3 356	221.180	R61	44 931.500 3 352 858.520
L62	45 863.740	3 355	704.150	R62	44 859.360 3 352 630.260
L63	45 768.150	3 355	401.520	R63	44 731.640 3 352 225.880
L64	45 606.560	3 354	890.440	R64	44 572.730 3 351 723.190
L65	45 543.190	3 354	689.880	R65	44 429.370 3 351 269.150
L66	45 459.500	3 354	425.020	R66	44 319.210 3 350 920.500
L67	45 315.200	3 353	967.830	R67	44 160.190 3 350 417.530
L68	45 199.640	3 353	602.280	R68	43 904.330 3 349 607.700
L69	44 964.370	3 352	857.600	R69	43 754.940 3 349 135.050
L70	44 889.600	3 352	620.920	R70	43 596.910 3 348 635.180
L71	44 761.200	3 352	214.950	R71	43 455.130 3 348 186.360
L72	44 612.620	3 351	744.810	R72	43 302.740 3 347 704.970
L73	44 600.360	3 351	706.350	R73	43 256.850 3 347 558.980
L74	44 460.260	3 351	262.670	R74	43 105.060 3 347 078.450
L75	44 353.030	3 350	922.990	R75	42 985.550 3 346 700.540
L76	44 190.450	3 350	408.800	R76	42 853.880 3 346 283.940
L77	44 048.710	3 349	960.180	R77	42 710.560 3 345 829.710
L78	43 784.090	3 349	123.030	R78	42 689.670 3 345 763.650
L79	43 630.710	3 348	637.520	R79	42 561.330 3 345 357.420
L80	43 330.510	3 347	687.670	R80	42 409.000 3 344 875.670
L81	43 289.490	3 347	557.760	R81	42 261.430 3 344 408.230
L82	43 137.360	3 347	076.320	R82	42 094.470 3 343 879.860
L83	43 038.190	3 346	762.010	R83	41 939.370 3 343 388.720
L84	43 022.170	3 346	711.260	R84	41 892.370 3 343 240.420
L85	42 884.550	3 346	275.460	R85	41 732.580 3 342 734.620
L86	42 741.130	3 345	822.120	R86	41 580.290 3 342 252.650
L87	42 725.200	3 345	772.010	R87	41 279.390 3 341 300.070
L88	42 596.190	3 345	363.220	R88	41 131.350 3 340 831.520
L89	42 437.080	3 344	859.760	R89	41 096.930 3 340 722.380
L90	42 119.290	3 343	853.610	R90	40 939.870 3 340 225.470
L91	41 969.810	3 343	380.500	R91	40 694.670 3 339 449.170
L92	41 920.630	3 343	225.170	R92	40 572.320 3 339 063.560
L92X	41 934.590	3 343	217.290	R93	39 999.970 3 337 250.920
L93	41 934.400	3 343	216.650	R94	39 947.800 3 337 085.860
L94	41 920.450	3 343	172.050	R95	39 733.700 3 336 408.430
L95	41 918.160	3 343	165.140	R96	39 680.700 3 336 240.490
L96	41 775.450	3 342	713.600	R97	39 587.500 3 335 950.460
L97	41 325.530	3 341	289.600	R98	39 403.840 3 335 405.970
L98	41 144.380	3 340	716.490	R99	39 356.140 3 335 264.420
L99	40 983.170	3 340	206.100	R100	39 269.460 3 335 008.790
L100	40 890.810	3 339	913.470	R101	39 143.070 3 334 635.110
L101	40 746.920	3 339	458.080	R102	39 043.710 3 334 340.600

Vel
Sheet

23

Van
of

30

P707/08

PADRESERWE KOÖRDINATE / ROAD RESERVE CO-ORDINATES						
LINKERKANT/LEFT HAND SIDE				REGTERKANT/RIGHT HAND SIDE		
	Y	X	WG 21°		Y	X
L102	40 633.130	3 339	098.810	R103	39 026.490	3 334 289.810
L103	40 627.470	3 339	080.140	R104	39 017.920	3 334 264.530
L104	40 621.700	3 339	061.700	R105	38 897.180	3 333 907.730
L105	40 488.110	3 338	639.120	R106	38 888.490	3 333 882.320
L106	40 186.850	3 337	685.550	R107	38 810.960	3 333 652.920
L107	40 048.460	3 337	247.340	R108	38 660.430	3 333 207.570
L108	39 998.060	3 337	088.110	R109	38 580.070	3 333 003.810
L109	39 897.480	3 336	770.350	R110	38 544.100	3 332 912.340
L110	39 780.710	3 336	400.570	R111	38 475.560	3 332 710.690
L111	39 724.830	3 336	225.650	R112	38 406.930	3 332 506.420
L112	39 632.450	3 335	935.950	R113	38 371.850	3 332 403.010
L113	39 519.680	3 335	601.600	R114	38 349.310	3 332 338.030
L114	39 450.380	3 335	396.300	R115	38 330.420	3 332 286.860
L115	39 415.560	3 335	293.460	R116	38 315.950	3 332 248.600
L116	39 311.710	3 334	986.570	R117	38 308.560	3 332 228.690
L117	39 184.230	3 334	609.440	R118	38 289.380	3 332 177.200
L118	39 084.410	3 334	314.250	R119	38 275.100	3 332 138.890
L119	38 941.620	3 333	891.630	R119X	38 271.320	3 332 129.250
L120	38 939.320	3 333	884.420	R120	38 234.710	3 332 036.070
L121	38 854.230	3 333	633.450	R121	38 219.550	3 331 998.150
L122	38 705.230	3 333	192.660	R122	38 204.300	3 331 959.980
L123	38 620.690	3 332	975.060	R123	38 188.750	3 331 921.870
L124	38 590.850	3 332	898.610	R124	38 178.060	3 331 896.360
L125	38 581.070	3 332	873.210	R125	38 151.140	3 331 832.260
L126	38 515.880	3 332	681.970	R126	38 102.700	3 331 719.180
L127	38 445.490	3 332	477.470	R127	38 097.120	3 331 706.480
L128	38 396.650	3 332	332.740	R128	38 085.690	3 331 681.010
L129	38 375.450	3 332	273.350	R129	38 023.640	3 331 544.470
L130	38 362.040	3 332	236.650	R130	37 841.810	3 331 145.020
L131	38 344.190	3 332	188.450	R131	37 629.610	3 330 679.220
L132	38 319.960	3 332	124.350	R132	37 433.250	3 330 247.760
L133	38 301.560	3 332	076.830	R133	37 229.790	3 329 800.960
L134	38 286.870	3 332	038.910	R134	37 013.770	3 329 327.000
L135	38 276.810	3 332	013.270	R135	36 939.410	3 329 163.640
L136	38 266.590	3 331	987.630	R136	36 921.650	3 329 124.340
L137	38 256.360	3 331	962.180	R137	36 910.350	3 329 099.300
L138	38 246.120	3 331	936.890	R138	36 870.660	3 329 011.870
L139	38 235.630	3 331	911.250	R139	36 796.810	3 328 849.690
L140	38 225.170	3 331	886.070	R140	36 706.040	3 328 650.990
L141	38 209.560	3 331	848.670	R141	36 512.710	3 328 227.300
L142	38 198.710	3 331	822.970	R142	36 102.860	3 327 326.780
L143	38 182.790	3 331	785.530	R143	35 904.480	3 326 890.540
L144	38 171.960	3 331	760.250	R144	35 684.450	3 326 406.890
L145	38 166.410	3 331	747.660	R145	35 467.350	3 325 930.960
L146	38 138.520	3 331	683.900	R146	35 337.110	3 325 644.550
L147	38 115.930	3 331	633.300	R147	35 115.290	3 325 157.460
L148	38 104.470	3 331	608.000	R148	34 980.130	3 324 860.880
L149	38 064.830	3 331	520.750	R149	34 838.250	3 324 548.670
L150	37 883.380	3 331	122.200	R150	34 793.200	3 324 449.780
L151	37 673.240	3 330	661.130	R151	34 636.150	3 324 104.450
L152	37 473.010	3 330	221.220	R152	34 490.750	3 323 784.380

Vel	24	Van	30	P707/08
Sheet		of		

PADRESERWE KOÖRDINATE / ROAD RESERVE CO-ORDINATES					
LINKERKANT/LEFT HAND SIDE			REGTERKANT/RIGHT HAND SIDE		
	Y	X	WG 21°		X
L153	37 274.700	3 329	785.960	R153	34 305.080 3 323 376.930
L154	37 060.010	3 329	314.660	R154	34 193.320 3 323 131.180
L155	36 979.980	3 329	139.010	R155	33 982.390 3 322 669.060
L156	36 837.450	3 328	825.580	R156	33 782.580 3 322 230.930
L157	36 746.800	3 328	626.430	R157	33 569.620 3 321 763.360
L158	36 558.770	3 328	213.610	R158	33 152.230 3 320 847.500
L159	36 351.880	3 327	759.030	R159	32 731.540 3 319 923.910
L160	36 144.040	3 327	303.130	R160	32 532.230 3 319 486.450
L161	35 939.970	3 326	854.720	R161	32 311.870 3 319 002.450
L162	35 724.470	3 326	381.300	R162	31 884.770 3 318 064.980
L163	35 511.750	3 325	914.390	R163	31 163.320 3 316 480.870
L164	35 375.940	3 325	615.650	R164	31 055.480 3 316 244.220
L165	35 156.440	3 325	133.590	R165	30 845.120 3 315 782.220
L166	35 025.800	3 324	846.540	R166	30 637.430 3 315 326.380
L167	34 883.180	3 324	533.010	R167	30 315.460 3 314 619.430
L168	34 832.440	3 324	421.540	R168	30 217.420 3 314 404.170
L169	34 677.970	3 324	082.610	R169	29 791.050 3 313 468.440
L170	34 535.810	3 323	769.920	R170	29 619.810 3 313 092.770
L171	34 362.630	3 323	389.860	R171	29 420.160 3 312 654.530
L172	33 827.210	3 322	214.560	R172	29 212.020 3 312 197.990
L173	33 612.960	3 321	744.500	R173	28 988.830 3 311 708.110
L174	33 196.700	3 320	830.680	R173X	28 977.400 3 311 682.950
L175	32 993.950	3 320	386.020	R174	28 932.100 3 311 582.880
L176	32 776.240	3 319	907.770	R175	28 738.970 3 311 157.850
L177	32 570.760	3 319	456.590	R176	28 527.440 3 310 694.880
L178	32 355.150	3 318	983.840	R177	28 447.860 3 310 519.700
L179	32 133.340	3 318	496.330	R178	28 390.870 3 310 394.870
L180	31 923.710	3 318	036.280	R179	28 369.060 3 310 347.190
L181	31 741.280	3 317	635.550	R180	28 346.200 3 310 296.930
L182	31 512.850	3 317	134.400	R181	28 329.170 3 310 259.610
L183	31 407.310	3 316	902.990	R182	28 306.450 3 310 209.580
L184	31 201.680	3 316	451.330	R183	28 272.240 3 310 134.210
L185	31 100.440	3 316	229.060	R184	28 220.800 3 310 021.630
L186	30 887.040	3 315	760.440	R185	28 198.040 3 309 971.860
L187	30 685.600	3 315	318.400	R186	28 180.760 3 309 934.470
L188	30 486.890	3 314	882.130	R187	28 163.250 3 309 897.150
L189	30 344.020	3 314	568.670	R188	28 122.150 3 309 810.770
L190	30 275.950	3 314	419.320	R189	28 028.990 3 309 626.270
L191	30 025.600	3 313	868.690	R190	27 817.820 3 309 208.450
L192	29 843.910	3 313	470.540	R191	27 579.200 3 308 736.400
L193	29 670.590	3 313	089.450	R192	27 378.020 3 308 339.100
L194	29 459.270	3 312	626.050	R193	27 370.020 3 308 333.050
L195	29 066.570	3 311	764.240	R194	27 363.440 3 308 324.960
L196	28 975.880	3 311	565.010	R195	27 351.180 3 308 319.380
L197	28 782.870	3 311	141.470	R196	27 351.400 3 308 306.750
L198	28 549.310	3 310	628.850	R197	27 349.960 3 308 283.220
L199	28 492.400	3 310	503.780	R198	27 346.330 3 308 275.590
L200	28 393.610	3 310	287.190	R199	27 254.620 3 308 094.290
L201	28 359.450	3 310	212.120	R200	27 161.890 3 307 910.800
L202	28 342.470	3 310	174.850	R201	26 943.100 3 307 478.500
L203	28 319.560	3 310	124.390	R202	26 865.750 3 307 325.220

Vel	25	Van	30	P707/08
Sheet		of		

PADRESERWE KOÖRDINATE / ROAD RESERVE CO-ORDINATES						
LINKERKANT/LEFT HAND SIDE				REGTERKANT/RIGHT HAND SIDE		
	Y	X	WG 21°		Y	X
L204	28 296.770	3 310	074.340	R203	26 763.850	3 307 123.540
L205	28 291.200	3 310	061.870	R204	26 323.940	3 306 253.390
L206	28 285.530	3 310	049.380	R205	26 120.160	3 305 850.200
L207	28 279.840	3 310	036.850	R206	25 889.330	3 305 393.660
L208	28 274.030	3 310	024.170	R207	25 669.200	3 304 958.490
L209	28 262.560	3 309	999.260	R208	25 448.890	3 304 522.640
L209X	28 256.770	3 309	986.570	R209	25 223.440	3 304 076.760
L210	28 233.990	3 309	937.560	R210	24 989.520	3 303 613.820
L211	28 228.140	3 309	924.740	R211	24 874.020	3 303 385.920
L212	28 222.430	3 309	912.180	R212	24 683.440	3 303 008.560
L213	28 204.900	3 309	874.790	R213	24 674.070	3 302 990.210
L214	28 181.640	3 309	825.190	R214	24 669.010	3 302 980.440
L215	28 175.730	3 309	812.720	R215	24 646.980	3 302 937.150
L216	28 169.560	3 309	800.350	R216	24 427.460	3 302 502.920
L217	28 157.310	3 309	775.860	R217	24 199.300	3 302 051.170
L218	28 069.000	3 309	600.540	R218	23 979.070	3 301 615.690
L219	27 860.310	3 309	187.740	R219	23 758.710	3 301 179.810
L220	27 621.620	3 308	715.510	R219X	23 744.440	3 301 151.890
L221	27 404.710	3 308	286.500	R220	23 695.270	3 301 054.340
L222	27 379.860	3 308	237.290	R221	23 475.890	3 300 620.330
L223	27 372.790	3 308	223.060	R222	23 263.920	3 300 201.070
L224	27 369.980	3 308	217.800	R223	23 020.130	3 299 719.130
L225	27 292.690	3 308	064.200	R224	22 907.500	3 299 496.250
L226	27 199.420	3 307	880.760	R225	22 892.470	3 299 466.680
L227	26 997.100	3 307	479.760	R226	22 685.470	3 299 056.870
L228	26 909.090	3 307	306.030	R227	22 668.960	3 299 024.140
L229	26 799.730	3 307	089.980	R228	22 647.080	3 298 980.490
L230	26 690.850	3 306	874.540	R229	22 619.830	3 298 926.290
L231	26 652.360	3 306	798.290	R230	22 581.590	3 298 851.140
L232	26 553.330	3 306	602.510	R231	22 559.720	3 298 806.860
L233	26 163.010	3 305	830.450	R232	22 548.830	3 298 785.300
L234	25 933.690	3 305	377.000	R233	22 537.870	3 298 764.250
L235	25 713.260	3 304	941.020	R234	22 532.180	3 298 752.640
L236	24 908.400	3 303	349.560	R235	22 527.180	3 298 742.060
L237	24 897.710	3 303	327.790	R236	22 526.130	3 298 730.130
L238	24 693.550	3 302	923.850	R237	22 525.180	3 298 717.940
L239	24 474.170	3 302	490.030	R238	22 522.880	3 298 706.120
L240	23 805.350	3 301	166.840	R239	22 519.380	3 298 694.330
L240X	23 799.520	3 301	155.770	R240	22 515.100	3 298 682.560
L241	23 749.840	3 301	057.520	R241	22 508.800	3 298 672.390
L241X	23 744.230	3 301	046.740	R242	22 502.960	3 298 665.790
L242	23 711.940	3 300	982.250	R243	22 485.870	3 298 658.040
L243	23 695.190	3 300	949.700	R244	22 469.520	3 298 626.160
L244	23 513.530	3 300	590.030	R245	22 435.840	3 298 560.660
L245	23 337.250	3 300	241.590	R246	22 322.580	3 298 345.390
L246	23 326.400	3 300	219.820	R247	22 315.470	3 298 331.510
L247	23 304.420	3 300	176.130	R248	22 194.910	3 298 084.250
L248	23 061.950	3 299	696.950	R249	22 178.400	3 298 050.140
L249	22 938.860	3 299	453.270	R250	22 158.490	3 298 009.210
L250	22 933.470	3 299	442.680	R251	22 153.670	3 297 999.830
L251	22 710.390	3 299	001.350	R252	22 144.670	3 297 982.020

Vel	26	Van	30	P707/08
Sheet		of		

PADRESERWE KOÖRDINATE / ROAD RESERVE CO-ORDINATES						
LINKERKANT/LEFT HAND SIDE				REGTERKANT/RIGHT HAND SIDE		
	Y	X	WG 21°		Y	X
L252	22 705.100	3 298	991.230	R253	22 122.140	3 297 939.230
L253	22 699.680	3 298	980.180	R254	22 093.480	3 297 884.890
L254	22 563.060	3 298	710.080	R255	22 081.400	3 297 861.760
L255	22 552.160	3 298	688.260	R256	22 034.500	3 297 768.940
L256	22 480.890	3 298	547.050	R257	22 037.890	3 297 750.410
L257	22 469.940	3 298	525.340	R258	22 013.190	3 297 726.730
L258	22 453.350	3 298	492.670	R259	21 996.940	3 297 694.400
L259	22 370.690	3 298	329.130	R260	21 988.530	3 297 677.550
L260	22 244.150	3 298	078.870	R261	21 971.460	3 297 645.230
L261	22 101.310	3 297	796.080	R262	21 972.630	3 297 635.420
L262	22 073.580	3 297	741.470	R263	21 948.190	3 297 602.380
L263	22 057.130	3 297	708.960	R264	21 936.190	3 297 581.460
L264	22 040.750	3 297	676.650	R265	21 923.680	3 297 559.880
L265	22 018.400	3 297	632.720	R266	21 911.830	3 297 540.250
L266	22 006.920	3 297	611.170	R267	21 891.940	3 297 507.740
L267	22 001.200	3 297	600.630	R267X	21 872.660	3 297 476.900
L268	21 995.330	3 297	590.050	R268	21 865.990	3 297 466.510
L269	21 983.550	3 297	568.790	R269	21 838.720	3 297 425.910
L270	21 965.470	3 297	537.320	R270	21 825.000	3 297 405.890
L271	21 946.690	3 297	505.950	R271	21 811.350	3 297 386.870
L272	21 933.650	3 297	484.830	R272	21 796.350	3 297 366.130
L273	21 920.880	3 297	464.420	R273	21 774.590	3 297 337.080
L274	21 914.360	3 297	454.270	R274	21 767.350	3 297 327.480
L275	21 888.010	3 297	414.130	R275	21 752.470	3 297 308.240
L276	21 880.840	3 297	403.450	R276	21 737.320	3 297 289.290
L277	21 868.350	3 297	385.440	R277	21 714.380	3 297 261.170
L278	21 853.180	3 297	363.900	R278	21 706.580	3 297 251.840
L279	21 839.210	3 297	344.360	R279	21 690.840	3 297 233.120
L280	21 831.930	3 297	334.410	R280	21 667.020	3 297 205.570
L281	21 809.970	3 297	305.210	R281	21 642.490	3 297 178.230
L282	21 787.850	3 297	276.240	R282	21 634.370	3 297 169.410
L283	21 772.450	3 297	257.150	R283	21 584.180	3 297 115.450
L284	21 757.030	3 297	238.220	R284	21 097.000	3 296 593.810
L285	21 741.820	3 297	219.770	R285	20 736.090	3 296 207.490
L286	21 725.660	3 297	200.960	R286	20 383.710	3 295 830.160
L287	21 701.800	3 297	173.240	R287	20 215.350	3 295 649.800
L288	21 685.290	3 297	155.050	R288	20 065.100	3 295 488.860
L289	21 660.340	3 297	127.790	R289	19 727.810	3 295 127.830
L290	21 644.060	3 297	110.230	R290	19 362.420	3 294 736.610
L291	21 602.380	3 297	065.600	R291	19 118.410	3 294 475.270
L292	21 427.570	3 296	878.540	R292	18 812.970	3 294 148.310
L293	21 118.230	3 296	547.320	R293	18 438.360	3 293 747.080
L294	21 099.990	3 296	527.790	R294	18 138.550	3 293 426.290
L295	20 771.560	3 296	176.220	R295	17 846.160	3 293 112.970
L296	20 416.980	3 295	796.490	R296	17 817.910	3 293 082.770
L297	20 271.420	3 295	640.650	R297	16 642.850	3 291 824.490
L298	20 101.330	3 295	458.570	R298	16 428.640	3 291 595.100
L299	19 753.830	3 295	086.430	R299	16 121.110	3 291 265.850
L300	19 397.420	3 294	704.890	R300	15 764.690	3 290 884.180
L301	19 153.300	3 294	443.380	R301	15 435.980	3 290 532.370
L302	18 848.480	3 294	116.900	R302	15 163.410	3 290 240.420

Vel
Sheet27 Van 30
of

P707/08

PADRESERWE KOÖRDINATE / ROAD RESERVE CO-ORDINATES						
LINKERKANT/LEFT HAND SIDE				REGTERKANT/RIGHT HAND SIDE		
	Y	X	WG 21°		Y	X
L303	18 472.720	3 293 714.660		R303	14 850.360	3 289 905.180
L304	17 834.970	3 293 031.810		R303X	14 845.730	3 289 900.230
L305	17 495.310	3 292 668.030		R304	14 780.290	3 289 830.170
L306	16 738.260	3 291 857.400		R305	14 743.180	3 289 790.310
L307	16 462.420	3 291 562.020		R306	14 715.120	3 289 760.330
L308	16 156.890	3 291 234.490		R307	14 684.390	3 289 724.980
L309	15 810.700	3 290 863.270		R308	14 647.200	3 289 682.430
L310	15 473.500	3 290 502.310		R309	14 633.320	3 289 666.630
L311	15 210.750	3 290 220.770		R310	14 598.020	3 289 626.370
L312	15 179.400	3 290 186.860		R311	14 514.680	3 289 518.970
L313	15 164.180	3 290 171.050		R312	14 479.870	3 289 474.310
L314	14 893.580	3 289 881.230		R313	14 448.190	3 289 429.570
L315	14 884.010	3 289 870.960		R314	14 394.540	3 289 353.210
L316	14 788.090	3 289 768.220		R314X	14 390.530	3 289 347.470
L317	14 739.790	3 289 716.850		R315	14 132.580	3 288 980.770
L318	14 727.230	3 289 703.890		R316	14 032.310	3 288 838.280
L319	14 717.820	3 289 693.580		R317	13 202.940	3 287 659.310
L320	14 690.730	3 289 662.620		R318	12 918.870	3 287 255.980
L321	14 664.120	3 289 631.450		R319	12 627.430	3 286 841.390
L322	14 646.610	3 289 610.250		R320	12 611.390	3 286 819.080
L323	14 628.890	3 289 589.560		R321	12 483.910	3 286 637.510
L324	14 620.070	3 289 578.900		R322	12 208.420	3 286 245.780
L325	14 585.960	3 289 535.990		R323	11 931.800	3 285 852.580
L326	14 577.500	3 289 525.140		R324	11 640.320	3 285 438.110
L327	14 552.610	3 289 492.320		R325	11 610.720	3 285 396.040
L328	14 527.840	3 289 459.250		R326	11 076.950	3 284 637.320
L329	14 507.030	3 289 430.920		R327	10 501.100	3 283 818.990
L330	14 430.550	3 289 322.300		R328	10 224.700	3 283 426.130
L331	14 177.120	3 288 961.980		R329	9 957.150	3 283 045.420
L332	14 074.860	3 288 816.900		R330	9 666.450	3 282 632.260
L333	13 794.150	3 288 417.620		R331	9 382.480	3 282 228.810
L334	13 510.910	3 288 015.030		R332	9 366.500	3 282 206.520
L335	12 646.550	3 286 786.040		R333	9 309.970	3 282 125.590
L336	12 524.850	3 286 613.370		R334	8 559.980	3 281 059.880
L337	12 241.150	3 286 209.960		R335	8 244.210	3 280 610.940
L338	11 646.360	3 285 364.640		R336	7 968.300	3 280 218.290
L339	11 403.450	3 285 019.400		R337	7 707.730	3 279 847.700
L340	9 403.470	3 282 176.290		R338	7 431.600	3 279 455.240
L341	9 344.240	3 282 092.150		R339	7 148.230	3 279 052.280
L342	9 162.890	3 281 834.580		R340	7 126.020	3 279 054.890
L343	8 856.290	3 281 398.900		R341	7 120.630	3 279 013.210
L344	8 832.280	3 281 364.420		R342	6 538.410	3 278 185.380
L345	8 602.340	3 281 037.610		R343	6 246.940	3 277 770.970
L346	8 287.330	3 280 589.780		R344	5 988.320	3 277 403.430
L347	7 163.970	3 278 992.520		R345	5 707.210	3 277 003.470
L348	7 158.230	3 278 932.720		R346	5 544.000	3 276 771.530
L349	7 120.480	3 278 930.750		R347	4 325.860	3 275 040.290
L350	6 999.960	3 278 759.570		R348	4 303.400	3 275 034.870
L351	6 699.640	3 278 332.630		R349	4 309.990	3 275 017.750
L352	6 569.260	3 278 147.540		R350	4 014.280	3 274 597.050
L353	6 282.480	3 277 739.400		R351	3 730.260	3 274 193.430

Vel	28	Van	30	P707/08
Sheet		of		

PADRESERWE KOÖRDINATE / ROAD RESERVE CO-ORDINATES						
LINKERKANT/LEFT HAND SIDE				REGTERKANT/RIGHT HAND SIDE		
	Y	X	WG 21°		Y	X
L354	6 022.860	3 277	370.510	R352	3 156.300	3 273 377.340
L355	5 722.210	3 276	943.150	R353	2 886.690	3 272 994.190
L356	5 583.080	3 276	745.290	R354	2 616.210	3 272 609.560
L357	5 205.880	3 276	209.230	R355	2 048.350	3 271 802.430
L358	4 939.020	3 275	829.780	R356	1 875.010	3 271 556.000
L359	4 639.580	3 275	403.770	R357	1 868.630	3 271 546.670
L360	4 049.040	3 274	564.310	R358	1 699.570	3 271 306.830
L361	3 772.630	3 274	171.480	R359	1 171.170	3 270 555.530
L362	2 079.480	3 271	764.630	R360	855.380	3 270 106.790
L363	1 961.460	3 271	596.750	R361	583.150	3 269 719.580
L364	1 951.810	3 271	582.630	R362	-251.110	3 268 533.630
L365	1 739.310	3 271	280.900	R363	-551.560	3 268 106.440
L366	1 433.490	3 270	846.010	R364	-828.030	3 267 713.430
L367	1 203.190	3 270	518.610	R365	-983.840	3 267 492.240
L368	904.140	3 270	093.240	R366	-1 284.520	3 267 064.660
L369	621.580	3 269	691.890	R367	-1 410.440	3 266 885.680
L370	69.970	3 268	907.470	R368	-3 809.400	3 263 475.110
L371	- 210.190	3 268	509.720	R369	-3 898.050	3 263 349.080
L372	- 510.400	3 268	083.060	R370	-4 228.700	3 262 878.900
L373	- 788.500	3 267	687.590	R371	-4 531.120	3 262 448.950
L374	- 944.240	3 267	466.220	R372	-4 805.220	3 262 059.020
L375	-1 385.560	3 266	838.830	R373	-5 088.100	3 261 656.770
L376	-3 787.400	3 263	424.280	R374	-5 174.780	3 261 533.400
L377	-3 892.580	3 263	274.740	R375	-5 205.370	3 261 490.490
L378	-4 193.730	3 262	846.680	R376	-5 387.740	3 261 231.050
L379	-4 488.270	3 262	427.880	R377	-5 785.160	3 260 665.880
L380	-4 768.660	3 262	029.010	R378	-6 084.730	3 260 239.110
L381	-5 042.900	3 261	639.200	R379	-6 357.310	3 259 852.280
L382	-5 146.490	3 261	491.650	R380	-6 651.200	3 259 434.510
L383	-5 194.420	3 261	423.770	R381	-6 930.250	3 259 037.480
L384	-5 344.340	3 261	210.550	R382	-7 254.220	3 258 577.130
L385	-5 463.590	3 261	041.120	R383	-7 484.450	3 258 249.860
L386	-5 745.320	3 260	640.410	R384	-8 283.240	3 257 114.080
L387	-6 040.420	3 260	220.940	R385	-8 579.770	3 256 692.290
L388	-6 314.190	3 259	831.540	R386	-8 791.200	3 256 391.370
L389	-6 890.560	3 259	012.100	R387	-9 864.140	3 254 865.800
L390	-7 448.610	3 258	218.510	R388	-9 887.510	3 254 832.420
L391	-7 699.120	3 257	862.360	R389	-9 890.110	3 254 820.310
L392	-8 035.540	3 257	384.280	R390	-9 891.680	3 254 808.240
L393	-8 130.400	3 257	248.790	R391	-9 894.130	3 254 786.860
L394	-8 270.520	3 257	049.910	R392	-9 906.980	3 254 770.320
L395	-8 762.540	3 256	350.300	R393	-9 934.210	3 254 766.300
L396	-9 575.200	3 255	194.750	R394	-9 955.630	3 254 736.080
L397	-9 848.480	3 254	806.100	R395	-10 011.260	3 254 656.710
L398	-9 911.420	3 254	716.750	R396	-10 048.220	3 254 605.290
L399	-10 016.320	3 254	569.450	R397	-10 091.920	3 254 546.860
L400	-10 052.810	3 254	521.020	R398	-10 137.280	3 254 489.780
L401	-10 090.170	3 254	473.060	R399	-10 176.000	3 254 443.140
L402	-10 136.440	3 254	416.540	R400	-10 223.780	3 254 387.960
L403	-10 176.240	3 254	370.370	R401	-10 264.660	3 254 342.900
L404	-10 211.770	3 254	330.170	R402	-10 348.190	3 254 254.490

Vel	29	Van	30	P707/08
Sheet		of		

PADRESERWE KOÖRDINATE / ROAD RESERVE CO-ORDINATES						
LINKERKANT/LEFT HAND SIDE				REGTERKANT/RIGHT HAND SIDE		
	Y	X	WG 21°		Y	X
L405	-10	258.290	3 254 280.480	R402X	-10	357.910 3 254 244.750
L406	-10	315.350	3 254 222.120	R403	-10	551.580 3 254 048.340
L407	-11	615.310	3 252 903.670	R404	-10	933.650 3 253 661.000
L408	-11	682.430	3 252 835.460	R405	-11	279.910 3 253 310.170
L409	-11	710.420	3 252 806.200	R406	-11	597.680 3 252 988.330
L410	-11	738.140	3 252 776.370	R407	-11	676.260 3 252 908.690
L411	-11	765.530	3 252 746.180	R408	-11	762.110 3 252 819.000
L412	-11	801.480	3 252 705.230	R409	-11	817.060 3 252 757.740
L413	-11	836.250	3 252 663.800	R410	-11	858.060 3 252 710.180
L414	-11	861.980	3 252 632.570	R411	-11	875.580 3 252 689.190
L415	-11	887.080	3 252 601.100	R412	-11	910.450 3 252 646.380
L416	-11	919.930	3 252 558.720	R413	-11	960.870 3 252 581.490
L417	-11	959.540	3 252 505.550	R414	-12	002.730 3 252 524.470
L418	-12	014.470	3 252 427.860	R415	-12	050.160 3 252 457.580
L419	-13	966.980	3 249 660.980	R416	-12	995.950 3 251 117.090
L420	-13	994.250	3 249 608.650	R417	-14	020.370 3 249 666.110
L421	-14	166.620	3 249 364.760	R418	-14	017.320 3 249 658.830
L422	-14	180.640	3 249 344.800	R419	-14	179.420 3 249 428.710
L423	-14	212.230	3 249 299.940	R420	-14	184.830 3 249 421.020
L424	-14	243.830	3 249 255.080	R421	-14	216.420 3 249 376.170
L425	-14	275.420	3 249 210.240	R422	-14	248.010 3 249 331.310
L426	-14	297.510	3 249 178.880	R423	-14	279.600 3 249 286.460
L427	-14	306.040	3 249 165.550	R424	-14	311.190 3 249 241.600
L428	-14	334.890	3 249 121.270	R424X	-14	336.040 3 249 206.310
L429	-14	363.600	3 249 076.960	R425	-14	341.380 3 249 197.030
L430	-14	386.890	3 249 041.150	R426	-14	366.430 3 249 153.460
L431	-14	390.830	3 249 032.940	R427	-14	391.490 3 249 109.940
L432	-14	411.640	3 248 990.290	R428	-14	416.540 3 249 066.370
L433	-14	432.470	3 248 947.590	R429	-14	438.880 3 249 023.350
L434	-14	439.250	3 248 932.600	R430	-14	461.210 3 248 980.370
L435	-14	502.810	3 248 792.020	R431	-14	469.690 3 248 964.030
L436	-14	545.190	3 248 660.430	R432	-14	531.020 3 248 845.870
L437	-14	540.240	3 248 657.740	R433	-14	566.910 3 248 738.670
L438	-14	545.240	3 248 638.060	R434	-14	589.310 3 248 660.570
L439	-14	574.260	3 248 518.920	R435	-14	589.080 3 248 655.880
L440	-14	583.980	3 248 479.670	R436	-14	606.460 3 248 587.880
L441	-14	603.080	3 248 400.690	R437	-14	606.540 3 248 585.510
L442	-14	615.130	3 248 403.610	R438	-14	632.020 3 248 480.890
L443	-14	827.200	3 247 531.940	R438X	-14	634.230 3 248 470.270
				R439	-14	648.930 3 248 411.800
				R440	-14	636.270 3 248 408.740
				R441	-14	847.610 3 247 536.890

Vel 30 Van 30
Sheet of

P707/08

Printed by and obtainable from the Government Printer, Bosman Street, Private Bag X85, Pretoria, 0001
Publications: Tel: (012) 334-4508, 334-4509, 334-4510
Advertisements: Tel: (012) 334-4673, 334-4674, 334-4504
Subscriptions: Tel: (012) 334-4735, 334-4736, 334-4737
Cape Town Branch: Tel: (021) 465-7531

Gedruk deur en verkrygbaar by die Staatsdrukker, Bosmanstraat, Privaatsak X85, Pretoria, 0001
Publikasies: Tel: (012) 334-4508, 334-4509, 334-4510
Advertensies: Tel: (012) 334-4673, 334-4674, 334-4504
Subskripsies: Tel: (012) 334-4735, 334-4736, 334-4737
Kaapstad-tak: Tel: (021) 465-7531