

IMPORTANT NOTICE

The Government Printing Works will not be held responsible for faxed documents not received due to errors on the fax machine or faxes received which are unclear or incomplete. Please be advised that an "OK" slip, received from a fax machine, will not be accepted as proof that documents were received by the GPW for printing. If documents are faxed to the GPW it will be the sender's responsibility to phone and confirm that the documents were received in good order.

Furthermore the Government Printing Works will also not be held responsible for cancellations and amendments which have not been done on original documents received from clients.

CONTENTS • INHOUD

<i>No.</i>		<i>Page No.</i>	<i>Gazette No.</i>
GENERAL NOTICES			
2005	Gauteng Transport Infrastructure Act (8/2001): Cancellation of a notice in the Provincial Gazette Extraordinary: Notice 1867 of 2011	3	162
2006	do.: Closing of access road to Provincial Road P1-2 (K101)	4	162
2007	do.: Proposed reduction in width of a portion of Provincial Road P91-1	6	162

GENERAL NOTICES

NOTICE 2005 OF 2011

**CANCELLATION OF A NOTICE IN THE PROVINCIAL GAZETTE EXTRAORDINARY
IN RESPECT OF PROPOSED CLOSING OF AN ACCESS ROAD TO PROVINCIAL ROAD
P1-2 (K101) OVER REMAINDER PORTION OF PORTION 1 OF THE FARM
WATERVAL 5 IR**

In terms of section 13 (2) of the Gauteng Transport Infrastructure Act, 2001 (Act No 8 of 2001) the MEC hereby cancel Notice 1867 of 2011 in the Provincial Gazette Extraordinary No 152 dated 13 July 2011.

Reference: 2/1/1/2/3/1-P1-2 (K101)

NOTICE 2006 OF 2011**PROPOSED CLOSING OF AN ACCESS ROAD TO PROVINCIAL ROAD P1-2 (K101) OVER
REMAINDER PORTION OF PORTION 1 OF THE FARM WATERVAL 5 – IR: DISTRICT
MIDRAND**

An application in terms of section 38 (1) of the Gauteng Transport Infrastructure Act, 2001 (Act No. 8 of 2001) has been received for the closing of an access road to provincial road P1-2 (K101) over remainder portion of Portion 1 of the farm Waterval 5 IR as indicated on the accompanying sketch plan.

In terms of section 38 (2) of the aforementioned Act interested parties are requested to lodge comments or objections in writing, to the Head: Department of Roads and Transport, Director: Design, Private Bag X83, Marshalltown 2107, within 30 (thirty) days after the date of this notice.

Reference: 2/1/1/2/3/1 – P1-2 (K101)

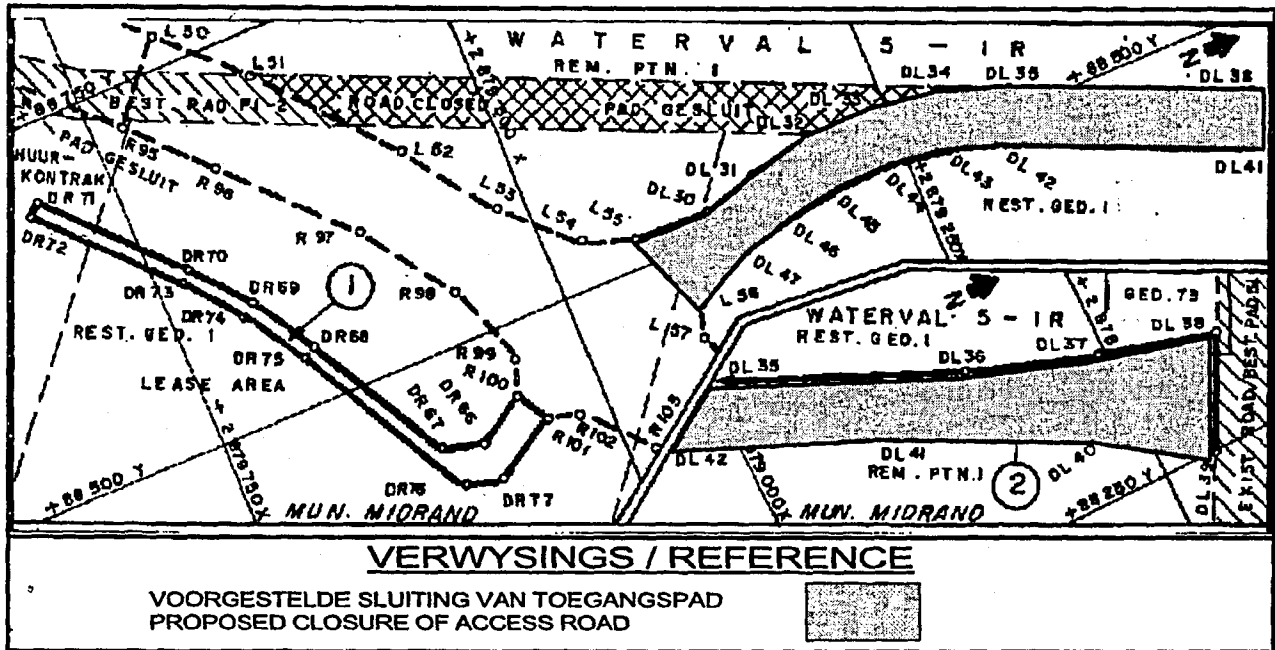

NOTICE 2007 OF 2011**PROPOSED REDUCTION IN WIDTH OF A PORTION OF PROVINCIAL ROAD P91-1 OVER A PORTION OF THE REMAINDER OF PORTION 66 OF THE FARM MODDERFONTEIN 35 IR.**

An application in terms of section 38 (1) of the Gauteng Transport Infrastructure Act, 2001 (Act No 8 of 2001) has been received from Lloyd Druce of VBGD Town Planners to reduce the road reserve of a portion of provincial road P91-1 over a portion of the Remainder of Portion 66 of the farm Modderfontein 35 IR.

In terms of section 38 (2) of the aforementioned Act interested parties are hereby requested to submit comments or objections in writing to the: Department of Roads and Transport, Directorate Design: Attention Ms.E Marais, Tel 011 355 7020, Private Bag X83, Marshalltown 2107, within 30 (thirty) days after the date of this notice.

Reference: (2/1)2/1/1/2/3/1-P91-1

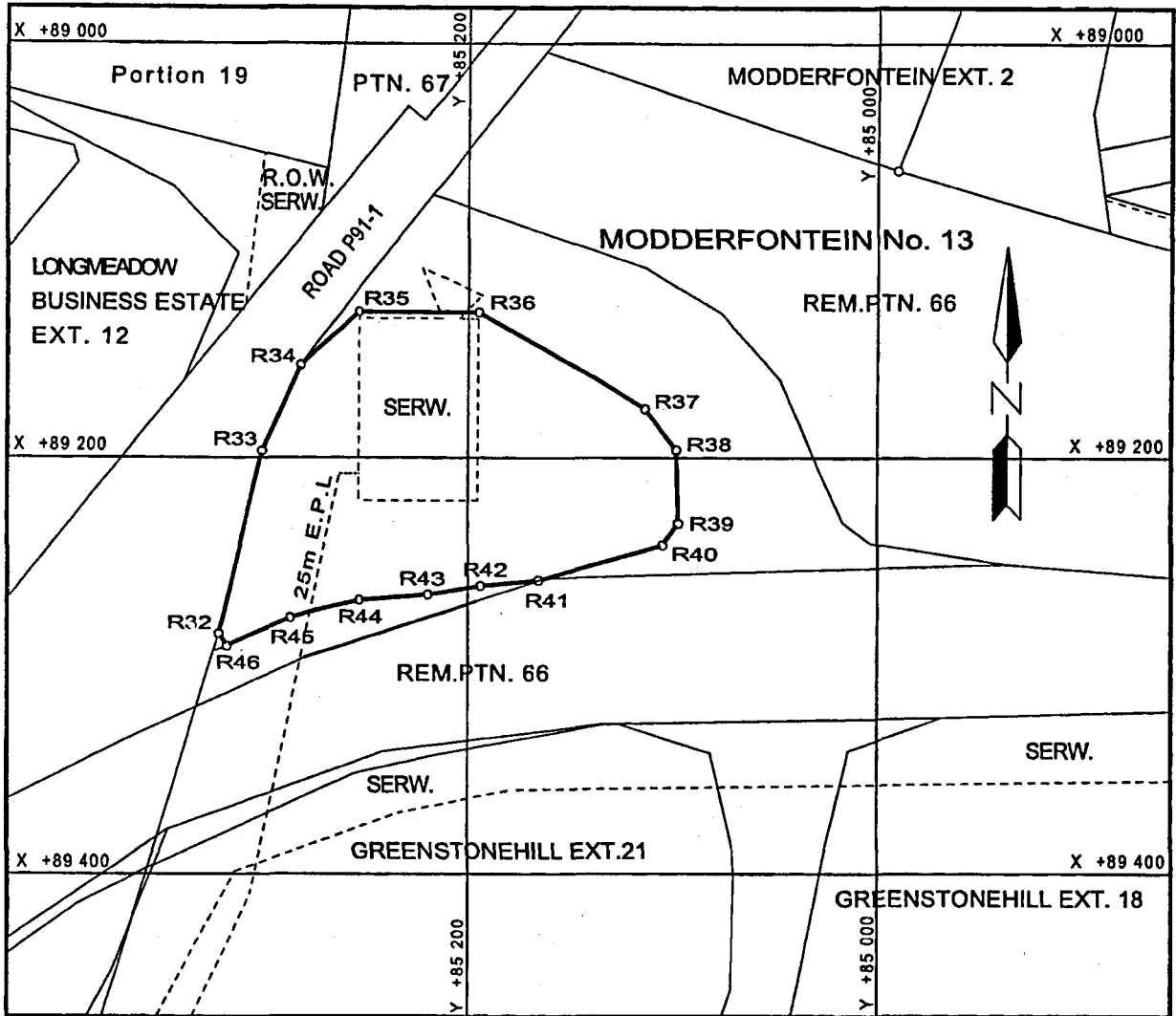

VERWYSING / REFERENCE

VERMINDERING IN BREETE
REDUCTION IN WIDTH



DIE FIGUUR : R32-R46, R32

VERTEENWOORDIG DIE VERMINDERING IN BREETE VAN DIE BETROKKE GEDEELTE VAN PROVINSIALE PAD P91-1 OOR RESTANT GEDEELTE 66 VAN DIE PLAAS MODDERFONTEIN 35-IR SOOS BEDOEL BY AFKONDIGING DAARVAN IN DIE PROVINSIALE KOERANT EN IN DETAIL GETOON OP PLAN GRP05/38/4EXp

THE FIGURE : R32-R46, R32

REPRESENTS THE REDUCTION IN WIDTH OF THE PORTION CONCERNED OF PROVINCIAL ROAD P91-1 OVER REMAINDER PORTION 66 OF THE FARM MODDERFONTEIN 35-IR AS INTENDED BY PUBLICATION THEREOF IN THE PROVINCIAL GAZETTE AND SHOWN IN DETAIL ON PLAN GRP05/38/4EXp

BUNDEL NR. / FILE NO. 2/1/1/2/3/1-P91-1

KOÖRDINATE LYS / CO-ORDINATE LIST WG 29° KONST. / CONST. Y = ± 0.000 X = +2 800 000.000

R32	+85 322,33	+89 284,28	R37	+85 113,71	+89 176,36	R42	+85 193,66	+89 261,25
R33	+85 300,95	+89 196,62	R38	+85 097,90	+89 196,16	R43	+85 219,76	+89 265,35
R34	+85 282,35	+89 155,32	R39	+85 096,80	+89 231,37	R44	+85 253,36	+89 267,97
R35	+85 253,78	+89 129,79	R40	+85 104,51	+89 241,76	R45	+85 287,38	+89 276,49
R36	+85 194,76	+89 130,05	R41	+85 165,56	+89 258,58	R46	+85 318,45	+89 290,26

