

IMPORTANT NOTICE

The Government Printing Works will not be held responsible for faxed documents not received due to errors on the fax machine or faxes received which are unclear or incomplete. Please be advised that an "OK" slip, received from a fax machine, will not be accepted as proof that documents were received by the GPW for printing. If documents are faxed to the GPW it will be the sender's responsibility to phone and confirm that the documents were received in good order.

Furthermore the Government Printing Works will also not be held responsible for cancellations and amendments which have not been done on original documents received from clients.

CONTENTS • INHOUD

No.

Page
No. Gazette
No.**GENERAL NOTICE**

2397	Gauteng Transport Infrastructure Act (8/2001): Proclamation of the reduction in width of a portion of the provincial railway line in respect of the Gautrain Rapid Rail Link between Pretoria, Johannesburg and the O R Tambo International Airport: District Kempton Park.....	3	205
------	---	---	-----

GENERAL NOTICE

NOTICE 2397 OF 2011

PROCLAMATION OF THE REDUCTION IN WIDTH OF A PORTION OF THE PROVINCIAL RAILWAY LINE IN RESPECT OF THE GAUTRAIN RAPID RAIL LINK BETWEEN PRETORIA, JOHANNESBURG AND THE O R TAMBO INTERNATIONAL AIRPORT : DISTRICT KEMPTON PARK

In terms of section 11(2) of the Gauteng Transport Infrastructure Act, 2001 (Act No. 8 of 2001) the MEC hereby proclaims the reduction in width of a portion of the provincial railway line on Portion 282 of Witkoppie 64-IR, district Kempton Park.

In terms of section 23(6) of the aforementioned act it is hereby declared that plan GRP 03/38/18 Exp, which indicates the reduction in width of the railway line on the land in detail, is available for inspection at the office of the Department of Roads and Transport, First Floor, South Tower, Sage Life Building, 41 Simmonds Street, Johannesburg, during office hours.

Reference: 2/1/7/8 - Gautrain

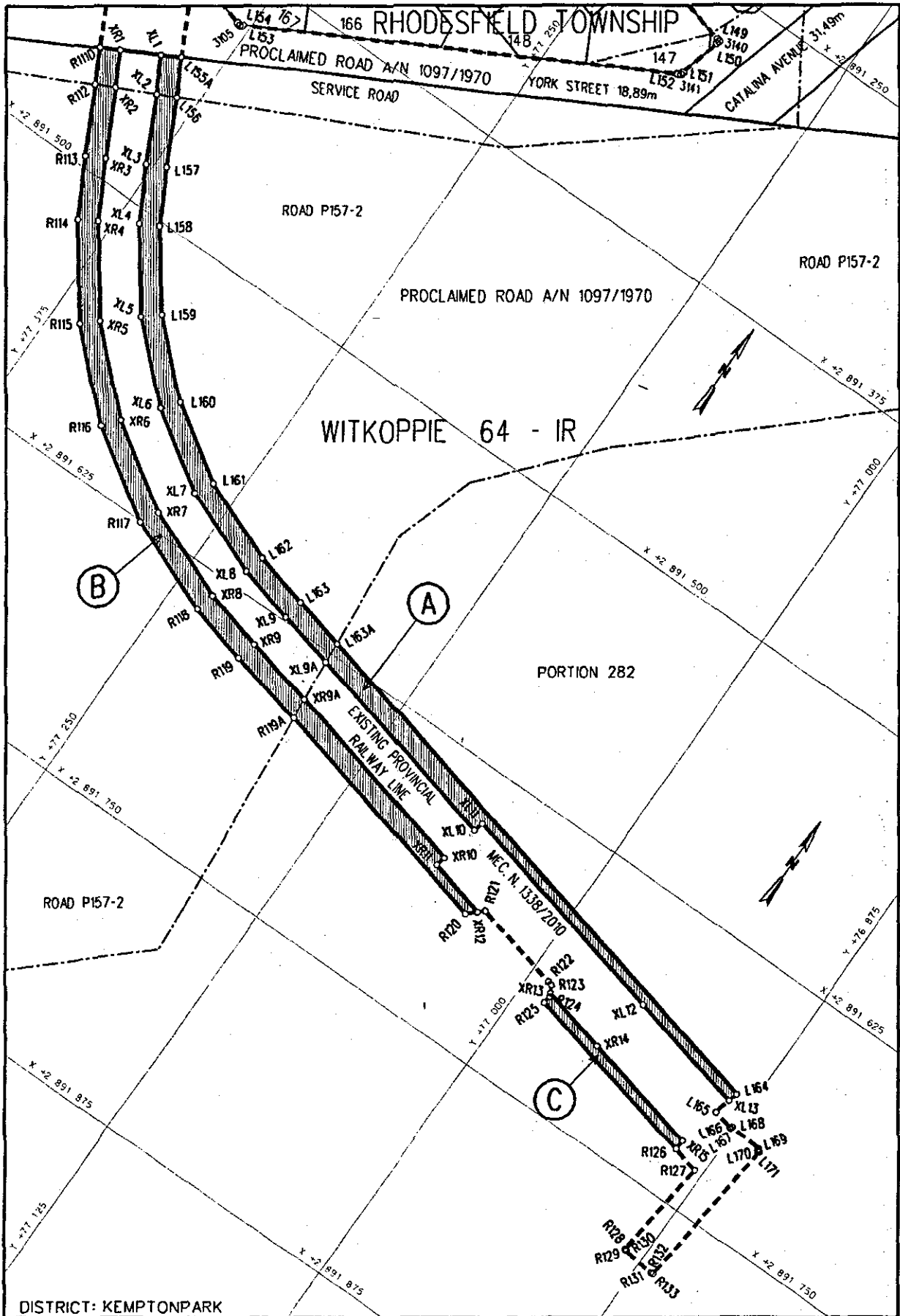

REFERENCE

PROCLAMATION OF THE REDUCTION OF THE WIDTH OF RAILWAY LINE

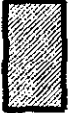

THE FIGURES : (A) L155A, L156 - L164, XL13 - XL1, L155A.
 (B) R111D, XR1 - XR12, R120 - R112, R111D.
 (C) R125, R124, XR13 - XR15, R126, R125.

REPRESENT THE PROCLAMATION OF THE REDUCTION OF THE WIDTH OF THE RAILWAY LINE OVER PORTION 282 OF THE FARM WITKOPPIE 64-IR AS INTENDED BY THE PUBLICATION THEREOF IN THE PROVINCIAL GAZETTE AND SHOWN IN DETAIL ON PLAN GRP 03/38/18Exp.

BUNDEL NR. / FILE 2/11/78-GAUTRAIN

CO-ORDINATE LIST WG 29° CONST. Y = +/- 0.00 X = +2 800 000.00

L155A	+77393.794	+91429.504	R117	+77281.250	+91625.390	XL7	+77267.431	+91598.712
L156	+77384.900	+91446.760	R118	+77234.400	+91644.360	XL8	+77225.512	+91615.687
L157	+77369.430	+91476.810	R119	+77204.200	+91652.150	XL9	+77197.203	+91622.975
L158	+77355.740	+91502.160	R119A	+77165.613	+91661.272	XL9A	+77168.368	+91629.793
L159	+77330.430	+91537.010	R120	+77042.257	+91690.438	XL10	+77061.786	+91654.995
L160	+77299.110	+91566.590	R121	+77035.089	+91683.729	XL11	+77060.636	+91650.129
L161	+77262.850	+91589.870	R122	+76990.243	+91694.163	XL12	+76946.271	+91677.170
L162	+77222.900	+91606.050	R123	+76988.207	+91694.983	XL13	+76884.735	+91691.720
L163	+77195.000	+91613.220	R124	+76985.542	+91700.025			
L163A	+77169.267	+91619.300	R125	+76986.398	+91703.646	XR1	+77420.094	+91443.768
L164	+76883.590	+91686.850	R126	+76892.790	+91725.780	XR2	+77411.744	+91460.047
L165	+76886.660	+91699.860	R127	+76879.390	+91728.950	XR3	+77396.055	+91490.633
L166	+76876.680	+91702.220	R128	+76884.540	+91779.850	XR4	+77381.427	+91517.701
L167	+76875.940	+91702.320	R129	+76883.780	+91779.960	XR5	+77352.937	+91556.848
L168	+76875.790	+91701.320	R130	+76883.790	+91780.410	XR6	+77317.617	+91590.257
L169	+76859.490	+91703.030	R131	+76867.520	+91782.110	XR7	+77276.667	+91616.550
L170	+76859.550	+91704.040	R132	+76867.430	+91781.670	XR8	+77231.786	+91634.723
L171	+76858.570	+91704.150	R133	+76866.400	+91781.760	XR9	+77201.998	+91642.393
						XR9A	+77166.531	+91650.779
R111D	+77428.809	+91448.494	XL1	+77402.509	+91434.230	XR10	+77066.388	+91674.458
R112	+77420.650	+91464.460	XL2	+77393.818	+91451.173	XR11	+77067.539	+91679.324
R113	+77404.990	+91495.130	XL3	+77378.357	+91481.313	XR12	+77037.870	+91686.339
R114	+77390.750	+91522.560	XL4	+77364.463	+91507.023	XR13	+76986.335	+91698.524
R115	+77360.480	+91563.420	XL5	+77337.910	+91543.586	XR14	+76953.174	+91706.365
R116	+77323.750	+91598.100	XL6	+77305.241	+91574.435	XR15	+76892.596	+91720.689

