CONTENTS • INHOUD

<i>No.</i>	<i>Page No.</i>	<i>Gazette No.</i>
GENERAL NOTICES		
3694 Gauteng Transport Infrastructure Act, 2001: Proposed taking over by Plumari Game Ranch of Provincial Road 465 between Provincial Roads P1213-1 and 99, District Krugersdorp	3	276
3695 do.: Proposed deviation of a portion of Provincial Road 766: District Vereeniging	5	276

GENERAL NOTICES

NOTICE 3694 OF 2008

PROPOSED TAKING OVER BY PLUMARI GAME RANCH OF PROVINCIAL ROAD 465 BETWEEN PROVINCIAL ROADS P123-1 AND 99, DISTRICT KRUGERSDORP

It is hereby notified for general information that an application has been received from Plumari Game Ranch in terms of section 51(2)(a) of the Gauteng Transport Infrastructure Act, 2001 to conclude an agreement with the MEC to take over all responsibilities for or in relation to provincial road 465 between provincial roads P123-1 and 99, District Krugersdorp, as depicted on the accompanying sketch plan, inter alia, on condition that the road stays open as a public road subject to certain access control measures.

Interested persons are called upon to, within 30 days from the date of this notice, submit written comments or objections, with reasons, in the above regard for consideration by the MEC, to the Head : Department of Public Transport, Roads and Works, (Attention : Director Design) 41 Simmonds Street, Sage Life Building, Johannesburg, (Private Bag X83 Marshalltown, 2107).

Reference : 2/1/1/2/3/1-465

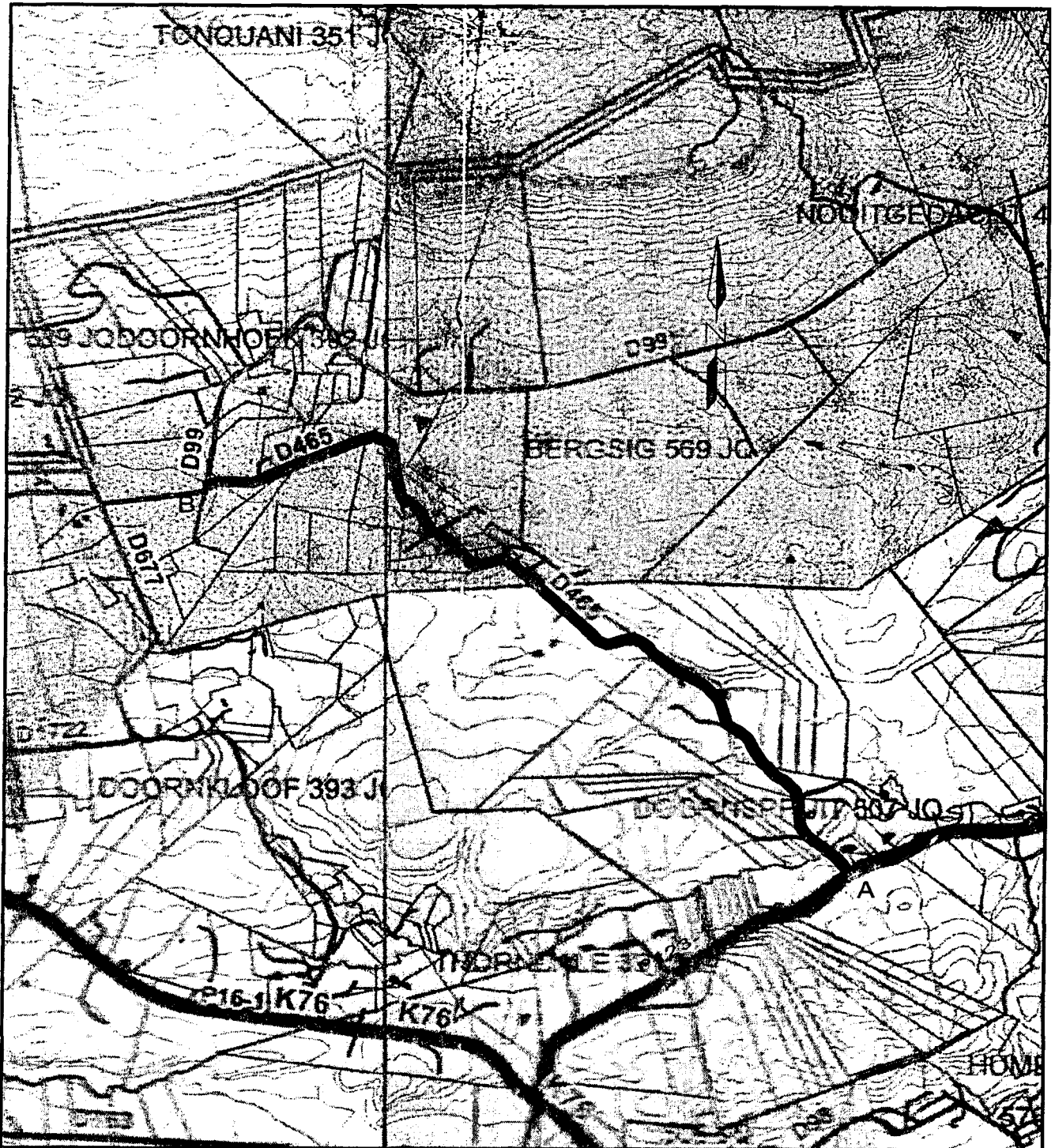

VERWYSING / REFERENCE

PROPOSED TAKING OVER OF ROAD



THE LINE : A - B

REPRESENTS THE PROPOSED TAKING OVER OF PROVINCIAL ROAD 465 AS
CONTEMPLATED BY THE PUBLICATION THEREOF IN THE PROVINCIAL GAZETTE

FILE NO. 2/1/1/2/3/1-465

NOTICE 3695 OF 2008**PROPOSED DEVIATION OF A PORTION OF PROVINCIAL ROAD 766 : DISTRICT VEREENIGING**

It is hereby notified for general information that an application has been received in terms of section 38 of the Gauteng Transport Infrastructure Act, 2001 (Act No. 8 of 2001) for the deviation and resultant closure of a portion of provincial road 766 over Portion 29 of the farm Waterval 150 IR, District Vereeniging, as indicated on the accompanying sketch plan.

Any interested person is called upon to submit written comments or objections, with reasons, within 30 days from the date of this notice to the Head : Department of Public Transport, Roads and Works, Private Bag X83 Marshalltown, 2107 (Attention : Director Design) for consideration and decision by the MEC.

Reference : 2/1/1/2/3/1-766

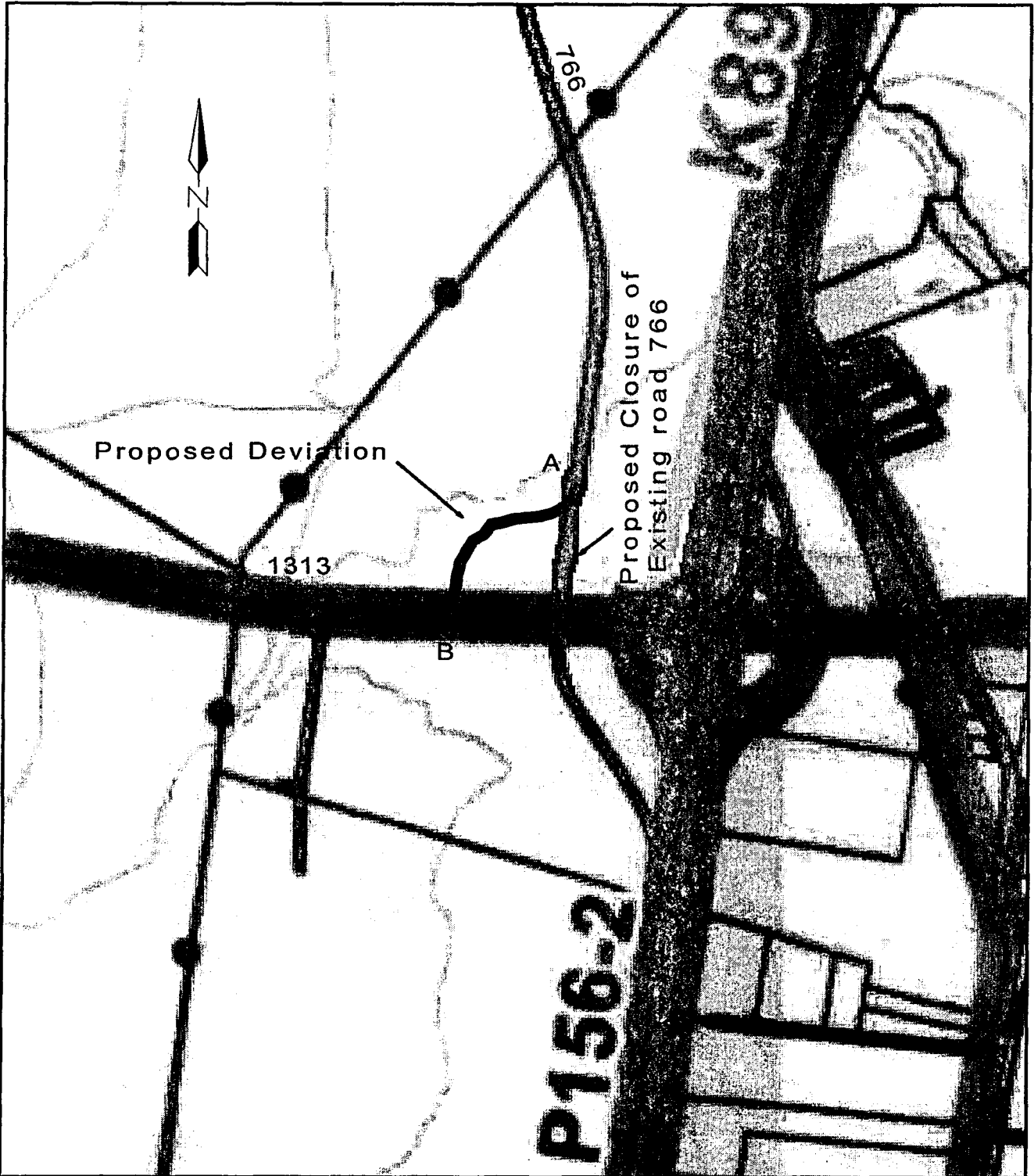

REFERENCE

PROPOSED ROAD DEVIATION 

THE LINE : A - B
REPRESENTS THE PROPOSED DEVIATION OF A PORTION OF PROVINCIAL
ROAD 766 AS CONTEMPLATED BY THE PUBLICATION THEREOF IN THE
PROVINCIAL GAZETTE

FILE NO. 2/1/1/2/3/1-766



land affairs

Department:
Land Affairs
REPUBLIC OF SOUTH AFRICA

Surveys & Mapping

Surveys and Mapping is South Africa's national survey and mapping organisation providing survey, mapping and geo-spatial products and services to the public and private sectors for over 80 years

Products and Services

- * Maps - Topographical, Topo-cadastral, Orthophoto, Wall maps, Aeronautical charts, Provincial maps
- * Digital Maps, elevation models, images
- * GPS Base Station data - TrigNet
- * Other geodetic survey information
- * Aerial Photography - from 1936 to present day
- * Professional advice in the fields of surveys and mapping
- * Career information and promotions
- * Workshops on the use of mapping products
- * Support to the land reform programmes

Contact details

<http://w3sli.wcape.gov.za>

Tel: (021) 658 4300

Email: cdsm@sli.wcape.gov.za

