

CONTENTS**INHOUD**

<i>No.</i>	<i>Page No.</i>	<i>Gazette No.</i>	<i>No.</i>	<i>Bladsy No.</i>	<i>Koerant No.</i>
GOVERNMENT NOTICE			GOEWERMENSKENNISGEWING		
Transport, Department of			Vervoer, Departement van		
<i>Government Notice</i>			<i>Goewermentskennisgewing</i>		
980			980		
South African National Roads Agency Limited and the National Roads Act (7/1998): The South African National Roads Agency Limited: Declaration amendment of National Road N4 Section 8X.....			Suid-Afrikaanse Nasionale Padagentskap Beperk en die Nasionale Paaie Wet (7/1998): Die Suid-Afrikaanse Nasionale Padagentskap Beperk: Verklaring wysiging van Nasionale Pad N4 Seksie 8X...		
	3	31424		4	31424

**GOVERNMENT NOTICE
GOEWERMENTSKENNISGEWING**

**DEPARTMENT OF TRANSPORT
DEPARTEMENT VAN VERVOER**

No. 980

22 September 2008

**THE SOUTH AFRICAN NATIONAL ROADS
AGENCY LIMITED**

Registration No: 98/09584/06

DECLARATION AMENDMENT OF NATIONAL ROAD N4 SECTION 8X

AMENDMENT OF DECLARATION NO. 652 OF 1997.

By virtue of section 40 (1)(b) of the South African National Roads Agency Limited and the National Roads Act, 1998 (Act No. 7 of 1998), I hereby amend Declaration No. 652 of 1997 by substituting it, with the subjoined sheets 1 to 21 of Plan No. P640/08.

(National Road N4 Section 8X: Kaapmulden – Komatipoort)



MINISTER OF TRANSPORT

No. 980

22 September 2008

**DIE SUID-AFRIKAANSE NASIONALE
PADAGENTSKAP BEPERK**

Registrasie No: 98/09584/06

VERKLARING WYSIGING VAN NASIONALE PAD N4 SEKSIE 8X

WYSIGING VAN VERKLARING NO'S. 652 VAN 1997

Kragtens Artikel 40(1)(b) van die Suid-Afrikaanse Nasionale Padagentskap Beperk en die Nasionale Paaie Wet, 1998 (Wet No.7 van 1998), wysig ek hiermee Verklaring 652 van 1997 deur dit te vervang, met meegaande velle 1 tot 21 van Plan no. P640/08.

(Nasionale Pad N4 Seksie 8X: Kaapmuiden – Komatipoort)



MINISTER VAN VERVOER

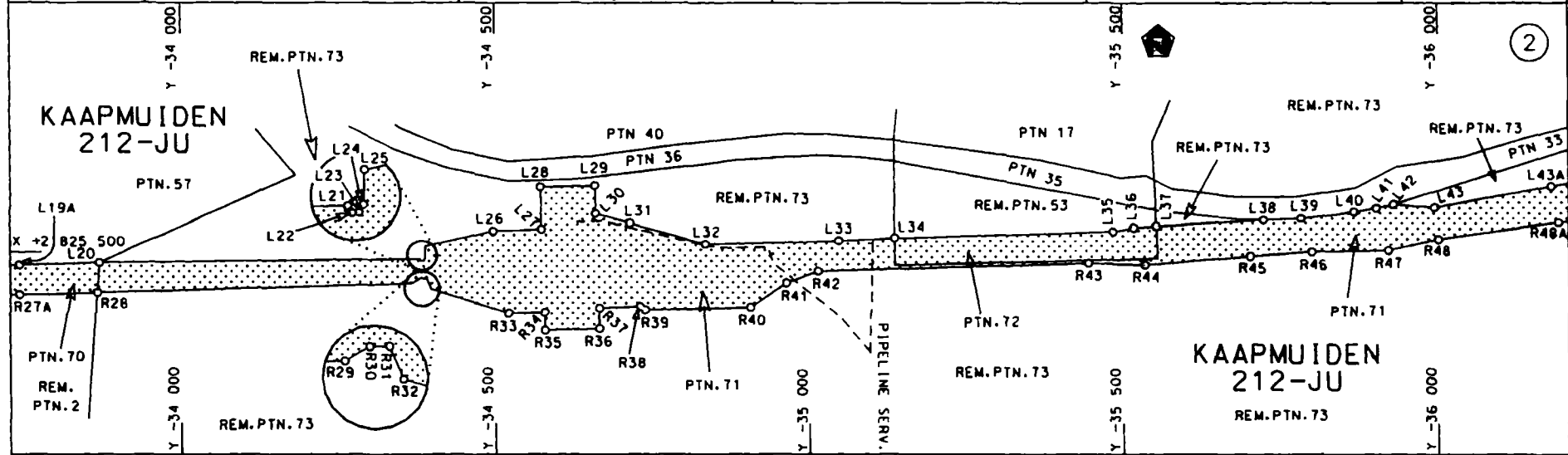
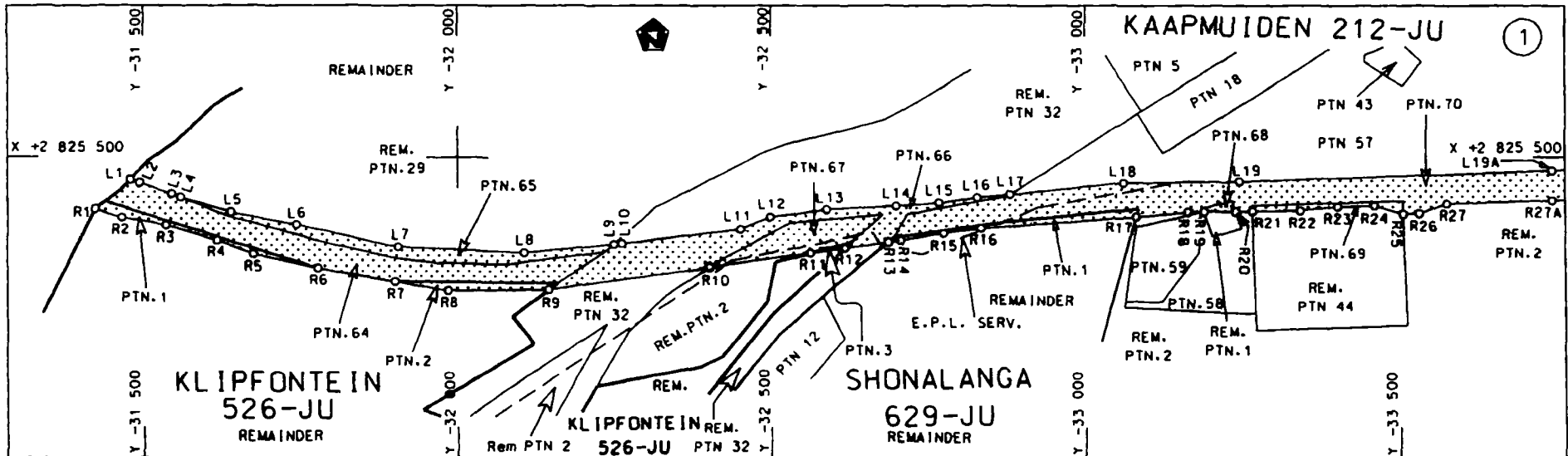

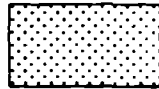
<p>Die Suid Afrikaanse Nasionale Podagentskap Beperk The South African National Roads Agency Limited</p>	<p>Die figuur getoon The figure shown</p> 	<p>steldie padreserwe voor van 'n gedeelte represents the road reserve of a portion van Nasionale Roete N4 Seksie of National Route Section 8x</p>	<p>Vel Sheet 1 van 21 Plan P640/08</p>
--	--	--	--

D.O.9.A

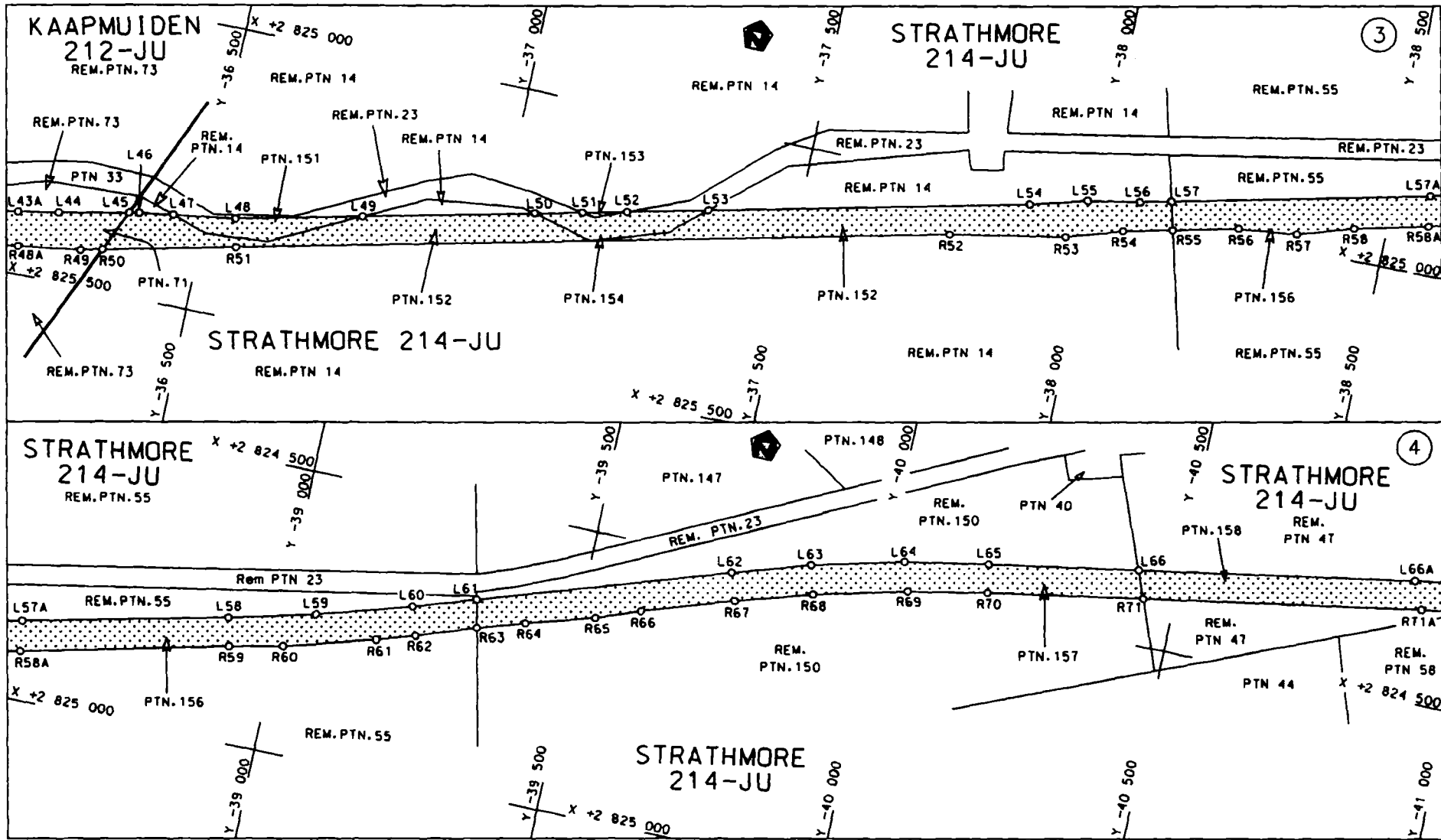

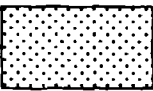
<p>Die Suid Afrikaanse Nasionale Padagentskap Beperk The South African National Roads Agency Limited</p>	<p>Die figuur getoon The figure shown</p> 	<p>steldie padreserwe voor van 'n gedeelte represents the road reserve of a portion van Nasionale Roete N4 Seksie 8x of National Route N4 Sektion</p>	<p>Vel Sheet 2 van of 21 Plan P640/08</p>
--	--	---	---

D.O.9.A

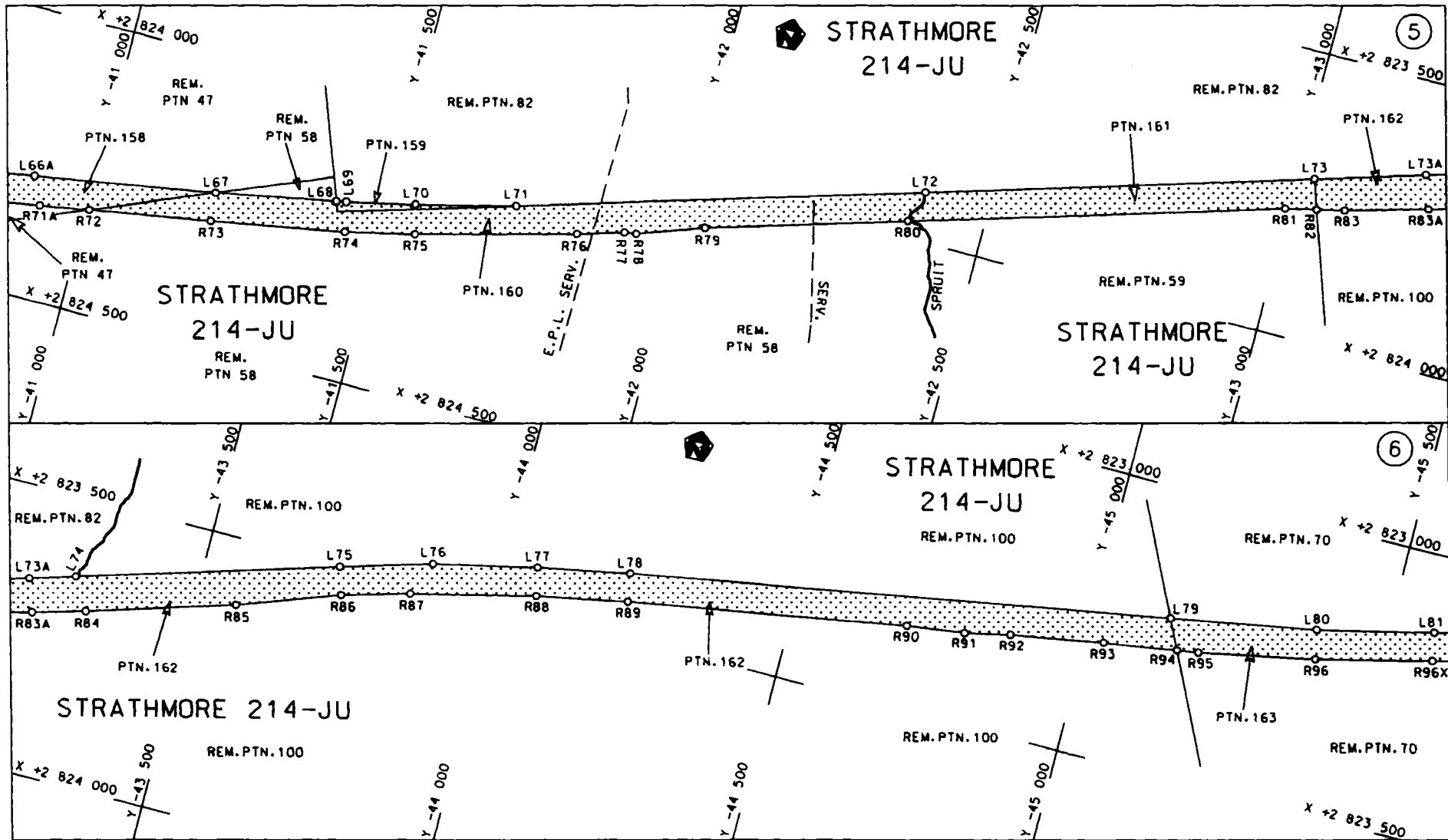

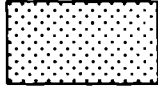
Die Suid Afrikaanse Nasionale Padagentskap Beperk The South African National Roads Agency Limited	Die figuur getoon The figure shown	 stel die padreserwe voor van 'n gedeelte represents the road reserve of a portion van Nasionale Roete N4 Sektie of National Route N4 Section	Vel Sheet 3 van of 21 Plan P640/08
--	---------------------------------------	--	--

D.O.9.A

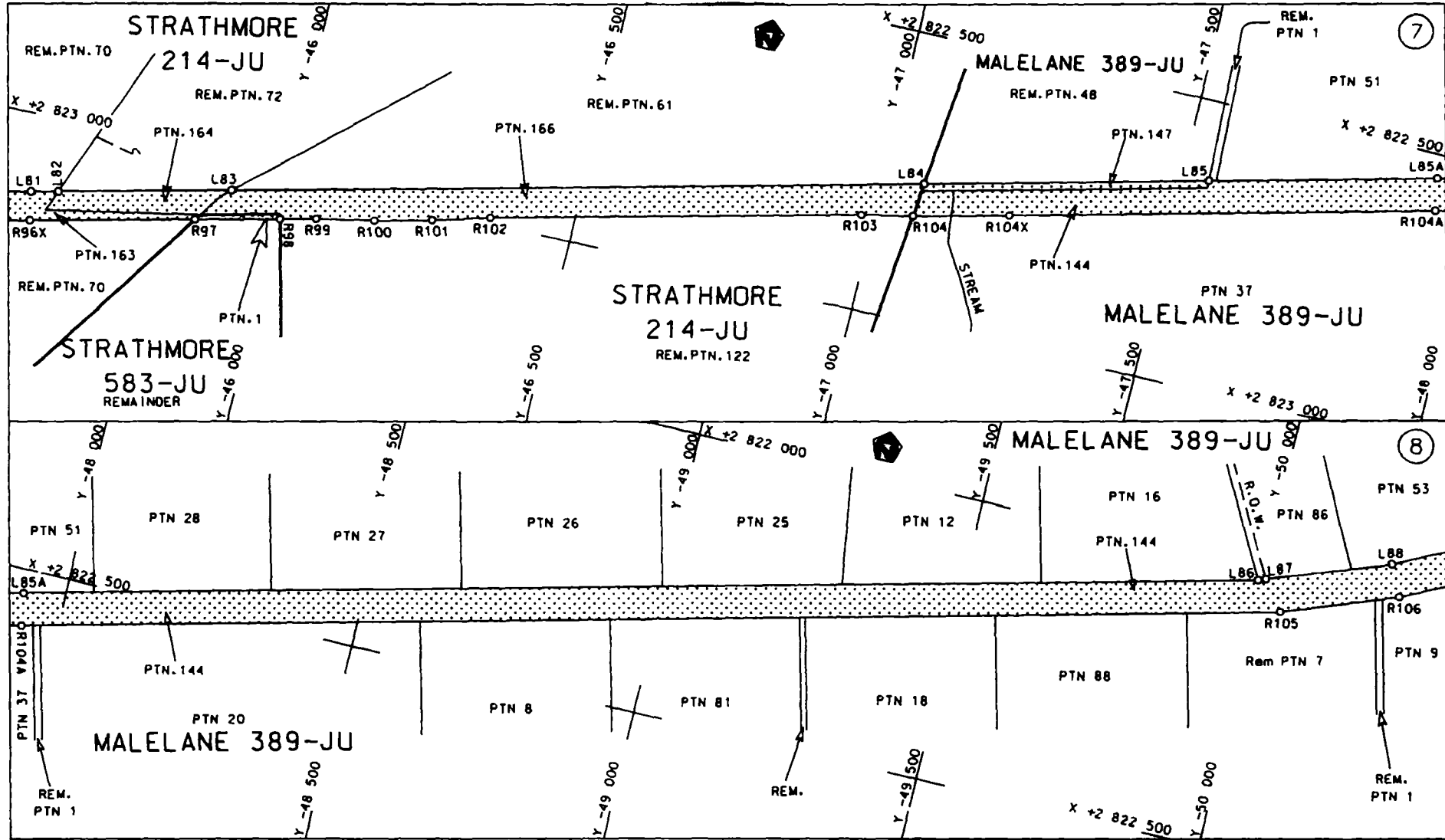

Die Suid Afrikaanse Nasionale Padagentskap Beperk
The South African National Roads Agency Limited

Die figuur getoon
The figure shown

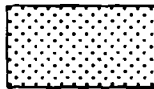

steldie padreserwe voor van 'n gedeelte
represents the road reserve of a portion
van Nasionale Roete N4
of National Route N4
Seksie Section
8x

Vel
Sheet 4 van
of 21

Plan
P640/08

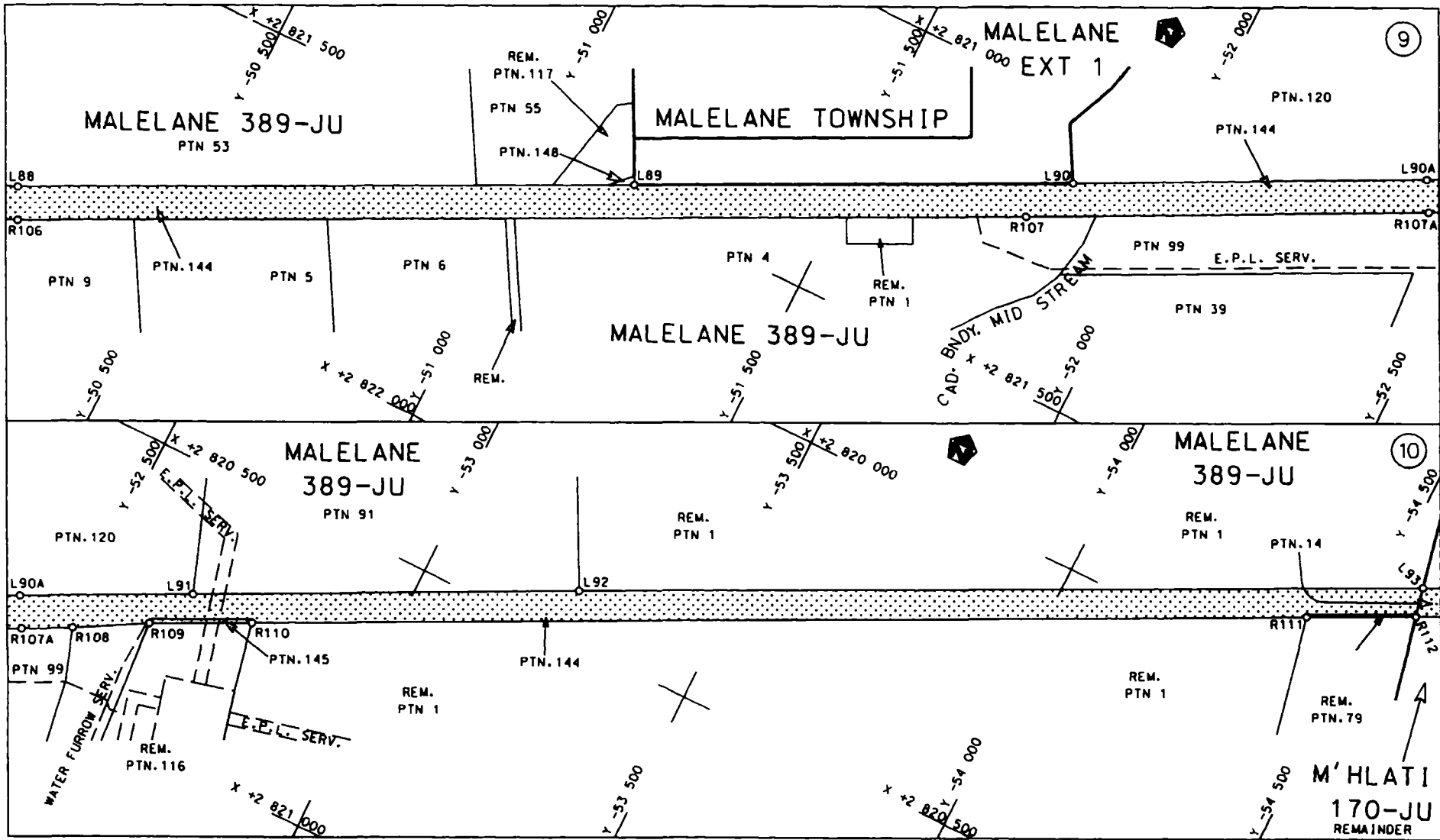

Die Suid Afrikaanse Nasionale Podagentskap Beperk The South African National Roads Agency Limited	Die figuur getoon The figure shown		steldie padreserwe voor van 'n gedeelte represents the road reserve of a portion van Nasionale Roete N4 Sektie 8x of National Route Section	Vel Sheet 5 van 21 Plan P640/08
--	---------------------------------------	--	--	------------------------------------

D.O.9.A

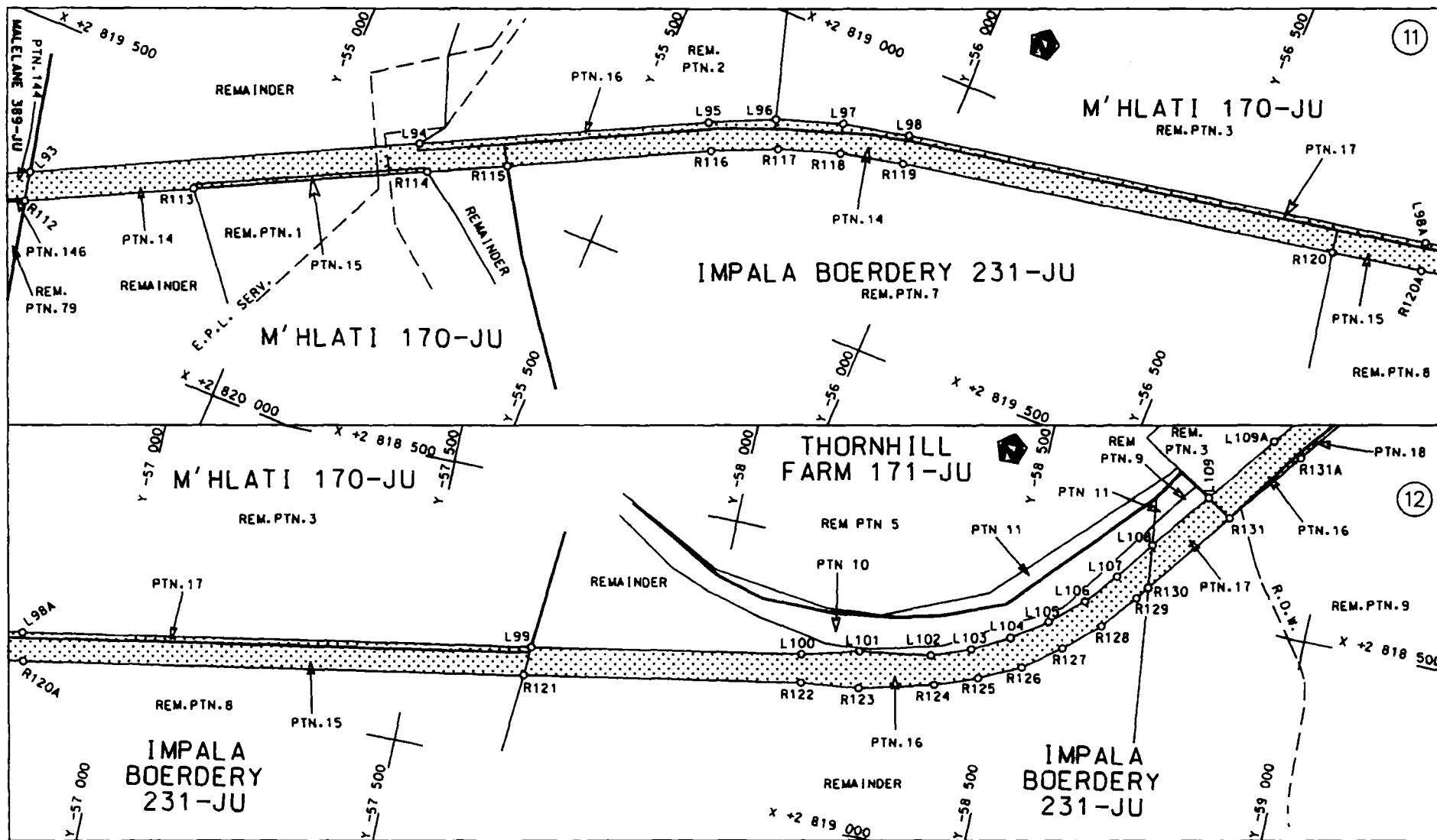

Die Suid Afrikaanse Nasionale Padagentskap Beperk
 The South African National Roads Agency Limited

Die figuur getoon
 The figure shown

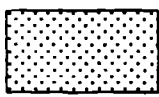

steldie padreserwe voor van 'n gedeelte
 represents the road reserve of a portion
 van Nasionale Roete N4 Sektie
 of National Route N4 Section 8x

Vel Sheet 6 von
 of 21
 Plan P640/08

D.O.9.A

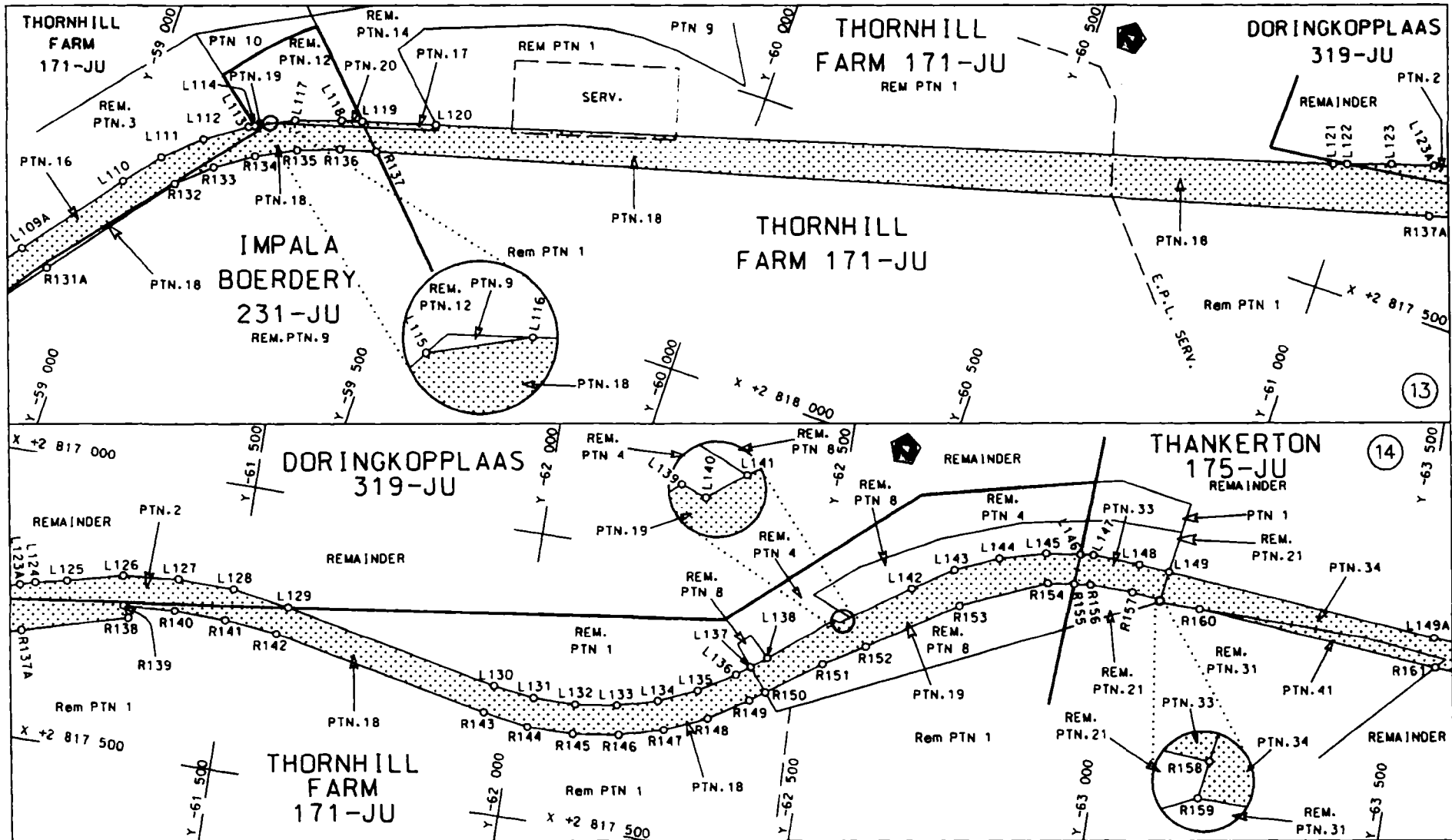

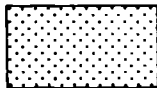
Die Suid Afrikaanse Nasionale Padagentskap Beperk The South African National Roads Agency Limited	Die figuur getoon The figure shown	 steldie padreserwe voor van 'n gedeelte represents the road reserve of a portion van Nasionale Roete N4 Seksie of National Route N4 Section 8x	Vel Sheet 7 van 21 Plan P640/08
--	---------------------------------------	--	------------------------------------

D.O.9.A

STAATSKOERANT, 22 SEPTEMBER 2008

No. 31424 11

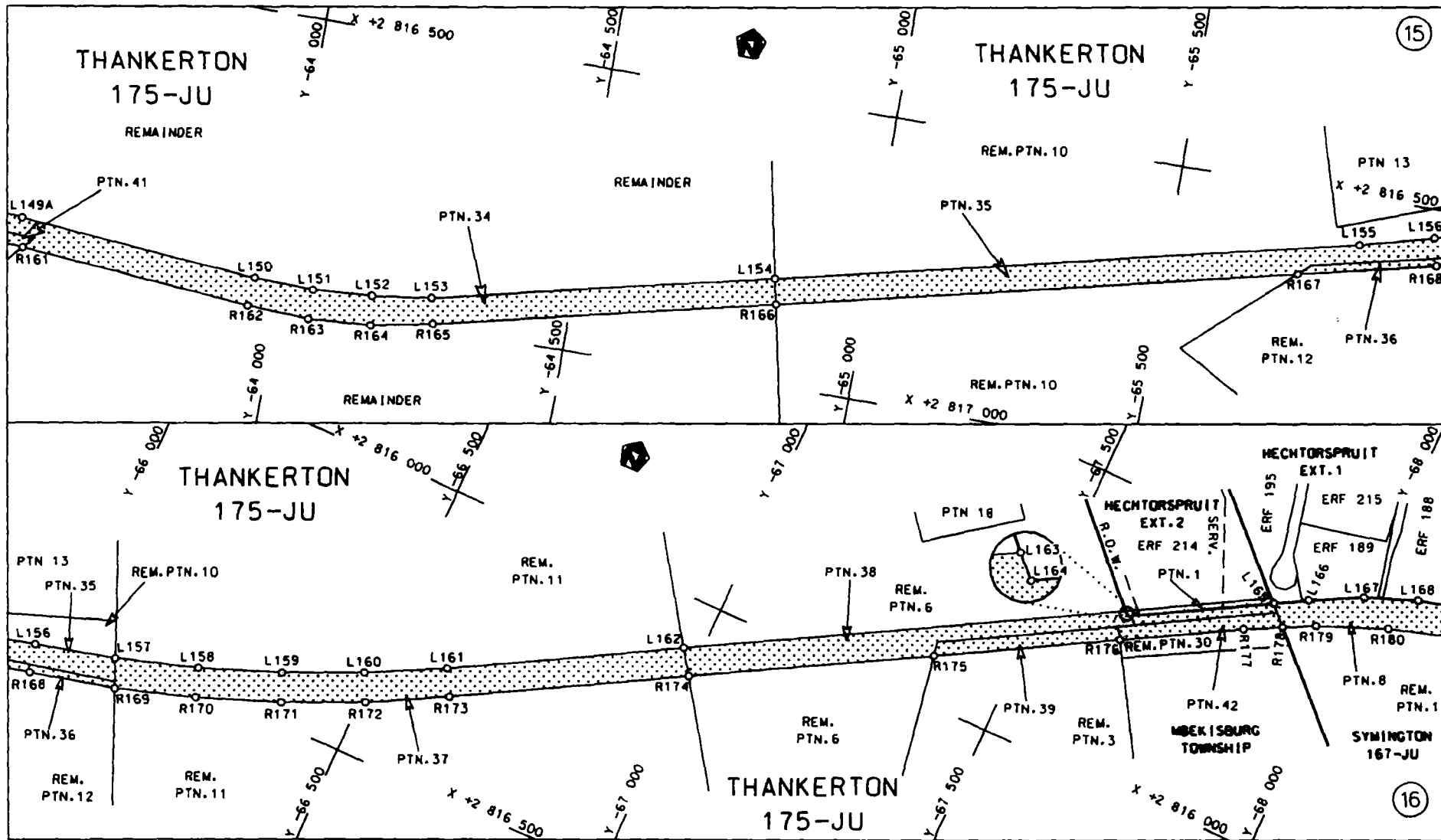

<p>Die Suid Afrikaanse Nasionale Padogenskap Beperk The South African National Roads Agency Limited</p>	<p>Die figuur getoon The figure shown</p>		<p>stel die padreserwe voor van 'n gedeelte represents the road reserve of a portion van Nasionale Roete N4 Seksie 8x of National Route Section</p>	<p>Vel Sheet 8 of 21 Plan P640/08</p>
---	---	--	---	---

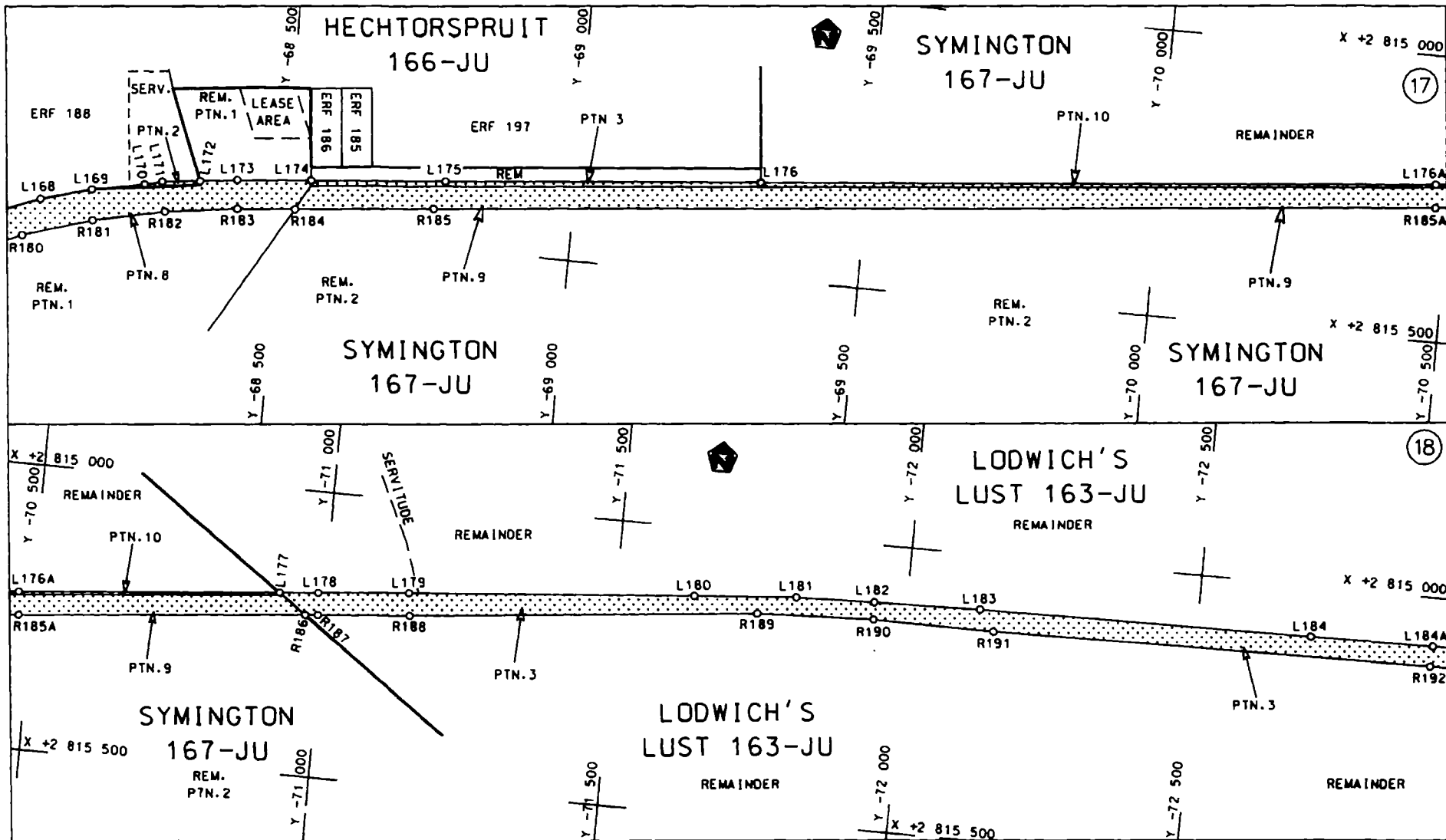

<p>Die Suid Afrikaanse Nasionale Podagentskap Beperk The South African National Roads Agency Limited</p>	<p>Die figuur getoon The figure shown</p>	<p>stelt die padreserwe voor van 'n gedeelte represents the road reserve of a portion van Nasionale Roete N4 Sektie 8x of National Route Section</p>	<p>Vel Sheet 9 van 21 Plan P640/08</p>
--	---	--	--

D.O.9.A

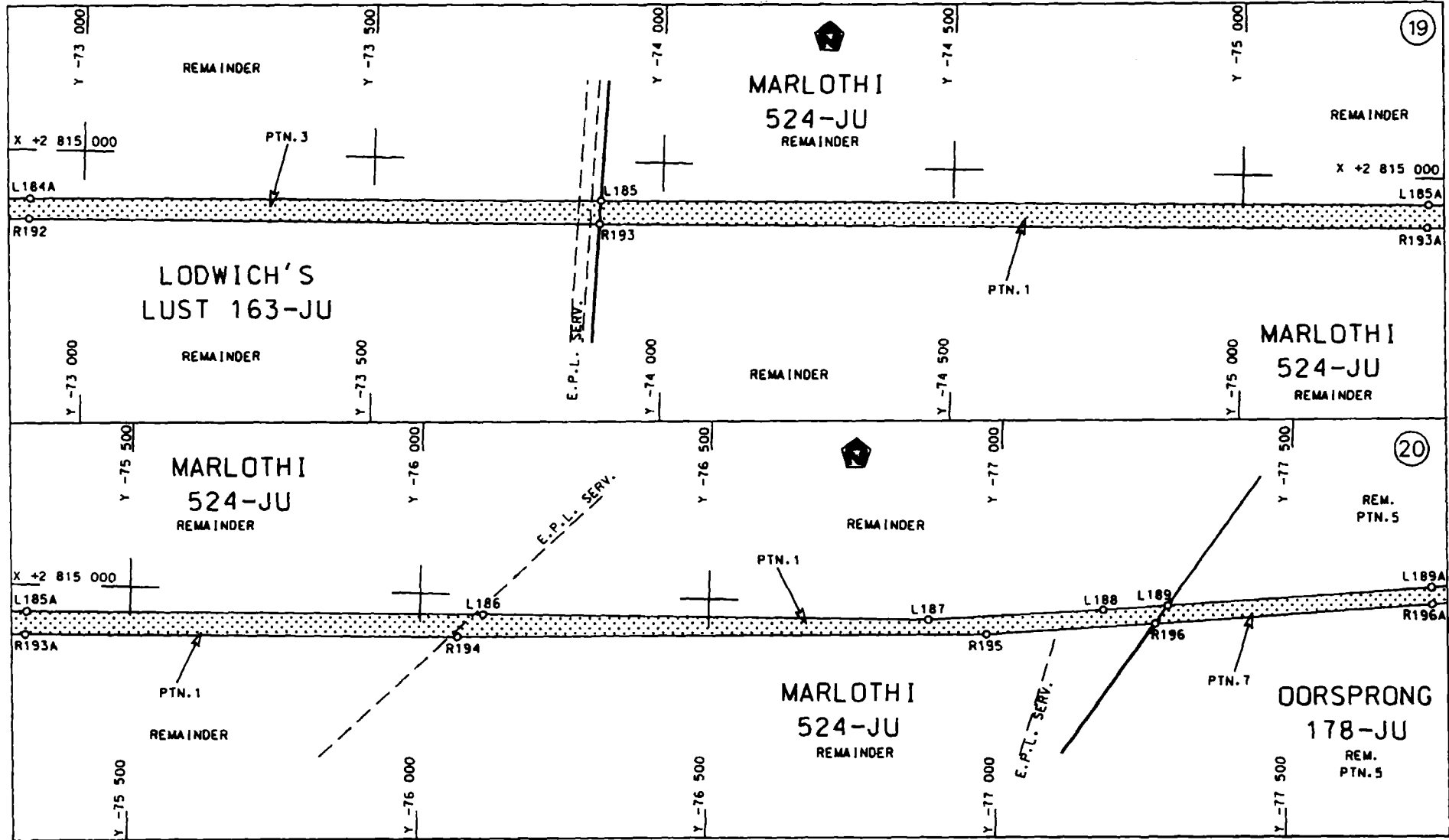

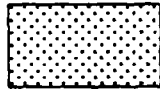
<p>Die Suid Afrikaanse Nasionale Padagentskap Beperk The South African National Roads Agency Limited</p>	<p>Die figuur getoon The figure shown</p> 	<p>steldie padreserwe voor van 'n gedeelte represents the road reserve of a portion van Nasionale Roete N4 Seksie of National Route Section 8x</p>	<p>Vel Sheet 10 van 21 Plan P640/08</p>
--	--	--	---

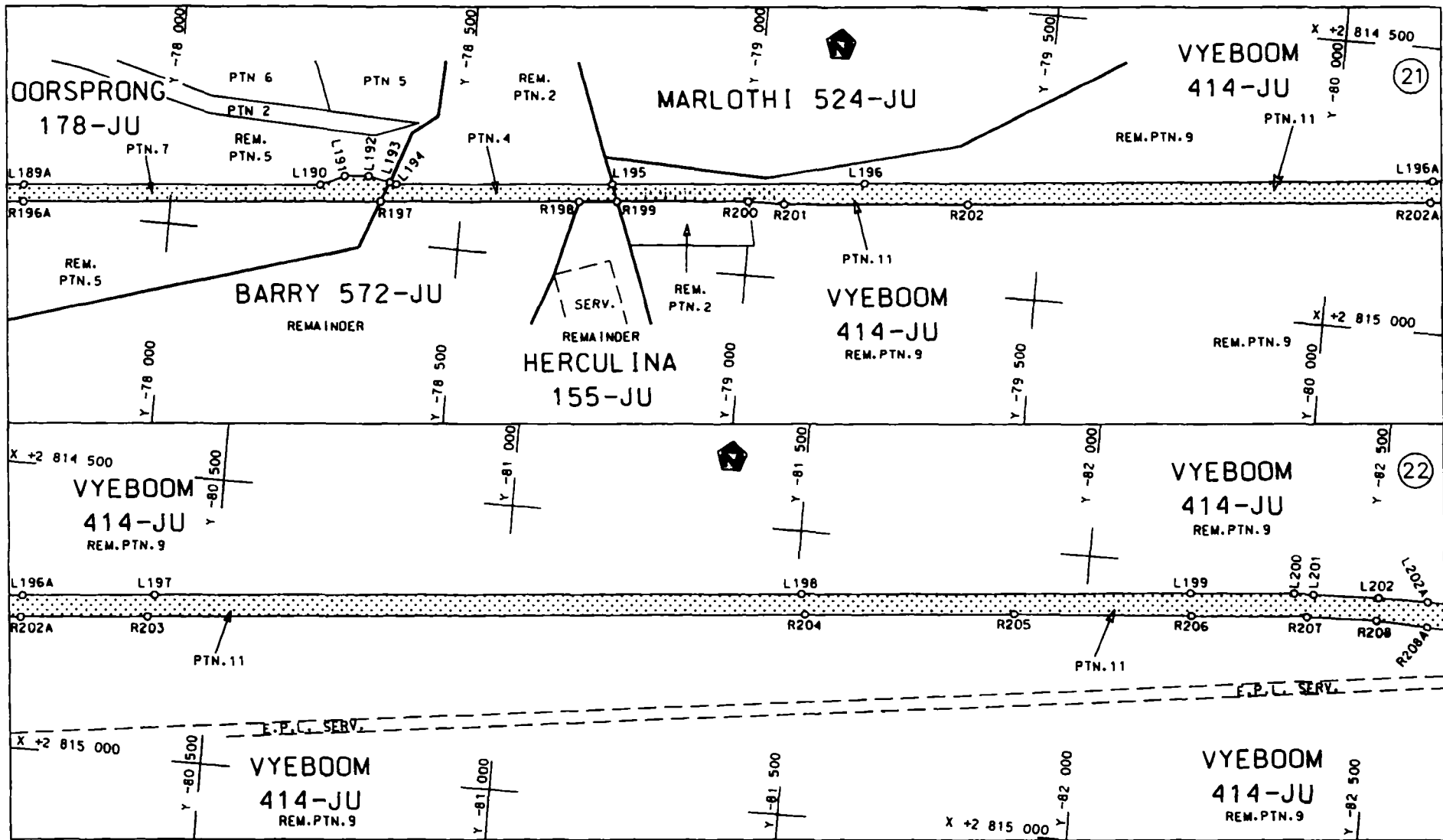

Die Suid Afrikaanse Nasionale Padagentskap Beperk
The South African National Roads Agency Limited

Die figuur getoon
The figure shown

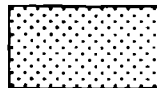

steldie padreserwe voor van 'n gedeelte
represents the road reserve of a portion
van Nasionale Roete N4 Seksie
of National Route Section

8x

Vel Sheet 11 van 21
Plan P640/08

D.O.9.A

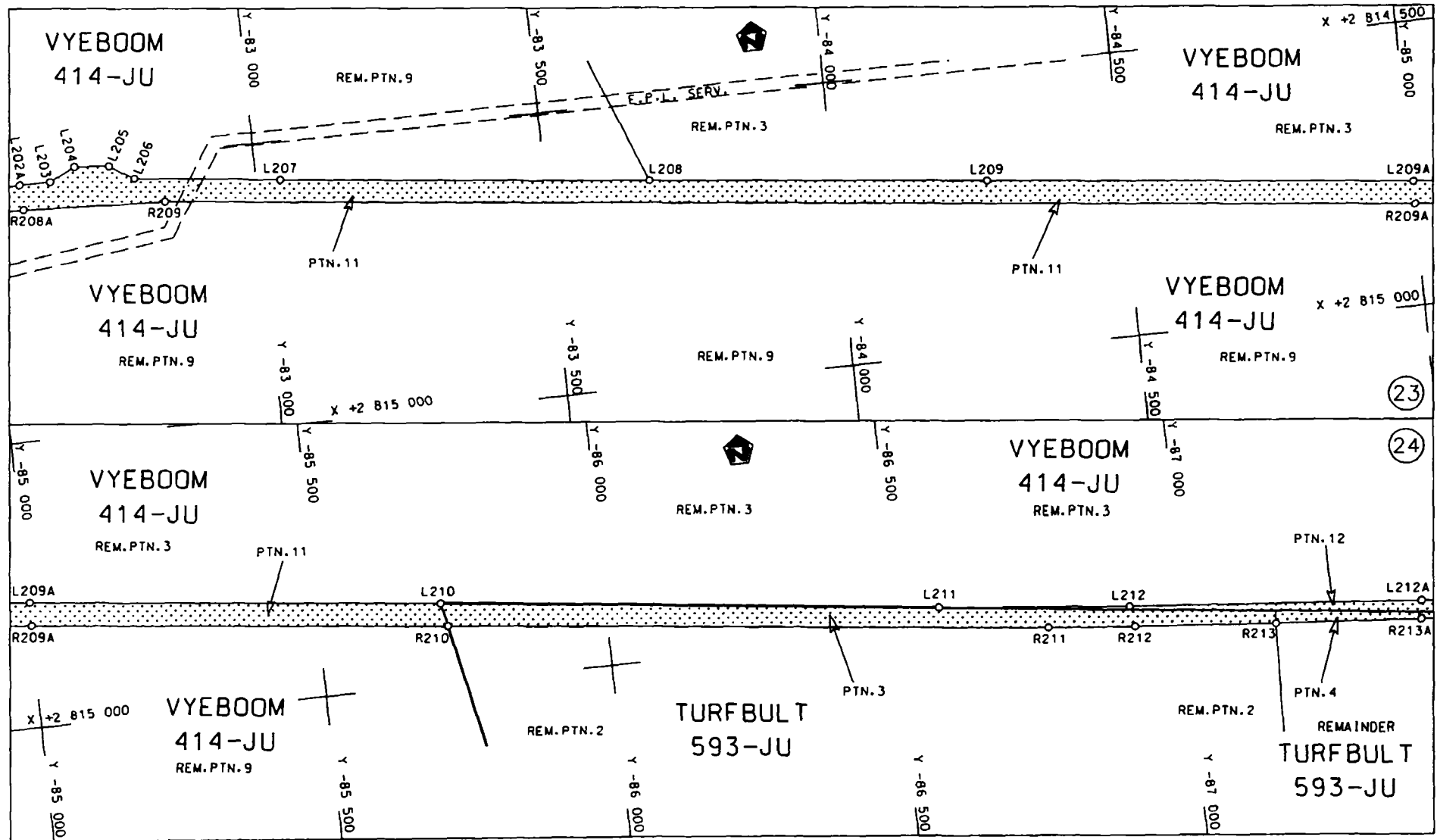

Die Suid Afrikaanse Nasionale Padogentskap Beperk
The South African National Roads Agency Limited

Die figuur getoon
The figure shown

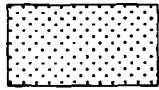

steldie podreserve voor von 'n gedeelte
represents the road reserve of a portion
von Nasionale Roete N4 Seksie 8x
of National Route Section

Vel Sheet 12 van of 21
Plan P640/08

D.O.9.A

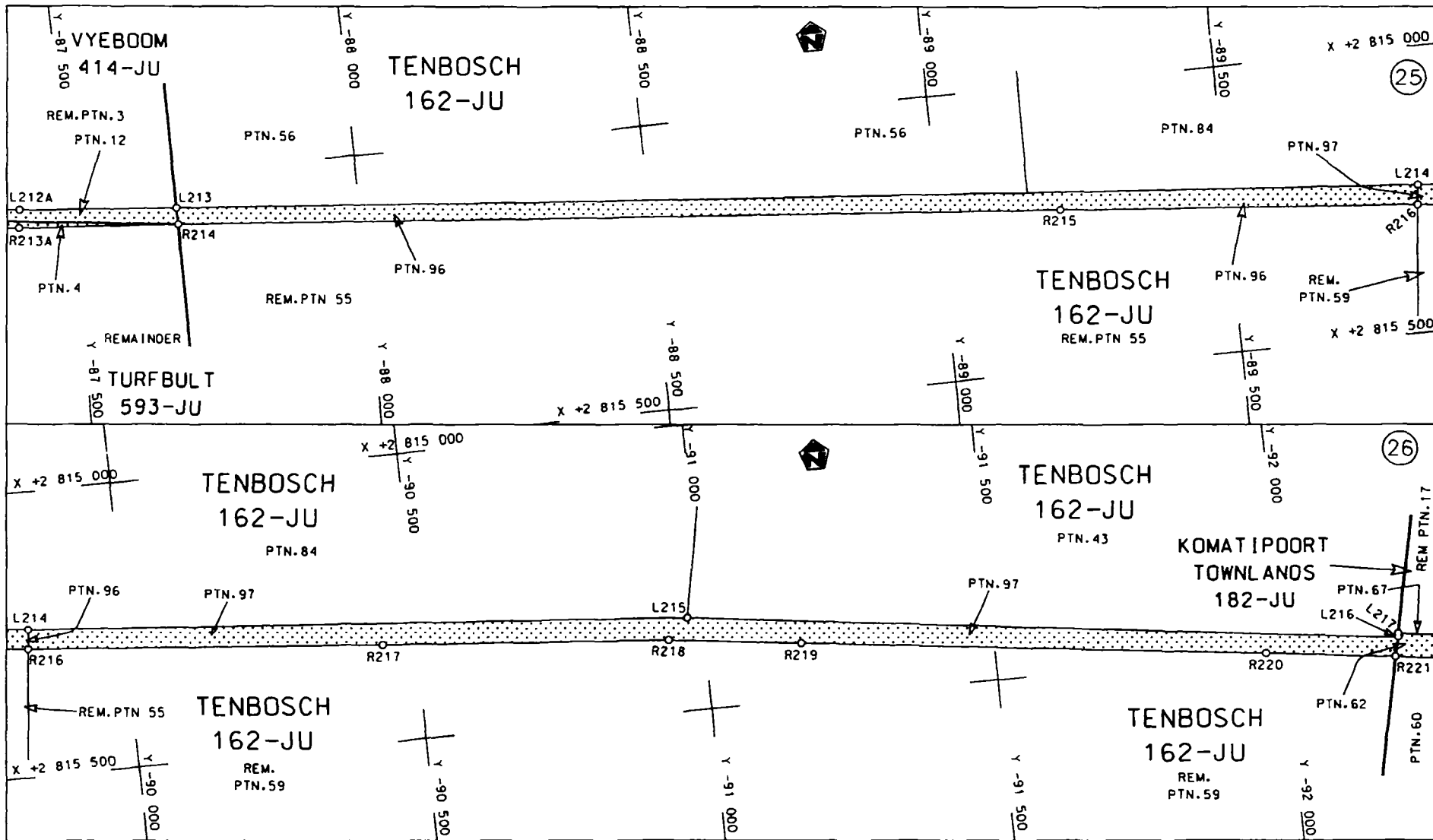

STAATSKOERANT, 22 SEPTEMBER 2008

No. 31424 17

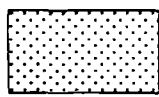
Die Suid Afrikaanse Nasionale Padagentskap Beperk The South African National Roads Agency Limited	Die figuur getoon The figure shown		Vel Sheet 13 van 21 Plon P640/08
steldie padreserwe voor van 'n gedeelte represents the road reserve of a portion van Nasionale Roete N4 Seksie 8x of National Route			

D.O.9.A

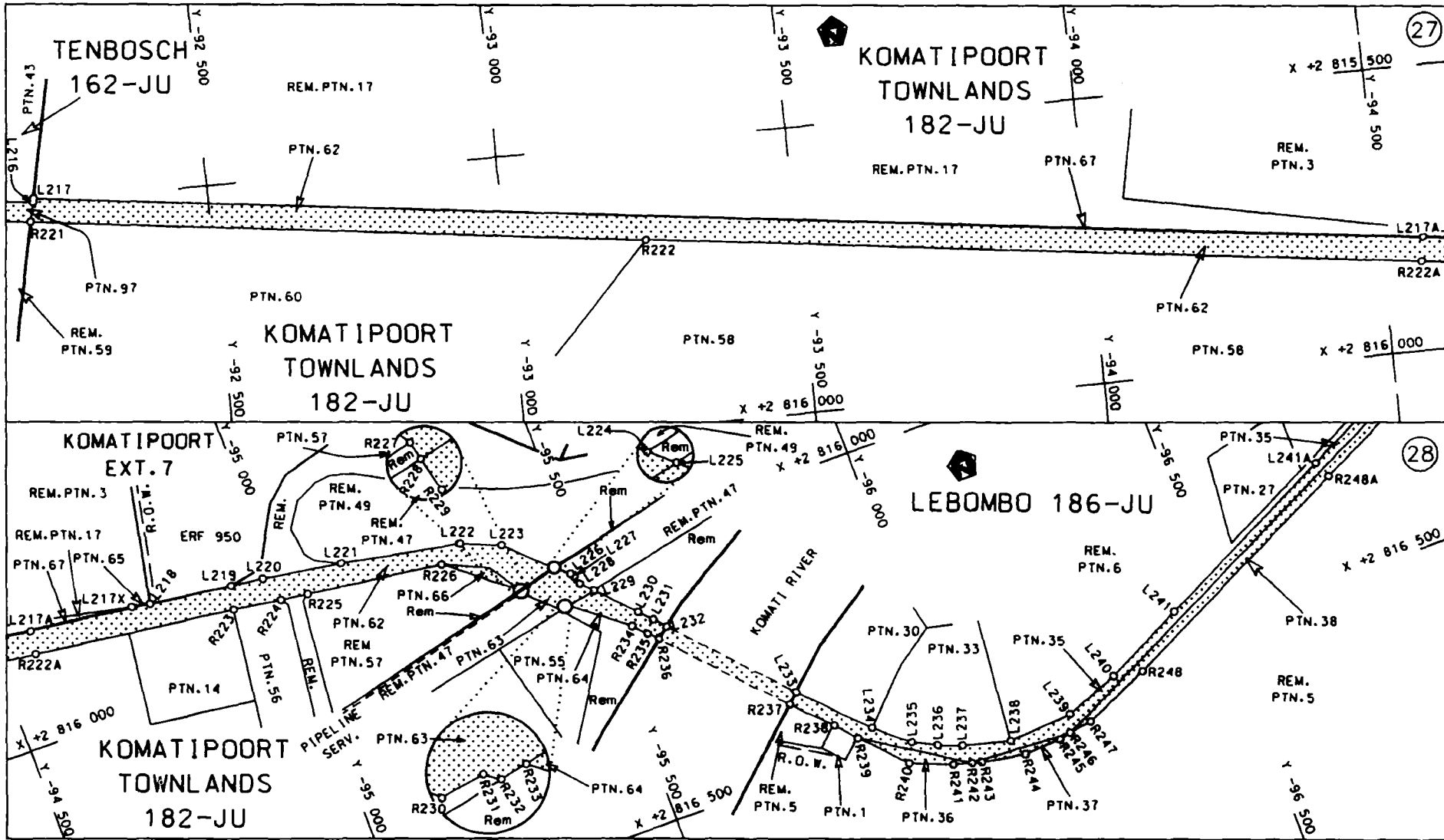

<p>Die Suid Afrikaanse Nasionale Padagentskap Beperk The South African National Roads Agency Limited</p>	<p>Die figuur getoon The figure shown</p>		<p>steldie padreserwe voor van 'n gedeelte represents the road reserve of a portion van Nasionale Roete N4 Seksie of Notional Route N4 Section</p>	<p>8x</p>	<p>Vel Sheet 14 von 21 of of Plan P640/08</p>
--	---	--	--	-----------	---

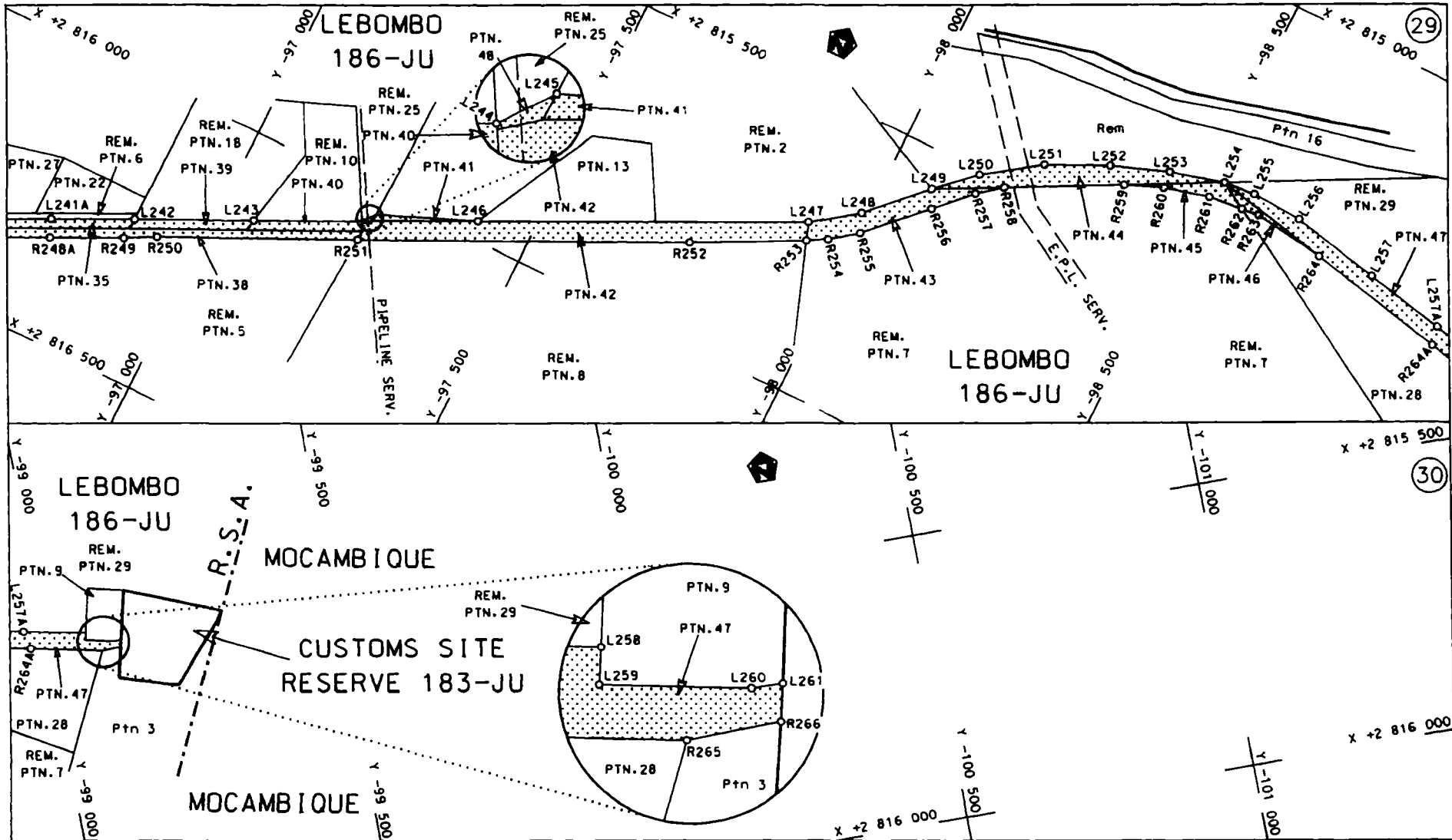

<p>Die Suid Afrikaanse Nasionale Padagentskop Bepark The South African National Roads Agency Limited</p>	<p>Die figuur getoon The figure shown</p>	<p>stiel die padreserwe voor van 'n gedeelte represents the road reserve of a portion van Nasionale Roete N4 Sektie of National Route Section</p>	<p>Vel Sheet 15 van of 21 Plan P640/08</p>
--	---	---	--

D.O.9.A

PADRESERWE KOÖRDINATE				/ ROAD RESERVE CO-ORDINATES			
LINKERKANT/LEFT HAND SIDE				REGTERKANT/RIGHT HAND SIDE			
	Y	X	WG 31°		Y	X	
L1	-31 478.855	2 825	536.478	R1	-31 422.590	2 825	583.660
L2	-31 493.750	2 825	541.600	R2	-31 465.040	2 825	597.740
L3	-31 544.530	2 825	559.060	R3	-31 535.280	2 825	609.760
L4	-31 558.880	2 825	564.740	R4	-31 617.780	2 825	634.070
L5	-31 639.510	2 825	588.310	R5	-31 675.310	2 825	656.830
L6	-31 743.040	2 825	608.960	R6	-31 777.200	2 825	678.920
L7	-31 905.090	2 825	644.400	R7	-31 899.770	2 825	700.980
L8	-32 106.280	2 825	654.120	R8	-31 984.490	2 825	715.670
L9	-32 250.050	2 825	639.760	R9	-32 144.840	2 825	714.010
L10	-32 262.540	2 825	638.500	R10	-32 401.790	2 825	677.210
L11	-32 450.870	2 825	615.510	R11	-32 562.690	2 825	654.050
L12	-32 498.590	2 825	595.450	R12	-32 617.375	2 825	646.183
L13	-32 587.740	2 825	583.270	R13	-32 686.280	2 825	636.270
L14	-32 698.050	2 825	578.000	R14	-32 705.790	2 825	633.390
L15	-32 766.540	2 825	572.490	R15	-32 773.450	2 825	621.990
L16	-32 827.820	2 825	564.170	R16	-32 833.950	2 825	614.040
L17	-32 879.950	2 825	558.860	R17	-33 081.450	2 825	595.080
L18	-33 061.420	2 825	540.330	R18	-33 162.920	2 825	587.920
L19	-33 244.440	2 825	538.380	R19	-33 189.110	2 825	587.540
L20	-33 869.730	2 825	516.720	R20	-33 238.240	2 825	586.850
L21	-34 379.180	2 825	510.050	R21	-33 264.220	2 825	586.480
L22	-34 381.860	2 825	513.940	R22	-33 341.180	2 825	585.440
L23	-34 385.320	2 825	513.780	R23	-33 401.020	2 825	579.590
L24	-34 387.500	2 825	509.390	R24	-33 459.670	2 825	577.540
L25	-34 388.040	2 825	490.610	R25	-33 505.240	2 825	591.390
L26	-34 497.340	2 825	464.860	R26	-33 530.070	2 825	590.430
L27	-34 574.220	2 825	462.130	R27	-33 574.630	2 825	574.070
L28	-34 572.320	2 825	393.880	R28	-33 866.100	2 825	565.250
L29	-34 659.790	2 825	391.260	R29	-34 366.580	2 825	549.770
L30	-34 661.280	2 825	436.290	R30	-34 379.630	2 825	541.910
L31	-34 715.470	2 825	452.200	R31	-34 390.130	2 825	541.810
L32	-34 835.320	2 825	486.810	R32	-34 397.530	2 825	559.500
L33	-35 047.110	2 825	480.620	R33	-34 521.310	2 825	598.140
L34	-35 135.440	2 825	476.110	R34	-34 578.760	2 825	596.970
L35	-35 484.250	2 825	465.490	R35	-34 579.360	2 825	625.660
L36	-35 517.400	2 825	459.350	R36	-34 666.930	2 825	622.780
L37	-35 552.930	2 825	457.080	R37	-34 666.230	2 825	589.770
L38	-35 722.360	2 825	446.350	R38	-34 730.610	2 825	587.390
L39	-35 782.200	2 825	444.050	R39	-34 738.570	2 825	592.990
L40	-35 866.810	2 825	433.000	R40	-34 906.030	2 825	588.670
L41	-35 902.330	2 825	427.190	R41	-34 963.580	2 825	549.290
L42	-35 928.800	2 825	421.220	R42	-35 014.320	2 825	529.940
L43	-35 994.460	2 825	425.790	R43	-35 444.330	2 825	516.710
L44	-36 249.030	2 825	379.710	R44	-35 534.770	2 825	519.710
L45	-36 367.910	2 825	354.870	R45	-35 700.730	2 825	505.620
L46	-36 385.140	2 825	351.290	R46	-35 799.060	2 825	498.860
L47	-36 443.890	2 825	342.550	R47	-35 921.390	2 825	496.270
L48	-36 550.020	2 825	326.750	R48	-36 000.850	2 825	477.380
L49	-36 763.580	2 825	277.380	R49	-36 299.540	2 825	435.740
L50	-37 054.670	2 825	210.100	R50	-36 336.340	2 825	427.360
L51	-37 134.030	2 825	191.750	R51	-36 561.330	2 825	375.700

Vel	16	Van	21	P640/08
Sheet		of		

PADRESERWE KOÖRDINATE				/	ROAD RESERVE CO-ORDINATES			
LINKERKANT/LEFT HAND SIDE					REGTERKANT/RIGHT HAND SIDE			
	Y	X	WG	31°		Y	X	
L52	-37 208.700	2 825 174.490			R52	-37 762.380	2 825 097.860	
L53	-37 346.550	2 825 142.630			R53	-37 959.320	2 825 061.510	
L54	-37 887.550	2 825 017.570			R54	-38 054.640	2 825 030.240	
L55	-37 984.080	2 824 991.180			R55	-38 138.160	2 825 010.890	
L56	-38 072.690	2 824 974.730			R56	-38 249.520	2 824 985.180	
L57	-38 125.870	2 824 962.420			R57	-38 349.800	2 824 975.260	
L58	-38 909.030	2 824 781.230			R58	-38 445.250	2 824 943.980	
L59	-39 054.530	2 824 744.180			R59	-38 920.260	2 824 829.950	
L60	-39 214.570	2 824 695.610			R60	-39 010.600	2 824 810.840	
L61	-39 321.470	2 824 660.310			R61	-39 165.270	2 824 765.910	
L62	-39 741.960	2 824 521.540			R62	-39 230.860	2 824 744.950	
L63	-39 872.960	2 824 479.550			R63	-39 332.060	2 824 708.950	
L64	-40 029.630	2 824 440.140			R64	-39 412.430	2 824 682.940	
L65	-40 173.460	2 824 413.690			R65	-39 527.350	2 824 648.190	
L66	-40 427.680	2 824 369.730			R66	-39 602.360	2 824 620.260	
L67	-41 207.790	2 824 234.660			R67	-39 757.480	2 824 569.070	
L68	-41 411.080	2 824 194.640			R68	-39 886.890	2 824 529.630	
L69	-41 427.890	2 824 191.330			R69	-40 045.610	2 824 489.860	
L70	-41 543.600	2 824 164.240			R70	-40 181.900	2 824 462.990	
L71	-41 712.490	2 824 121.170			R71	-40 445.900	2 824 417.350	
L72	-42 387.630	2 823 914.830			R72	-41 004.180	2 824 320.720	
L73	-43 030.480	2 823 718.120			R73	-41 212.270	2 824 284.710	
L74	-43 290.350	2 823 638.710			R74	-41 438.710	2 824 242.250	
L75	-43 725.720	2 823 504.940			R75	-41 556.070	2 824 214.750	
L76	-43 879.400	2 823 459.200			R76	-41 826.190	2 824 141.310	
L77	-44 056.070	2 823 419.090			R77	-41 904.230	2 824 117.560	
L78	-44 212.010	2 823 388.790			R78	-41 924.480	2 824 114.400	
L79	-45 131.240	2 823 225.740			R79	-42 037.500	2 824 073.550	
L80	-45 380.820	2 823 181.360			R80	-42 371.550	2 823 971.390	
L81	-45 577.440	2 823 134.330			R81	-42 993.780	2 823 781.080	
L82	-45 622.820	2 823 122.990			R82	-43 047.520	2 823 768.530	
L83	-45 913.800	2 823 050.100			R83	-43 094.950	2 823 757.320	
L84	-47 070.515	2 822 757.326			R84	-43 322.090	2 823 693.090	
L85	-47 546.580	2 822 637.440			R85	-43 570.510	2 823 616.090	
L86	-49 993.540	2 822 022.740			R86	-43 740.060	2 823 552.720	
L87	-50 006.080	2 822 017.900			R87	-43 853.930	2 823 519.770	
L88	-50 212.220	2 821 942.950			R88	-44 066.350	2 823 467.980	
L89	-51 166.850	2 821 466.480			R89	-44 220.650	2 823 437.960	
L90	-51 845.150	2 821 127.350			R90	-44 695.250	2 823 355.340	
L91	-52 660.530	2 820 714.310			R91	-44 794.480	2 823 342.090	
L92	-53 254.920	2 820 412.430			R92	-44 872.610	2 823 324.400	
L93	-54 559.630	2 819 758.230			R93	-45 030.240	2 823 296.980	
L94	-55 161.600	2 819 454.890			R94	-45 156.360	2 823 278.200	
L95	-55 610.250	2 819 228.820			R95	-45 192.210	2 823 272.820	
L96	-55 714.480	2 819 179.820			R96	-45 391.640	2 823 232.150	
L97	-55 824.990	2 819 142.770			R96X	-45 589.970	2 823 184.200	
L98	-55 937.510	2 819 118.430			R97	-45 864.330	2 823 114.640	
L99	-57 698.140	2 818 789.820			R98	-46 005.380	2 823 079.640	
L100	-58 155.990	2 818 704.390			R99	-46 065.840	2 823 064.550	
L101	-58 252.600	2 818 678.210			R100	-46 164.100	2 823 044.020	
L102	-58 374.570	2 818 659.110			R101	-46 261.070	2 823 019.650	

Vel	17	Van	21	P640/08
Sheet		of		

PADRESERWE KOÖRDINATE				/ ROAD RESERVE CO-ORDINATES			
LINKERKANT/LEFT HAND SIDE				REGTERKANT/RIGHT HAND SIDE			
	Y	X	WG 31°			X	
L103	-58 440.860	2 818 633.380		R102	-46 357.070	2 822 991.380	
L104	-58 503.500	2 818 599.640		R103	-46 977.770	2 822 835.280	
L105	-58 561.250	2 818 558.640		R104	-47 064.900	2 822 814.420	
L106	-58 614.160	2 818 510.170		R104X	-47 231.210	2 822 783.040	
L107	-58 660.110	2 818 456.220		R105	-50 042.940	2 822 068.760	
L108	-58 708.220	2 818 389.440		R106	-50 237.460	2 821 995.630	
L109	-58 786.390	2 818 287.490		R107	-51 798.580	2 821 215.620	
L110	-59 002.970	2 818 000.010		R108	-52 498.690	2 820 860.750	
L111	-59 052.250	2 817 938.110		R109	-52 614.440	2 820 794.470	
L112	-59 111.410	2 817 884.500		R110	-52 772.910	2 820 714.600	
L113	-59 176.910	2 817 838.840		R111	-54 401.900	2 819 893.660	
L114	-59 186.830	2 817 833.650		R112	-54 570.640	2 819 808.630	
L115	-59 202.170	2 817 825.630		R113	-54 832.800	2 819 676.510	
L116	-59 217.630	2 817 817.550		R114	-55 192.770	2 819 495.100	
L117	-59 247.890	2 817 801.860		R115	-55 316.260	2 819 432.860	
L118	-59 323.360	2 817 776.080		R116	-55 632.730	2 819 273.480	
L119	-59 357.290	2 817 765.910		R117	-55 737.180	2 819 227.000	
L120	-59 479.330	2 817 729.460		R118	-55 839.500	2 819 192.760	
L121	-60 961.260	2 817 286.870		R119	-55 946.430	2 819 167.590	
L122	-60 984.160	2 817 279.020		R120	-56 692.630	2 819 028.363	
L123	-61 056.150	2 817 254.390		R121	-57 694.600	2 818 841.340	
L124	-61 151.960	2 817 225.800		R122	-58 165.170	2 818 753.540	
L125	-61 204.990	2 817 214.100		R123	-58 264.520	2 818 742.110	
L126	-61 298.810	2 817 190.260		R124	-58 390.340	2 818 708.690	
L127	-61 394.680	2 817 180.260		R125	-58 462.650	2 818 680.600	
L128	-61 491.080	2 817 182.200		R126	-58 532.560	2 818 646.360	
L129	-61 588.120	2 817 198.520		R127	-58 594.190	2 818 598.870	
L130	-61 959.300	2 817 276.160		R128	-58 651.170	2 818 546.500	
L131	-62 030.160	2 817 285.950		R129	-58 699.860	2 818 486.230	
L132	-62 101.660	2 817 285.790		R130	-58 716.770	2 818 463.910	
L133	-62 172.460	2 817 275.750		R131	-58 829.840	2 818 314.710	
L134	-62 241.180	2 817 256.000		R132	-59 089.550	2 817 974.340	
L135	-62 306.490	2 817 226.910		R133	-59 143.810	2 817 925.180	
L136	-62 366.890	2 817 189.230		R134	-59 204.110	2 817 883.280	
L137	-62 389.780	2 817 171.530		R135	-59 268.530	2 817 849.620	
L138	-62 415.480	2 817 151.840		R136	-59 337.680	2 817 823.990	
L139	-62 518.950	2 817 066.280		R137	-59 396.940	2 817 807.150	
L140	-62 529.280	2 817 069.930		R138	-61 319.550	2 817 261.910	
L141	-62 544.210	2 817 058.180		R139	-61 307.180	2 817 241.570	
L142	-62 640.210	2 816 991.120		R140	-61 396.810	2 817 236.230	
L143	-62 707.650	2 816 946.820		R141	-61 486.250	2 817 238.030	
L144	-62 781.670	2 816 914.320		R142	-61 575.830	2 817 246.940	
L145	-62 859.540	2 816 892.770		R143	-61 948.720	2 817 325.040	
L146	-62 917.300	2 816 885.300		R144	-62 026.670	2 817 337.830	
L147	-62 939.460	2 816 882.450		R145	-62 105.390	2 817 337.650	
L148	-63 020.290	2 816 885.600		R146	-62 183.310	2 817 326.590	
L149	-63 072.510	2 816 890.130		R147	-62 258.980	2 817 304.860	
L150	-63 954.970	2 816 966.050		R148	-62 330.900	2 817 272.810	
L151	-64 057.660	2 816 969.440		R149	-62 396.520	2 817 229.540	
L152	-64 159.470	2 816 962.170		R150	-62 421.440	2 817 211.310	
L153	-64 261.210	2 816 948.290		R151	-62 510.920	2 817 146.560	

Vel	18	Van	21	P640/08
Sheet		of		

PADRESERWE KOÖRDINATE					ROAD RESERVE CO-ORDINATES				
LINKERKANT/LEFT HAND SIDE					REGTERKANT/RIGHT HAND SIDE				
	Y	X	WG	31°		X			
L154	-64 840.110	2 816	813.290		R152	-62 579.200	2 817	104.480	
L155	-65 824.900	2 816	583.640		R153	-62 725.910	2 817	007.480	
L156	-65 950.210	2 816	549.600		R154	-62 869.830	2 816	943.720	
L157	-66 085.790	2 816	513.800		R155	-62 914.840	2 816	937.920	
L158	-66 223.450	2 816	468.950		R156	-62 942.410	2 816	934.370	
L159	-66 356.440	2 816	416.880		R157	-63 016.030	2 816	935.420	
L160	-66 486.250	2 816	357.150		R158	-63 064.940	2 816	939.670	
L161	-66 612.230	2 816	290.350		R159	-63 064.152	2 816	944.828	
L162	-66 969.850	2 816	086.670		R160	-63 133.914	2 816	945.603	
L163	-67 633.750	2 815	708.520		R161	-63 551.530	2 816	981.540	
L164	-67 640.810	2 815	715.750		R162	-63 950.700	2 817	015.880	
L165	-67 860.770	2 815	590.250		R163	-64 058.330	2 817	021.460	
L166	-67 913.490	2 815	560.320		R164	-64 165.880	2 817	013.720	
L167	-67 998.640	2 815	515.880		R165	-64 271.590	2 816	992.840	
L168	-68 085.550	2 815	481.590		R166	-64 849.170	2 816	857.990	
L169	-68 172.530	2 815	457.230		R167	-65 727.550	2 816	652.920	
L170	-68 261.580	2 815	439.530		R168	-65 961.550	2 816	598.290	
L171	-68 291.200	2 815	431.840		R169	-66 106.700	2 816	562.070	
L172	-68 356.670	2 815	423.880		R170	-66 240.990	2 816	517.890	
L173	-68 419.830	2 815	416.200		R171	-66 376.680	2 816	464.750	
L174	-68 546.180	2 815	404.320		R172	-66 509.350	2 816	403.760	
L175	-68 775.940	2 815	382.710		R173	-66 636.990	2 816	333.620	
L176	-69 317.580	2 815	332.450		R174	-66 998.100	2 816	127.990	
L177	-70 921.720	2 815	183.600		R175	-67 366.400	2 815	918.270	
L178	-70 988.410	2 815	177.400		R176	-67 645.760	2 815	759.190	
L179	-71 143.810	2 815	162.160		R177	-67 832.690	2 815	652.740	
L180	-71 634.920	2 815	119.900		R178	-67 892.690	2 815	621.870	
L181	-71 808.280	2 815	105.760		R179	-67 944.090	2 815	595.440	
L182	-71 943.220	2 815	101.200		R180	-68 059.440	2 815	547.950	
L183	-72 124.780	2 815	095.940		R181	-68 178.660	2 815	510.350	
L184	-72 695.200	2 815	089.090		R182	-68 300.630	2 815	482.960	
L185	-73 892.050	2 815	068.230		R183	-68 424.500	2 815	465.980	
L186	-76 108.550	2 815	034.810		R184	-68 522.600	2 815	456.810	
L187	-76 877.910	2 815	027.900		R185	-68 760.620	2 815	432.500	
L188	-77 178.710	2 815	004.380		R186	-70 968.870	2 815	218.160	
L189	-77 290.620	2 814	994.340		R187	-70 990.910	2 815	216.010	
L190	-78 255.290	2 814	907.820		R188	-71 148.140	2 815	201.570	
L191	-78 295.780	2 814	888.370		R189	-71 744.210	2 815	140.140	
L192	-78 336.480	2 814	884.860		R190	-71 944.690	2 815	131.660	
L193	-78 373.800	2 814	892.500		R191	-72 151.690	2 815	132.610	
L194	-78 385.290	2 814	894.860		R192	-72 904.760	2 815	120.720	
L195	-78 758.490	2 814	860.960		R193	-73 890.160	2 815	108.980	
L196	-79 192.630	2 814	821.510		R194	-76 065.370	2 815	075.500	
L197	-80 397.640	2 814	711.460		R195	-76 978.320	2 815	051.530	
L198	-81 509.580	2 814	610.910		R196	-77 268.720	2 815	026.540	
L199	-82 179.500	2 814	550.270		R197	-78 361.290	2 814	927.360	
L200	-82 357.420	2 814	535.730		R198	-78 703.830	2 814	896.600	
L201	-82 390.700	2 814	534.220		R199	-78 769.400	2 814	890.820	
L202	-82 503.400	2 814	530.770		R200	-78 995.030	2 814	870.700	
L203	-82 641.860	2 814	530.310		R201	-79 056.540	2 814	870.180	
L204	-82 685.870	2 814	508.400		R202	-79 372.780	2 814	842.280	

Vel	19	Van	21	P640/08
Sheet		of		

PADRESERWE KOÖRDINATE				/ ROAD RESERVE CO-ORDINATES			
LINKERKANT/LEFT HAND SIDE				REGTERKANT/RIGHT HAND SIDE			
	Y	X	WG 31°			X	
L205	-82 745.870	2 814	513.170	R203	-80 388.490	2 814	750.550
L206	-82 788.630	2 814	539.870	R204	-81 518.440	2 814	646.360
L207	-83 041.560	2 814	568.450	R205	-81 878.550	2 814	613.160
L208	-83 680.520	2 814	638.980	R206	-82 184.080	2 814	589.740
L209	-84 265.470	2 814	700.660	R207	-82 381.780	2 814	574.280
L210	-85 714.720	2 814	859.130	R208	-82 502.320	2 814	570.720
L211	-86 577.150	2 814	959.810	R209	-82 838.030	2 814	586.170
L212	-86 908.150	2 814	992.620	R210	-85 723.554	2 814	900.739
L213	-87 684.200	2 815	060.190	R211	-86 764.110	2 815	014.760
L214	-89 834.410	2 815	241.470	R212	-86 913.880	2 815	028.300
L215	-90 973.710	2 815	336.570	R213	-87 158.440	2 815	049.420
L216	-92 199.330	2 815	497.720	R214	-87 684.050	2 815	089.030
L217	-92 200.510	2 815	491.130	R215	-89 212.530	2 815	220.310
L217X	-94 751.490	2 815	823.780	R216	-89 831.020	2 815	275.500
L218	-94 782.800	2 815	830.210	R217	-90 441.180	2 815	330.100
L219	-94 925.000	2 815	849.000	R218	-90 937.620	2 815	373.310
L220	-94 979.670	2 815	856.470	R219	-91 167.270	2 815	401.670
L221	-95 115.682	2 815	878.268	R220	-91 967.110	2 815	501.930
L222	-95 319.450	2 815	916.836	R221	-92 191.810	2 815	531.550
L223	-95 385.598	2 815	944.529	R222	-93 241.910	2 815	669.930
L224	-95 455.119	2 816	012.259	R223	-94 913.966	2 815	889.291
L225	-95 457.793	2 816	014.558	R224	-94 995.767	2 815	901.451
L226	-95 479.120	2 816	032.890	R225	-95 042.507	2 815	908.180
L227	-95 483.870	2 816	039.470	R226	-95 276.968	2 815	940.240
L228	-95 488.170	2 816	054.260	R227	-95 387.959	2 816	028.790
L229	-95 506.400	2 816	073.650	R228	-95 388.582	2 816	031.419
L230	-95 564.660	2 816	135.510	R229	-95 389.740	2 816	036.300
L231	-95 584.940	2 816	157.620	R230	-95 439.650	2 816	084.660
L232	-95 602.632	2 816	176.908	R231	-95 448.770	2 816	083.120
L233	-95 770.562	2 816	361.332	R232	-95 451.700	2 816	085.280
L234	-95 871.020	2 816	465.850	R233	-95 457.240	2 816	084.090
L235	-95 926.840	2 816	512.450	R234	-95 546.750	2 816	155.010
L236	-95 966.290	2 816	532.820	R235	-95 567.230	2 816	176.930
L237	-96 006.220	2 816	548.480	R236	-95 582.277	2 816	193.035
L238	-96 088.060	2 816	569.710	R237	-95 752.500	2 816	378.019
L239	-96 198.790	2 816	561.160	R238	-95 812.000	2 816	439.020
L240	-96 292.700	2 816	524.380	R239	-95 842.070	2 816	473.680
L241	-96 429.950	2 816	455.700	R240	-95 909.360	2 816	545.420
L242	-96 878.550	2 816	232.980	R241	-95 979.790	2 816	574.090
L243	-97 062.610	2 816	141.800	R242	-96 011.050	2 816	582.810
L244	-97 228.990	2 816	059.200	R243	-96 027.410	2 816	587.510
L245	-97 245.780	2 816	036.800	R244	-96 102.480	2 816	600.620
L246	-97 406.616	2 815	968.730	R245	-96 167.610	2 816	596.010
L247	-97 916.480	2 815	714.740	R246	-96 188.030	2 816	592.260
L248	-97 991.240	2 815	658.500	R247	-96 227.340	2 816	585.350
L249	-98 079.630	2 815	566.920	R248	-96 342.350	2 816	534.300
L250	-98 141.340	2 815	507.740	R249	-96 876.370	2 816	270.380
L251	-98 233.090	2 815	441.810	R250	-96 926.400	2 816	242.890
L252	-98 335.130	2 815	392.540	R251	-97 236.750	2 816	090.980
L253	-98 431.560	2 815	356.440	R252	-97 749.360	2 815	838.260
L254	-98 524.480	2 815	331.500	R253	-97 927.250	2 815	745.240

Vel	20	Van	21	P640/08
Sheet		of		

PADRESERWE KOÖRDINATE				/ ROAD RESERVE CO-ORDINATES			
LINKERKANT/LEFT HAND SIDE				REGTERKANT/RIGHT HAND SIDE			
	Y	X	WG 31°			X	
L255	-98 580.030	2 815 326.660		R254	-97 959.540	2 815 725.620	
L256	-98 667.880	2 815 332.150		R255	-98 004.200	2 815 691.150	
L257	-98 824.000	2 815 364.360		R256	-98 095.160	2 815 598.300	
L258	-99 069.000	2 815 414.090		R257	-98 150.450	2 815 540.530	
L259	-99 066.010	2 815 426.490		R258	-98 189.710	2 815 508.670	
L260	-99 115.660	2 815 436.750		R259	-98 371.690	2 815 412.340	
L261	-99 126.150	2 815 437.000		R260	-98 435.210	2 815 385.770	
				R261	-98 512.630	2 815 365.460	
				R262	-98 572.610	2 815 359.730	
				R263	-98 602.890	2 815 356.830	
				R264	-98 727.120	2 815 373.910	
				R265	-99 091.230	2 815 450.170	
				R266	-99 123.150	2 815 449.500	

Vel	21	Van	21	P640/08
Sheet		of		

Printed by and obtainable from the Government Printer, Bosman Street, Private Bag X85, Pretoria, 0001
Publications: Tel: (012) 334-4508, 334-4509, 334-4510
Advertisements: Tel: (012) 334-4673, 334-4674, 334-4504
Subscriptions: Tel: (012) 334-4735, 334-4736, 334-4737
Cape Town Branch: Tel: (021) 465-7531

Gedruk deur en verkrygbaar by die Staatsdrukker, Bosmanstraat, Privaatsak X85, Pretoria, 0001
Publikasies: Tel: (012) 334-4508, 334-4509, 334-4510
Advertensies: Tel: (012) 334-4673, 334-4674, 334-4504
Subskripsies: Tel: (012) 334-4735, 334-4736, 334-4737
Kaapstad-tak: Tel: (021) 465-7531