

IMPORTANT NOTICE

The Government Printing Works will not be held responsible for faxed documents not received due to errors on the fax machine or faxes received which are unclear or incomplete. Please be advised that an "OK" slip, received from a fax machine, will not be accepted as proof that documents were received by the GPW for printing. If documents are faxed to the GPW it will be the sender's responsibility to phone and confirm that the documents were received in good order.

Furthermore the Government Printing Works will also not be held responsible for cancellations and amendments which have not been done on original documents received from clients.

CONTENTS**INHOUD**

<i>No.</i>	<i>Page No.</i>	<i>Gazette No.</i>	<i>No.</i>	<i>Bladsy No.</i>	<i>Koerant No.</i>
GOVERNMENT NOTICE			GOEWERMENSKENNISGEWING		
Transport, Department of			Vervoer, Departement van		
<i>Government Notice</i>			<i>Goewermentskennisgewing</i>		
915			915		
South African National Roads Agency Limited and the National Roads Act (7/1998): The South African National Roads Agency Limited: Declaration amendment of National Road R33 Section 8: Amendment of Declaration No. 174 of 2007			Suid-Afrikaanse Nasionale Padagentskap Beperk en die Nasionale Paaie Wet (7/1998): Die Suid-Afrikaanse Nasionale Padagentskap Beperk: Verklaring wysiging van Nasionale Pad R33 Seksie 8: Wysiging van Verklaring No. 174 van 2007		
	3	33641		4	33641

GOVERNMENT NOTICE

DEPARTMENT OF TRANSPORT

No. 915

22 October 2010

THE SOUTH AFRICAN NATIONAL ROADS AGENCY LIMITED

Registration No: 98/09584/06

DECLARATION AMENDMENT OF NATIONAL ROAD R33 SECTION 8

AMENDMENT OF DECLARATION No. 174 OF 2007

By virtue of section 40(1)(b) of the South African National Roads Agency Limited and the National Roads Act, 1998 (Act No. 7 of 1998), I hereby amend Declaration No. 174 of 2007 by substituting Annexure paragraph (IV) the section of the descriptive declaration of the route from the N17 up to Carolina, with the subjoined sheets 1 to 8 of Plan No. P773/09.

(National Road R33 Section 8: N17 – Carolina)



MINISTER OF TRANSPORT

GOEWERMENTSKENNISGEWING

DEPARTEMENT VAN VERVOER

No. 915

22 Oktober 2010

DIE SUID-AFRIKAANSE NASIONALE PADAGENTSKAP BEPERK

Registrasie No: 98/09584/06

VERKLARING WYSIGING VAN NASIONALE PAD R33 SEKSIE 8.

WYSIGING VAN VERKLARING NO. 174 VAN 2007.

Kragtens Artikel 40(1)(b) van die Suid-Afrikaanse Nasionale Padagentskap Beperk en die Nasionale Paaie Wet, 1998 (Wet no. 7 van 1998), wysig ek hiermee Verklaring no. 174 van 2007 deur die Bylae paragraaf (IV) die gedeelte van die beskrywende verklaring van die roete vanaf die N17 tot by Carolina, te vervang met meegaande velle 1 tot 8 van Plan no. P773/09.

(Nasionale Pad R33 Seksie 8: N17 – Carolina)



MINISTER VAN VERVOER

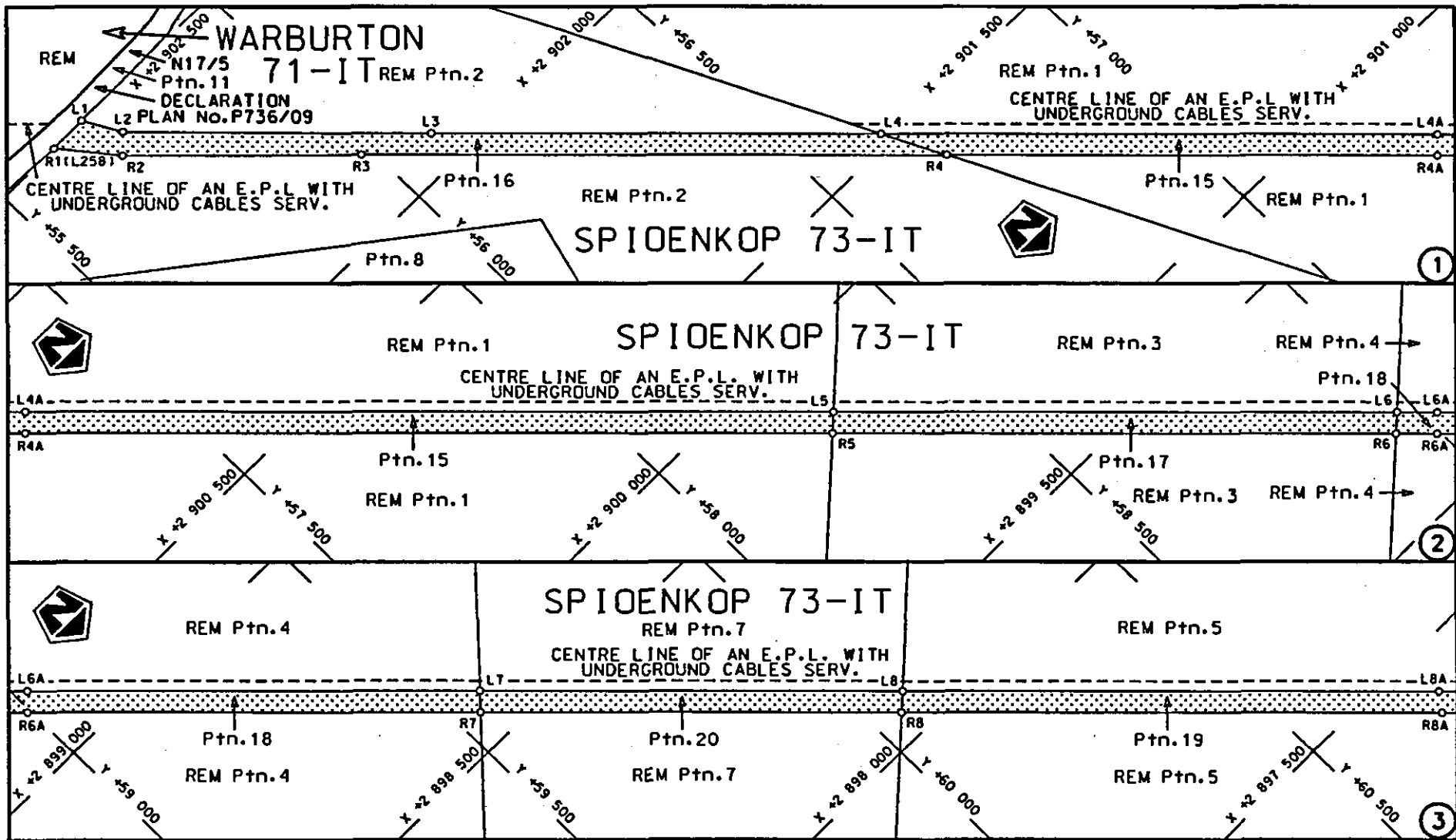

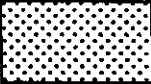
Die Suid Afrikaanse Nasionale Padogentskap Beperk The South African National Roads Agency Limited	Die figuur getoon The figure shown		steldie padreserwe voor van 'n gedeelte represents the road reserve of a portion van Nasionale Roete R33 Sektie of National Route R33 Section	Vel Sheet 1	van of 8
				Plan P773/09	

STAATSKOEFANT, 22 OKTOBER 2010

No. 33641 5

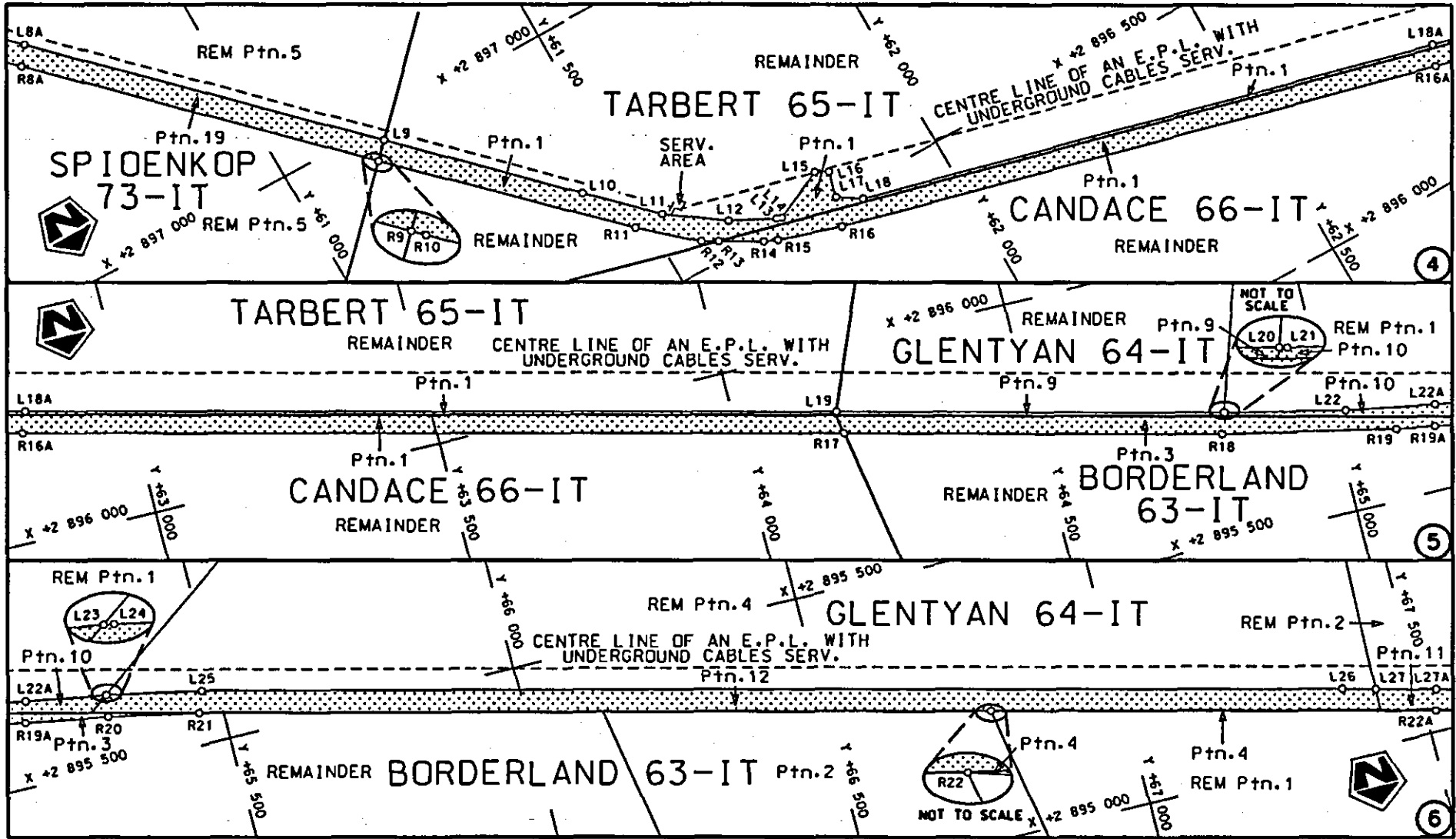

<p>Die Suid Afrikaanse Nasionale Padagentskap Beperk</p>	<p>Die figuur getoon</p>	<p>steldie padreserwe voor van 'n gedeelte van Nasionale Roete R33</p>	<p>Vel Sheet 2 van 8</p>
<p>The South African National Roads Agency Limited</p>	<p>The figure shown.</p>	<p>of National Route R33 Seksie Section 8</p>	<p>Plan P773/09</p>

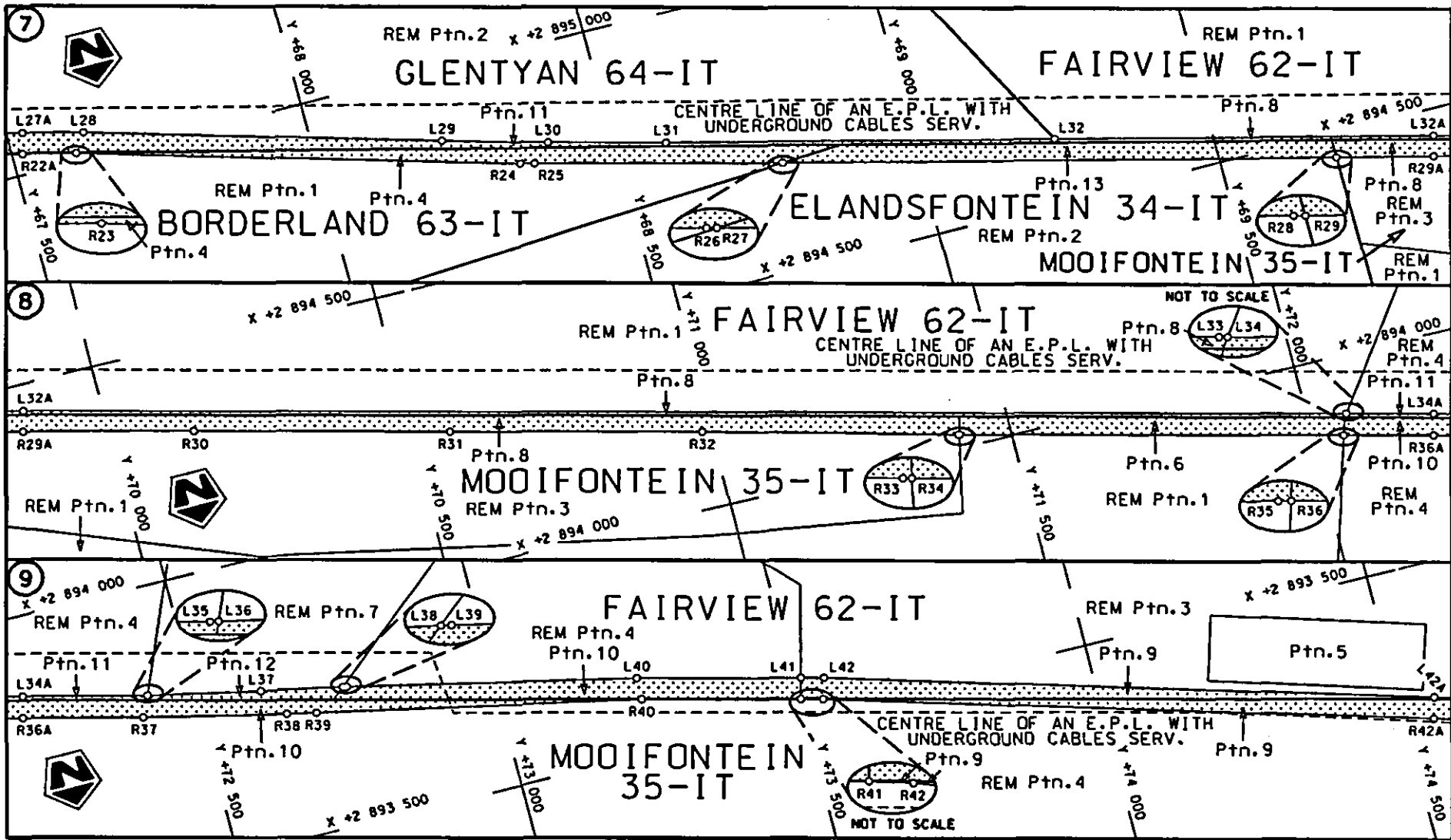

Die Suid Afrikaanse Nasionale Padagentskap Beperk The South African National Roads Agency Limited	Die figuur getoon The figure shown		steldie padreserwe voor van 'n gedeelte represents the road reserve of a portion van Nasionale Roete R33 Sektie of National Route R33 Section	Vel Sheet 3 of 8 Plan P773/09
--	---------------------------------------	--	--	----------------------------------

STAATSKOERANT, 22 OKTOBER 2010

No. 33641 7

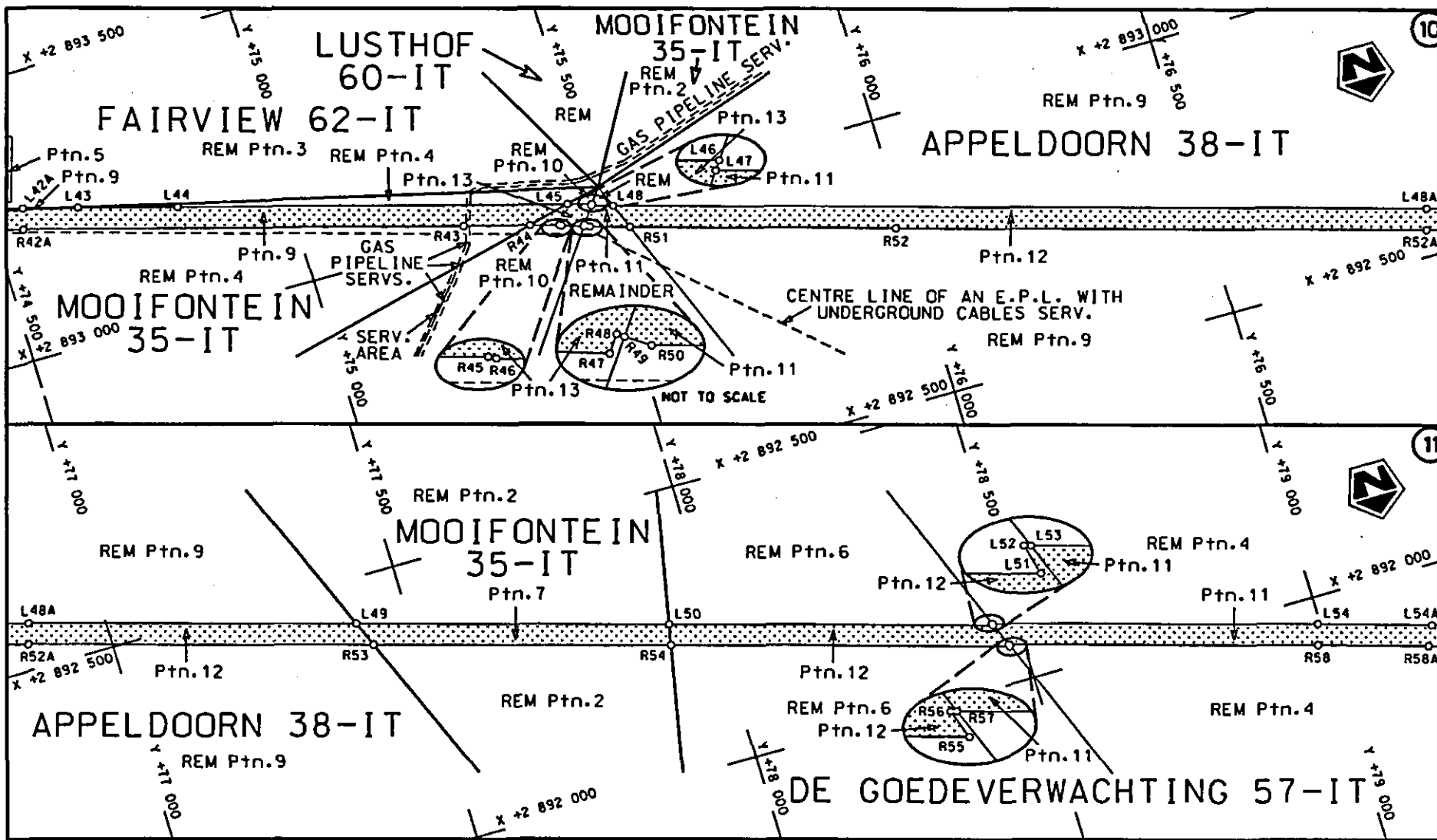

<p>Die Suid Afrikaanse Nasionale Padagentskap Beperk The South African National Roads Agency Limited</p>	<p>Die figuur getoon The figure shown</p>	<p>steldie padreserwe voor van 'n gedeelte represents the road reserve of a portion von Nasionale Roete R33 of National Route R33</p>	<p>Vel Sheet 4 van 8 of 8</p>
<p>Seksie 8</p>			<p>Plan P773/09</p>

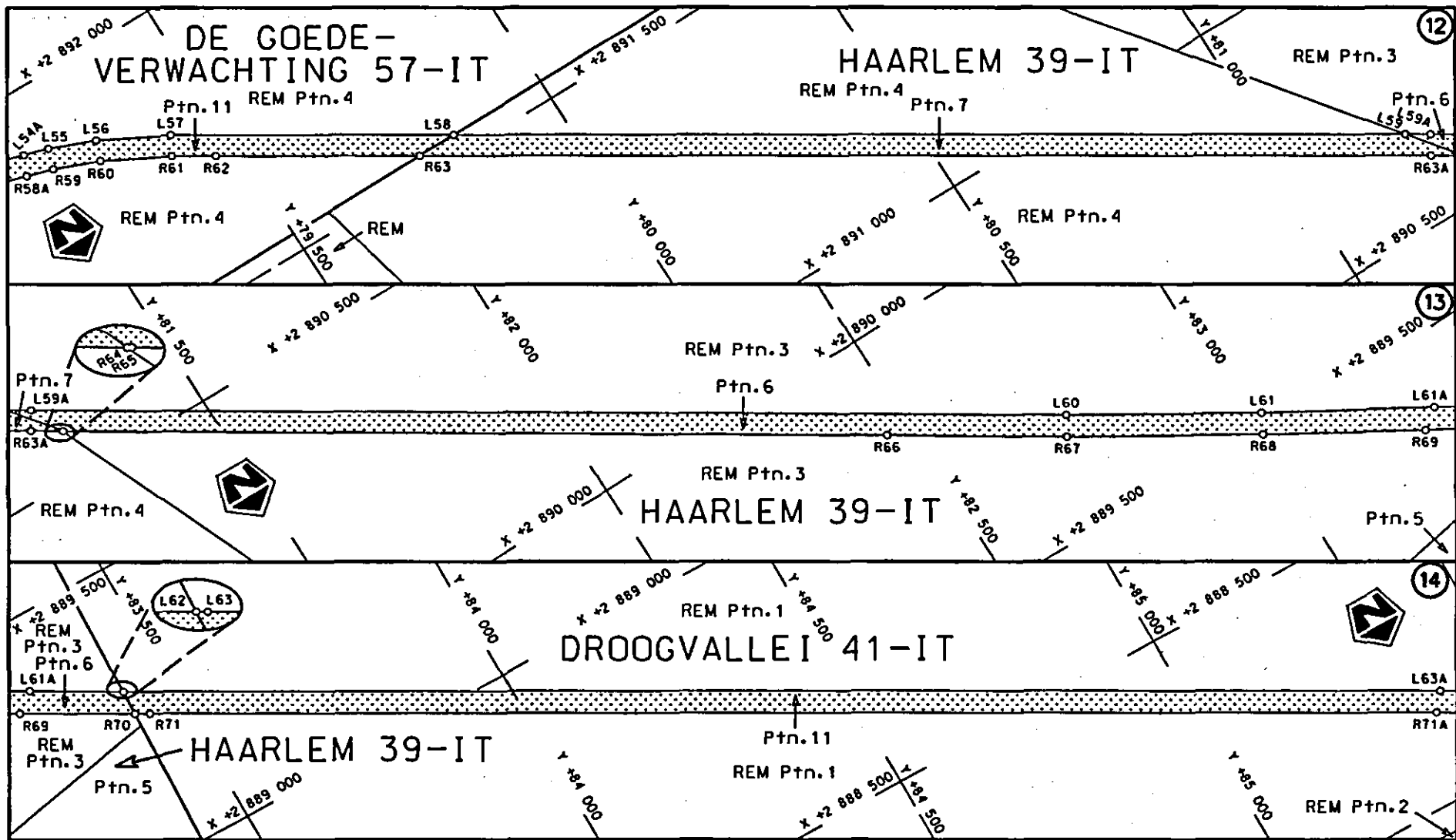

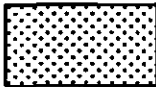
<p>Die Suid Afrikaanse Nasionale Padagentskap Beperk The South African National Roads Agency Limited</p>	<p>Die figuur getoon The figure shown</p> 	<p>steldie padreserwe voor van 'n gedeelte represents the road reserve of a portion van Nasionale Roete R33 Sektie of National Route Section</p>	<p>Vel Sheet 5 van 8 Plan P773/09</p>
--	--	--	---

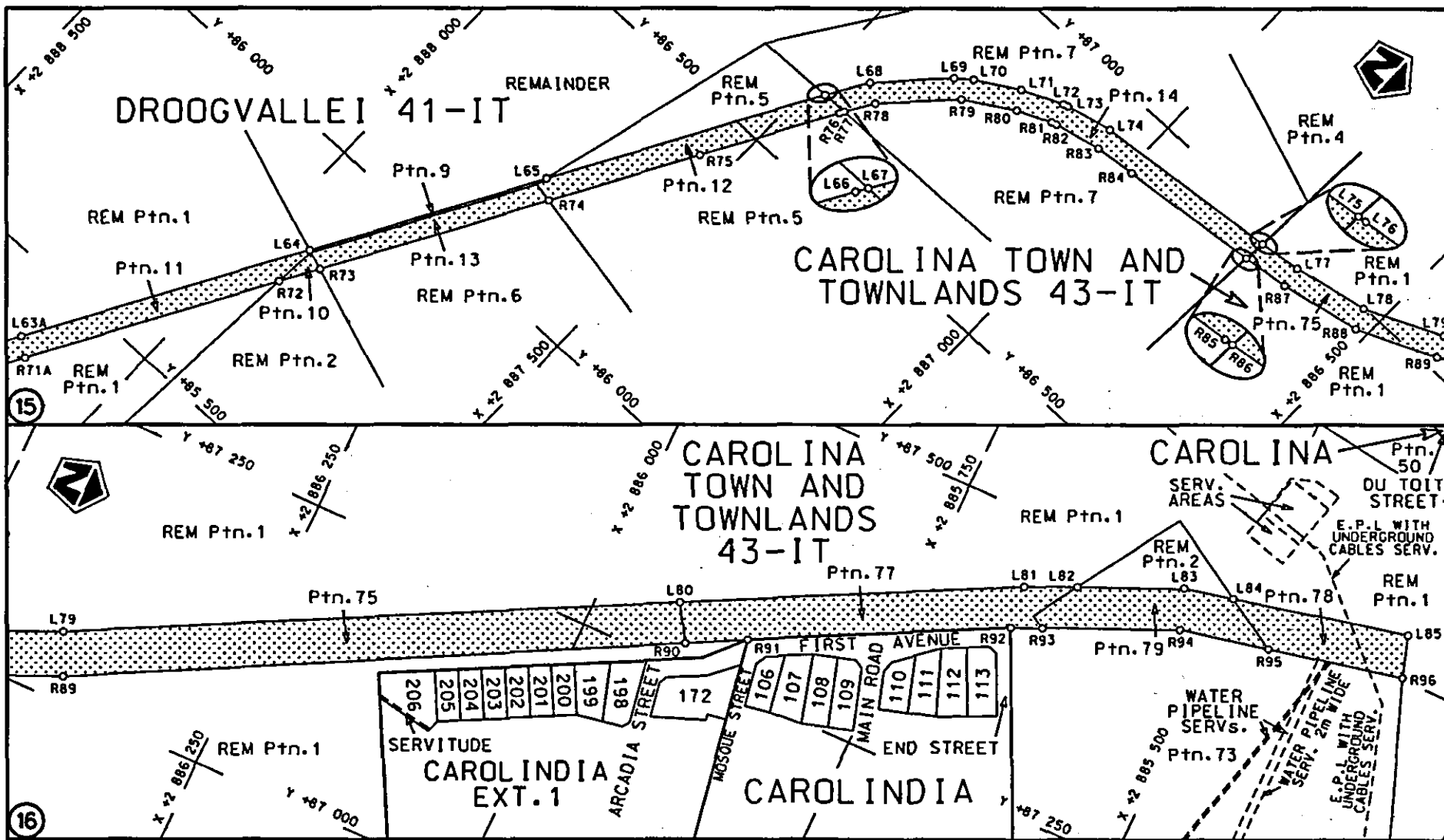

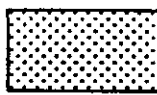
Die Suid Afrikaanse Nasionale Padogenskap Beperk The South African National Roads Agency Limited	Die figuur getoon The figure shown		staldie padreserwe voor van 'n gedeelte represents the road reserve of a portion van Nasionale Roete R33 Sekaie Section 8	Vel Sheet 6 van 8 of 8
			Plan P733/09	8

PADRESERWE KOÖRDINATE				ROAD RESERVE CO-ORDINATES			
LINKERKANT/LEFT HAND SIDE				REGTERKANT/RIGHT HAND SIDE			
	Y	X	WG 31°		Y	X	
L1	55 689.150	2 902 500.460		R1	55 621.800	2 902 499.730	
L2	55 725.390	2 902 436.770		R2	55 694.920	2 902 407.240	
L3	56 094.630	2 902 063.100		R3	55 983.750	2 902 120.770	
L4	56 638.740	2 901 518.170		R4	56 691.790	2 901 411.640	
L5	58 288.740	2 899 865.710		R5	58 260.810	2 899 840.230	
L6	58 972.510	2 899 180.920		R6	58 944.570	2 899 155.420	
L7	59 566.450	2 898 586.090		R7	59 540.480	2 898 558.610	
L8	60 077.980	2 898 073.800		R8	60 050.010	2 898 048.290	
L9	61 178.560	2 896 971.570		R9	61 152.110	2 896 944.510	
L10	61 427.640	2 896 722.130		R10	61 152.370	2 896 944.250	
L11	61 528.340	2 896 623.140		R11	61 476.110	2 896 624.590	
L12	61 620.820	2 896 555.990		R12	61 562.700	2 896 547.960	
L13	61 694.610	2 896 519.260		R13	61 588.540	2 896 533.220	
L14	61 703.580	2 896 516.070		R14	61 655.620	2 896 494.970	
L15	61 792.410	2 896 556.750		R15	61 678.250	2 896 485.120	
L16	61 813.870	2 896 545.130		R16	61 784.950	2 896 450.880	
L17	61 801.490	2 896 501.130		R17	64 177.810	2 895 847.480	
L18	61 841.080	2 896 475.810		R18	64 808.050	2 895 688.550	
L19	64 174.520	2 895 887.730		R19	65 101.960	2 895 624.580	
L20	64 821.050	2 895 724.790		R20	65 307.340	2 895 587.890	
L21	64 822.340	2 895 724.460		R21	65 460.080	2 895 556.630	
L22	65 024.980	2 895 677.040		R22	66 775.630	2 895 224.870	
L23	65 313.040	2 895 625.340		R23	67 607.460	2 895 013.830	
L24	65 313.820	2 895 625.200		R24	68 336.480	2 894 803.210	
L25	65 473.500	2 895 592.660		R25	68 360.090	2 894 796.790	
L26	67 371.030	2 895 113.380		R26	68 771.320	2 894 689.520	
L27	67 427.220	2 895 098.780		R27	68 772.480	2 894 689.230	
L28	67 628.740	2 895 046.380		R28	69 695.580	2 894 457.050	
L29	68 217.140	2 894 876.150		R29	69 695.850	2 894 456.980	
L30	68 392.150	2 894 826.750		R30	70 141.990	2 894 347.190	
L31	68 587.380	2 894 775.010		R31	70 565.740	2 894 239.710	
L32	69 235.010	2 894 611.690		R32	70 985.480	2 894 134.630	
L33	72 067.200	2 893 897.490		R33	71 411.650	2 894 023.580	
L34	72 067.430	2 893 897.430		R34	71 413.310	2 894 023.160	
L35	72 420.090	2 893 809.680		R35	72 053.830	2 893 861.890	
L36	72 420.370	2 893 809.620		R36	72 054.130	2 893 861.820	
L37	72 610.180	2 893 769.680		R37	72 404.120	2 893 774.850	
L38	72 747.860	2 893 741.830		R38	72 643.210	2 893 719.910	
L39	72 753.810	2 893 740.620		R39	72 692.570	2 893 709.400	
L40	73 239.030	2 893 633.000		R40	73 238.150	2 893 595.150	
L41	73 511.840	2 893 564.550		R41	73 502.750	2 893 528.430	
L42	73 550.450	2 893 554.860		R42	73 539.800	2 893 518.880	
L43	74 650.760	2 893 238.920		R43	75 274.910	2 893 020.830	
L44	74 814.970	2 893 191.770		R44	75 383.920	2 892 989.110	
L45	75 456.510	2 893 006.690		R45	75 432.540	2 892 974.970	
L46	75 496.760	2 892 995.080		R46	75 436.570	2 892 972.790	
L47	75 495.010	2 892 992.460		R47	75 472.350	2 892 960.770	
L48	75 530.550	2 892 981.870		R48	75 474.120	2 892 963.270	
L49	77 410.590	2 892 421.650		R49	75 474.200	2 892 963.210	
L50	77 924.630	2 892 268.470		R50	75 482.280	2 892 957.680	
L51	78 458.710	2 892 109.320		R51	75 547.720	2 892 938.050	

Vel	7	Van	8	P773/09
Sheet		of		

PADRESERWE KOÖRDINATE				ROAD RESERVE CO-ORDINATES			
LINKERKANT/LEFT HAND SIDE				REGTERKANT/RIGHT HAND SIDE			
	Y	X	WG 31°		Y	X	
L52	78 457.720	2 892 112.980		R52	75 985.920	2 892 806.550	
L53	78 458.500	2 892 112.750		R53	77 428.550	2 892 377.120	
L54	78 996.210	2 891 952.800		R54	77 917.170	2 892 231.670	
L55	79 226.430	2 891 882.580		R55	78 476.110	2 892 065.290	
L56	79 303.580	2 891 851.810		R56	78 474.890	2 892 068.820	
L57	79 415.970	2 891 791.680		R57	78 475.610	2 892 068.610	
L58	79 824.410	2 891 534.420		R58	78 985.660	2 891 916.500	
L59	81 205.610	2 890 664.480		R59	79 213.150	2 891 847.610	
L60	82 740.260	2 889 697.890		R60	79 289.370	2 891 817.130	
L61	83 027.230	2 889 523.730		R61	79 396.690	2 891 759.090	
L62	83 423.710	2 889 295.210		R62	79 460.610	2 891 719.300	
L63	83 424.180	2 889 294.940		R63	79 754.600	2 891 534.000	
L64	85 833.260	2 887 926.090		R64	81 268.010	2 890 580.110	
L65	86 203.240	2 887 715.860		R65	81 268.820	2 890 579.600	
L66	86 637.610	2 887 469.050		R66	82 460.730	2 889 829.770	
L67	86 638.020	2 887 468.800		R67	82 721.310	2 889 664.450	
L68	86 708.060	2 887 426.580		R68	83 009.490	2 889 490.470	
L69	86 812.760	2 887 326.750		R69	83 250.620	2 889 349.140	
L70	86 833.950	2 887 300.440		R70	83 421.970	2 889 252.570	
L71	86 876.820	2 887 230.070		R71	83 444.230	2 889 240.030	
L72	86 906.990	2 887 159.360		R72	85 756.930	2 887 925.870	
L73	86 909.840	2 887 150.410		R73	85 820.460	2 887 889.770	
L74	86 929.350	2 887 069.430		R74	86 177.910	2 887 686.650	
L75	86 962.480	2 886 741.790		R75	86 413.730	2 887 552.650	
L76	86 962.490	2 886 741.690		R76	86 631.230	2 887 428.690	
L77	86 971.160	2 886 668.100		R77	86 638.960	2 887 424.050	
L78	86 997.970	2 886 535.360		R78	86 686.370	2 887 395.540	
L79	87 058.160	2 886 402.390		R79	86 793.260	2 887 292.490	
L80	87 302.160	2 885 933.110		R80	86 844.580	2 887 210.230	
L81	87 438.820	2 885 670.280		R81	86 869.700	2 887 151.300	
L82	87 457.420	2 885 628.410		R82	86 872.630	2 887 142.270	
L83	87 494.700	2 885 544.470		R83	86 892.240	2 887 061.510	
L84	87 504.220	2 885 502.190		R84	86 899.750	2 886 990.170	
L85	87 537.900	2 885 352.620		R85	86 924.460	2 886 744.510	
				R86	86 924.520	2 886 744.080	
				R87	86 934.100	2 886 662.990	
				R88	86 962.440	2 886 520.190	
				R89	87 021.910	2 886 385.900	
				R90	87 271.170	2 885 914.250	
				R91	87 296.490	2 885 866.920	
				R92	87 400.920	2 885 666.100	
				R93	87 412.020	2 885 641.120	
				R94	87 460.000	2 885 533.140	
				R95	87 476.510	2 885 456.870	
				R96	87 501.560	2 885 341.100	

Vel	8	Van	8	P773/09
Sheet		of		

Printed by and obtainable from the Government Printer, Bosman Street, Private Bag X85, Pretoria, 0001
Publications: Tel: (012) 334-4508, 334-4509, 334-4510
Advertisements: Tel: (012) 334-4673, 334-4674, 334-4504
Subscriptions: Tel: (012) 334-4735, 334-4736, 334-4737
Cape Town Branch: Tel: (021) 465-7531

Gedruk deur en verkrygbaar by die Staatsdrukker, Bosmanstraat, Privaatsak X85, Pretoria, 0001
Publikasies: Tel: (012) 334-4508, 334-4509, 334-4510
Advertensies: Tel: (012) 334-4673, 334-4674, 334-4504
Subskripsies: Tel: (012) 334-4735, 334-4736, 334-4737
Kaapstad-tak: Tel: (021) 465-7531